

P01-48x210E/30x180 1

P01-48x210E/90x240 3

P01-48x210E/180x330 5

P01-48x210E/300x450 7

P01-48x210E/390x540 9

P01-48x210E/480x630 11

P01-48x210E/600x750 13

P01-48x210E/690x840 15

P01-48x210E/900x1050 17

P01-48x210E/1080x1230 19

P01-48x210E/1290x1440 21

Max. Stroke: 180mm
Peak Force: 544N

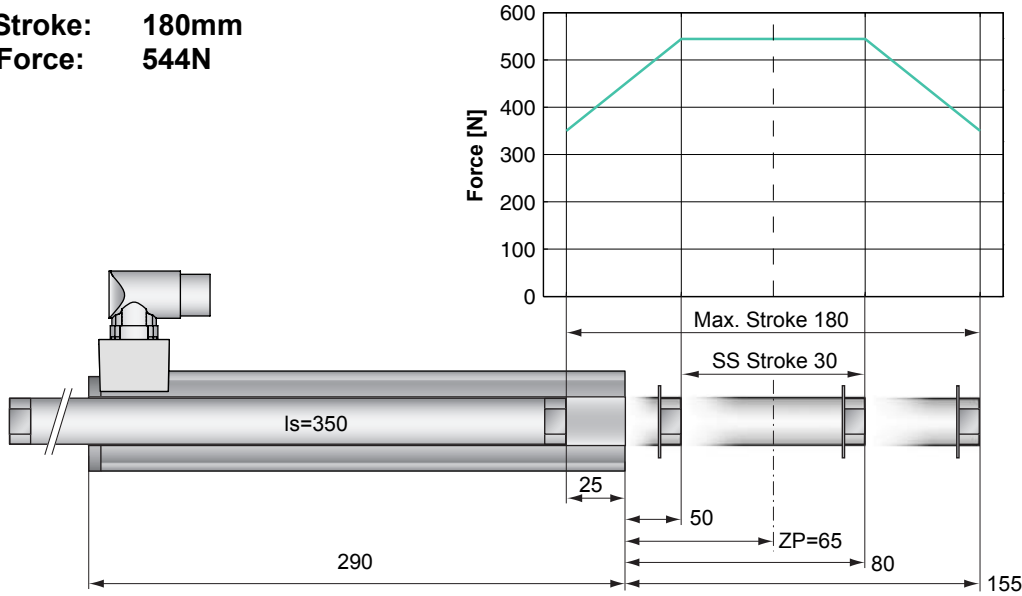

Dimensions in mm

Motor Specification

		E-Winding	
		P01-48x210E/30x180-C	
Stroke Max.	mm (in)	180 (7.09)	
Stroke SS	mm (in)	30 (1.18)	
Peak Force E1100-XC	N (lbf)	544 (122.3)	
Cont. Force	N (lbf)	133 (30.0)	
Cont. Force compressed air cooling	N (lbf)	213 (47.9)	
Cont. Force Fan cooling	N (lbf)	235 (52.8)	
Border Force	%	64	
Force Constant	N/A (lbf/A)	27.2 (6.12)	
Max. Current @ 72VDC	A	20.0	
Max. Velocity @ 72VDC	m/s (in/s)	2.4 (96)	
Phase Resist. 25/80 °C	Ohm	1.8/2.1	
Phase Inductance	mH	1.7	
Thermal Resistance	°K/W	1.08	
Thermal Time Const.	sec	3000	
Stator Diameter	mm (in)	48 (1.89)	
Stator Length	mm (in)	290 (11.40)	
Stator Mass	g (lb)	1930 (4.25)	
Slider Diameter	mm (in)	28 (1.10)	
Slider Length	mm (in)	350 (13.78)	
Slider Mass	g (lb)	1460 (3.22)	
Position Repeatability	mm (in)	±0.05 (±0.0020)	
Linearity	%	±0.3	
Position Rep. with ES	mm (in)	±0.01 (±0.0004)	
Linearity with ES	mm (in)	±0.01 (±0.0004)	

Position-Time Diagram

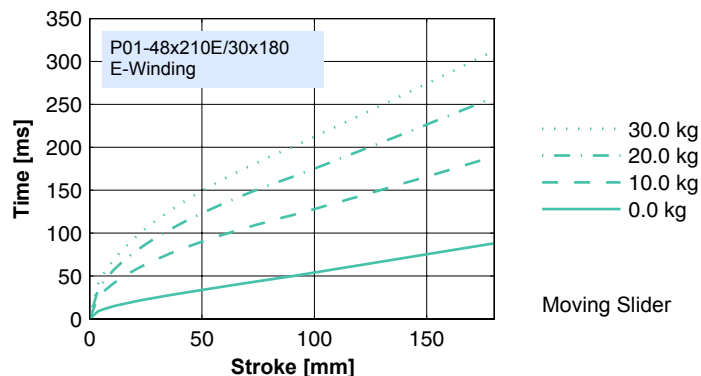

Moving Slider

Connector Type

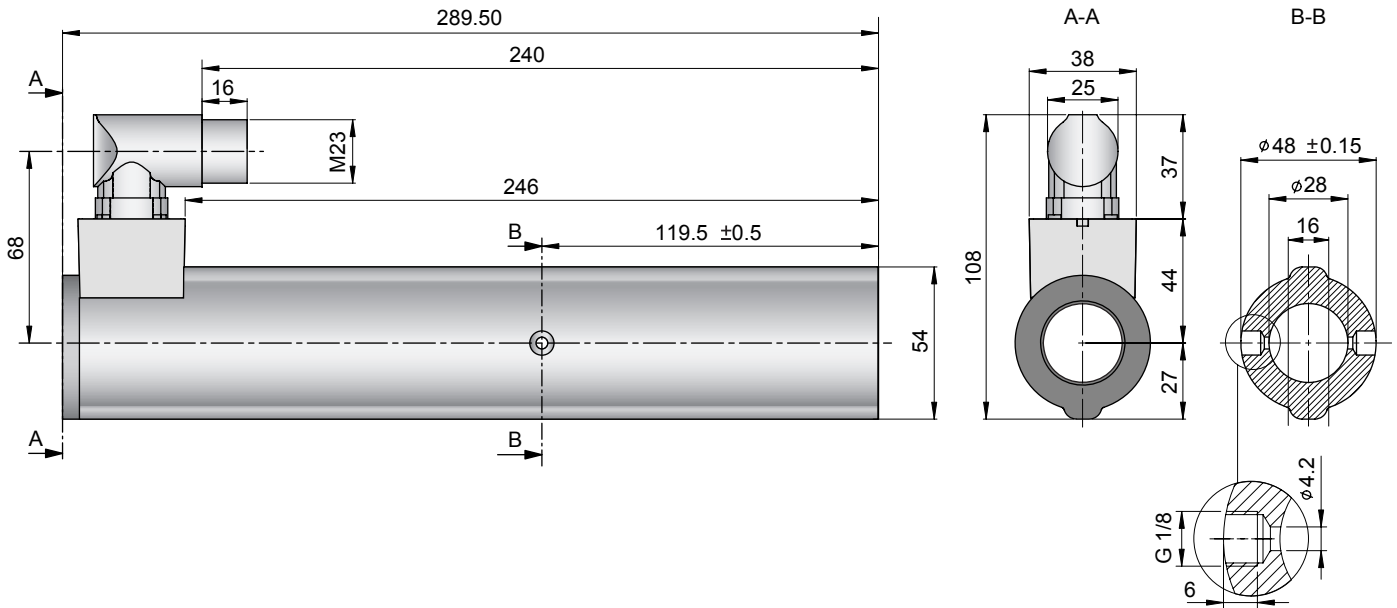

Linear Motor		Stator		Slider	
Type	Art.No	Type	Art. No.	Type	Art No.
P01-48x210E/30x180-C	-->	PS01-48x210E-C	0150-2797	& PL01-28x350/270	0150-1380

Slider

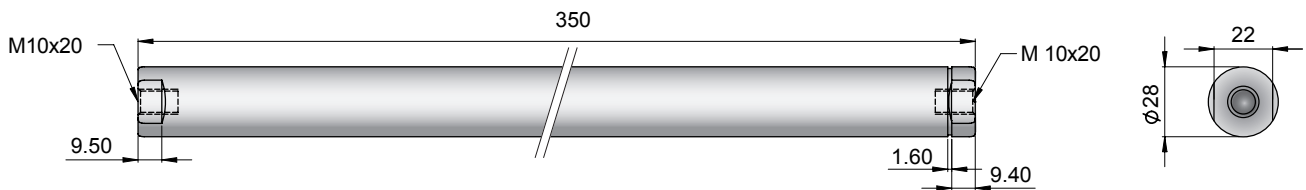

Standard Type	Slider Standard	PL01-28x350/270	0150-1380
Special Sliders	Heavy Duty Slider with WC/C-Coating	PL02-28x350/270	0150-1411
	Hollow Slider hole diameter 6mm		not available
	High Clearance Slider d=27mm, m=1360g	PL01-27x350/270	0150-1467

Connectors

Motor connector Wiring

P01-48...-C

Ph 1+	Red	A
Ph 1-	Pink	B
Ph 2+	Blue	C
Ph 2-	Grey	D
+5VDC	White	E
GND	Inner Shield	F
Sine	Yellow	G
Cosine	Green	H
Temp.	Black	L
Shield	Outer Shield	Case

Accessoires

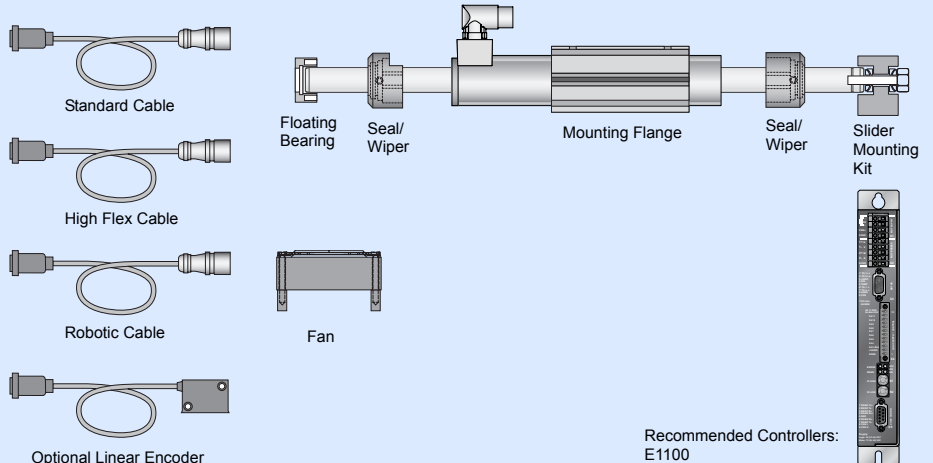

Max. Stroke: 240mm
Peak Force: 544N

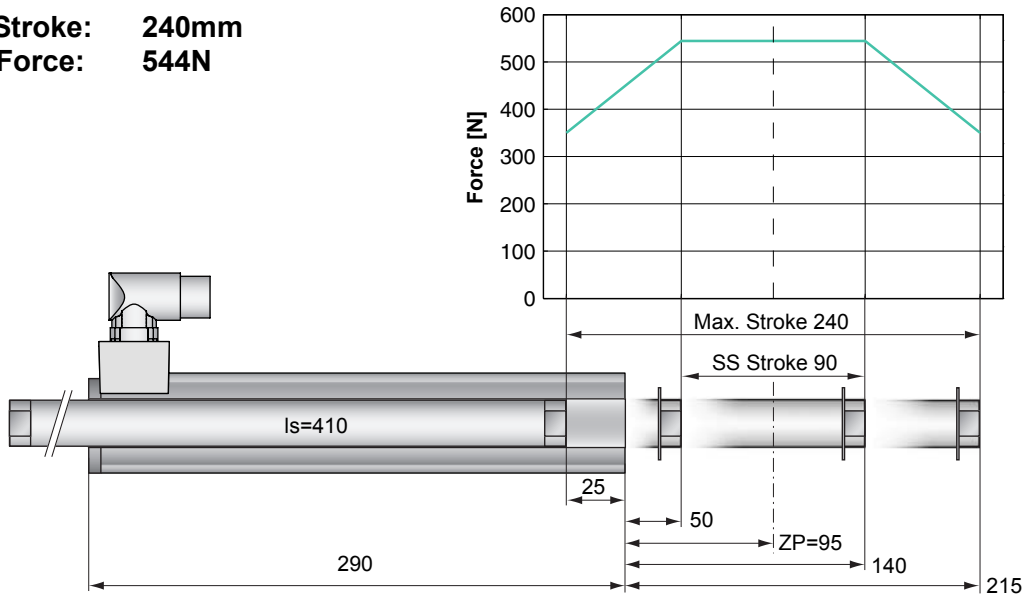

Dimensions in mm

Motor Specification

		E-Winding
		P01-48x210E/90x240-C
Stroke Max.	mm (in)	240 (9.45)
Stroke SS	mm (in)	90 (3.54)
Peak Force E1100-XC	N (lbf)	544 (122.3)
Cont. Force	N (lbf)	133 (30.0)
Cont. Force compressed air cooling	N (lbf)	213 (47.9)
Cont. Force Fan cooling	N (lbf)	235 (52.8)
Border Force	%	64
Force Constant	N/A (lbf/A)	27.2 (6.12)
Max. Current @ 72VDC	A	20.0
Max. Velocity @ 72VDC	m/s (in/s)	2.4 (96)
Phase Resist. 25/80 °C	Ohm	1.8/2.1
Phase Inductance	mH	1.7
Thermal Resistance	°K/W	1.08
Thermal Time Const.	sec	3000
Stator Diameter	mm (in)	48 (1.89)
Stator Length	mm (in)	290 (11.40)
Stator Mass	g (lb)	1930 (4.25)
Slider Diameter	mm (in)	28 (1.10)
Slider Length	mm (in)	410 (16.14)
Slider Mass	g (lb)	1740 (3.84)
Position Repeatability	mm (in)	±0.05 (±0.0020)
Linearity	%	±0.2
Position Rep. with ES	mm (in)	±0.01 (±0.0004)
Linearity with ES	mm (in)	±0.01 (±0.0004)

Position-Time Diagram

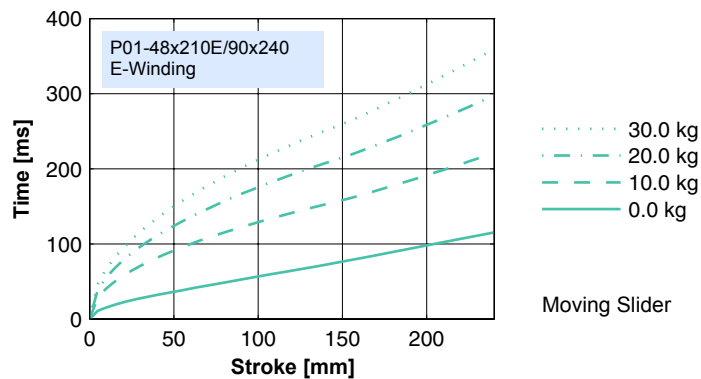

Connector Type

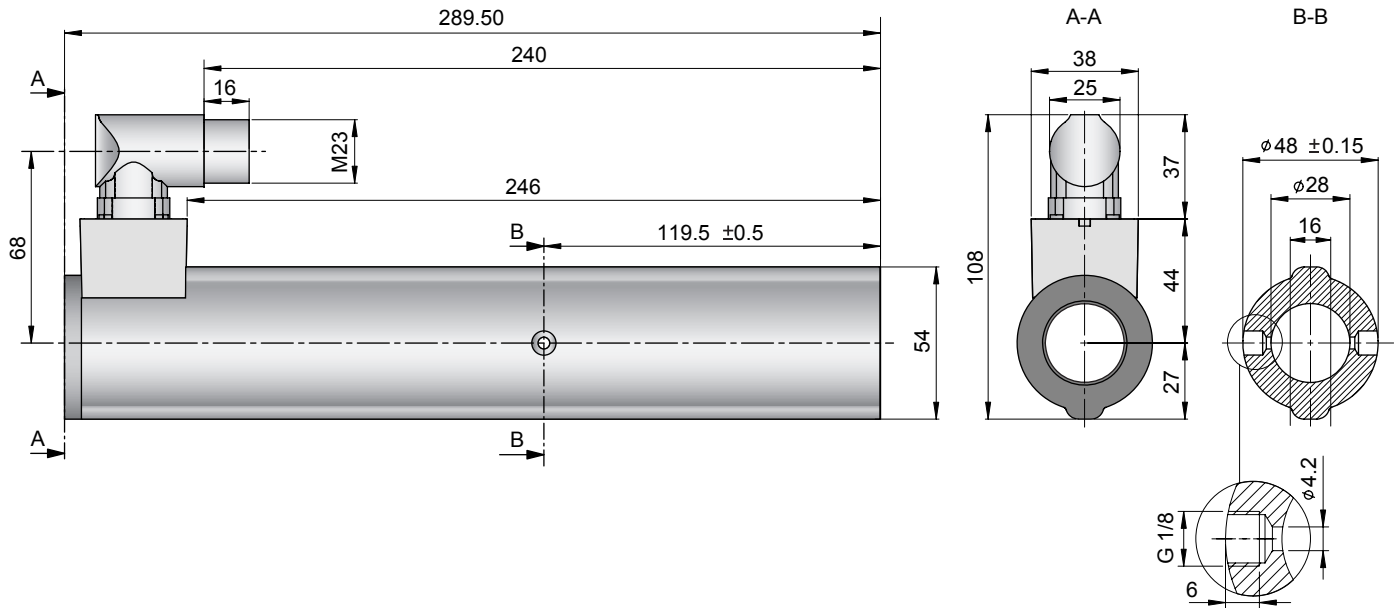

Linear Motor		Stator		Slider	
Type	Art.No	Type	Art. No.	Type	Art No.
P01-48x210E/90x240-C	-->	PS01-48x210E-C	0150-2797	& PL01-28x410/330	0150-1381

Slider

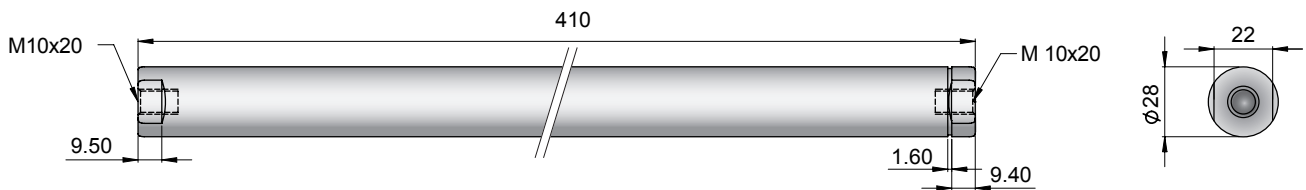

Standard Type	Slider Standard	PL01-28x410/330	0150-1381
Special Sliders	Heavy Duty Slider with WC/C-Coating	PL02-28x410/330	0150-1412
	Hollow Slider hole diameter 6mm		not available
	High Clearance Slider d=27mm, m=1620g	PL01-27x410/330	0150-1468

Connectors

Motor connector Wiring

P01-48...-C

Ph 1+	Red	A
Ph 1-	Pink	B
Ph 2+	Blue	C
Ph 2-	Grey	D
+5VDC	White	E
GND	Inner Shield	F
Sine	Yellow	G
Cosine	Green	H
Temp.	Black	L
Shield	Outer Shield	Case

Accessoires

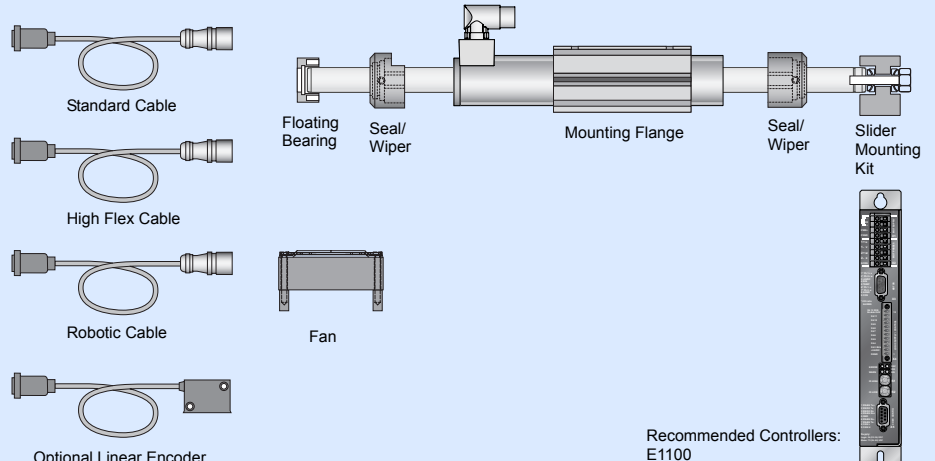

Max. Stroke: 330mm
Peak Force: 544N

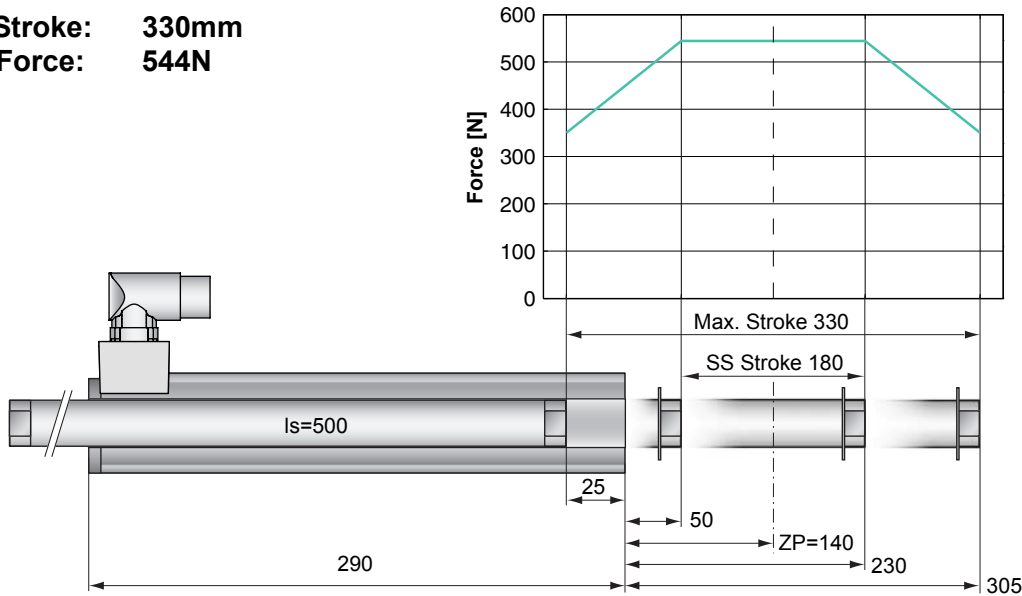

Dimensions in mm

Motor Specification

		E-Winding	
		P01-48x210E/180x330-C	
Stroke Max.	mm (in)	330 (12.99)	
Stroke SS	mm (in)	180 (7.09)	
Peak Force E1100-XC	N (lbf)	544 (122.3)	
Cont. Force	N (lbf)	133 (30.0)	
Cont. Force compressed air cooling	N (lbf)	213 (47.9)	
Cont. Force Fan cooling	N (lbf)	235 (52.8)	
Border Force	%	64	
Force Constant	N/A (lbf/A)	27.2 (6.12)	
Max. Current @ 72VDC	A	20.0	
Max. Velocity @ 72VDC	m/s (in/s)	2.4 (96)	
Phase Resist. 25/80 °C	Ohm	1.8/2.1	
Phase Inductance	mH	1.7	
Thermal Resistance	°K/W	1.08	
Thermal Time Const.	sec	3000	
Stator Diameter	mm (in)	48 (1.89)	
Stator Length	mm (in)	290 (11.40)	
Stator Mass	g (lb)	1930 (4.25)	
Slider Diameter	mm (in)	28 (1.10)	
Slider Length	mm (in)	500 (19.69)	
Slider Mass	g (lb)	2160 (4.76)	
Position Repeatability	mm (in)	±0.05 (±0.0020)	
Linearity	%	±0.1	
Position Rep. with ES	mm (in)	±0.01 (±0.0004)	
Linearity with ES	mm (in)	±0.01 (±0.0004)	

Position-Time Diagram

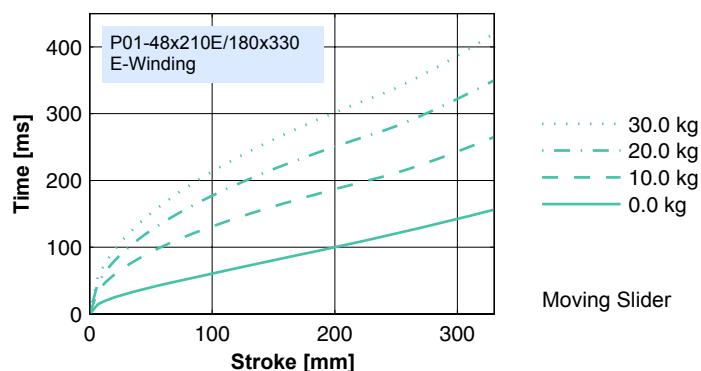

Connector Type

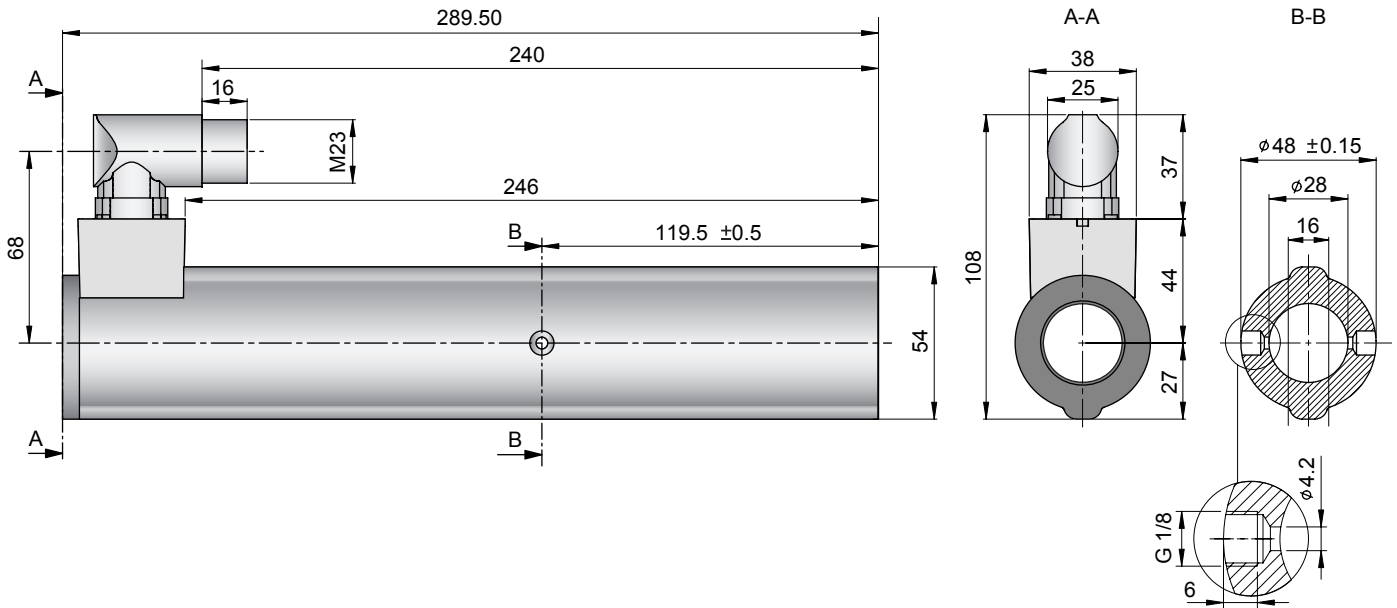

Linear Motor		Stator		Slider	
Type	Art.No	Type	Art. No.	Type	Art No.
P01-48x210E/180x330-C	-->	PS01-48x210E-C	0150-2797	& PL01-28x500/420	0150-1382

Slider

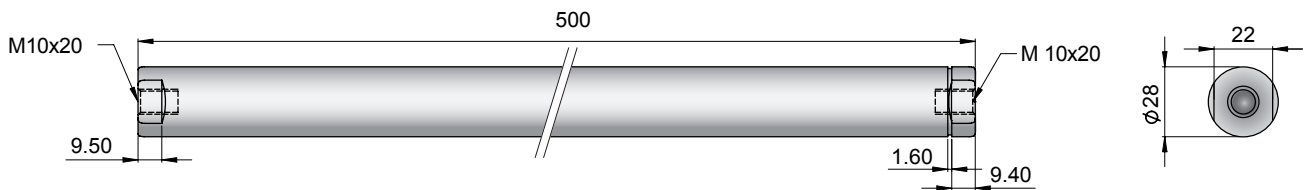

Standard Type	Slider Standard	PL01-28x500/420	0150-1382
Special Sliders	Heavy Duty Slider with WC/C-Coating	PL02-28x500/420	0150-1413
	Hollow Slider hole diameter 6mm		not available
	High Clearance Slider d=27mm, m=2010g	PL01-27x500/420	0150-1469

Connectors

Motor connector Wiring

P01-48...-C

Ph 1+	Red	A
Ph 1-	Pink	B
Ph 2+	Blue	C
Ph 2-	Grey	D
+5VDC	White	E
GND	Inner Shield	F
Sine	Yellow	G
Cosine	Green	H
Temp.	Black	L
Shield	Outer Shield	Case

Accessoires

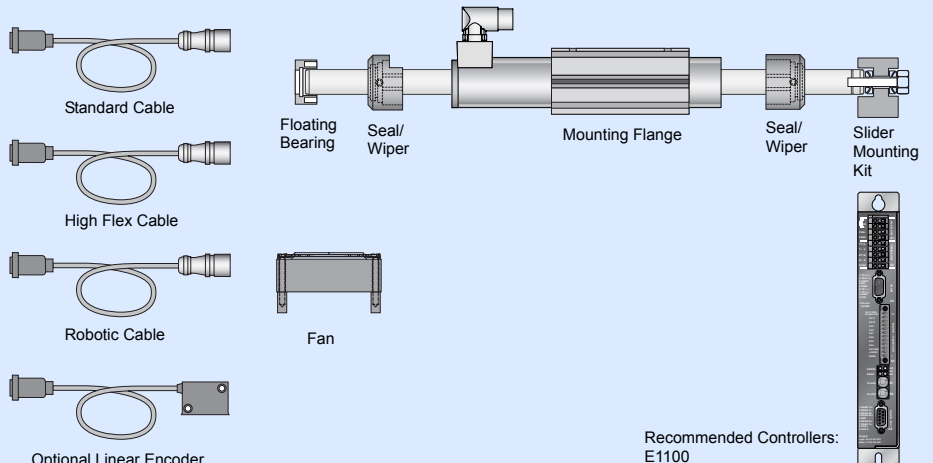

Max. Stroke: 450mm
Peak Force: 544N

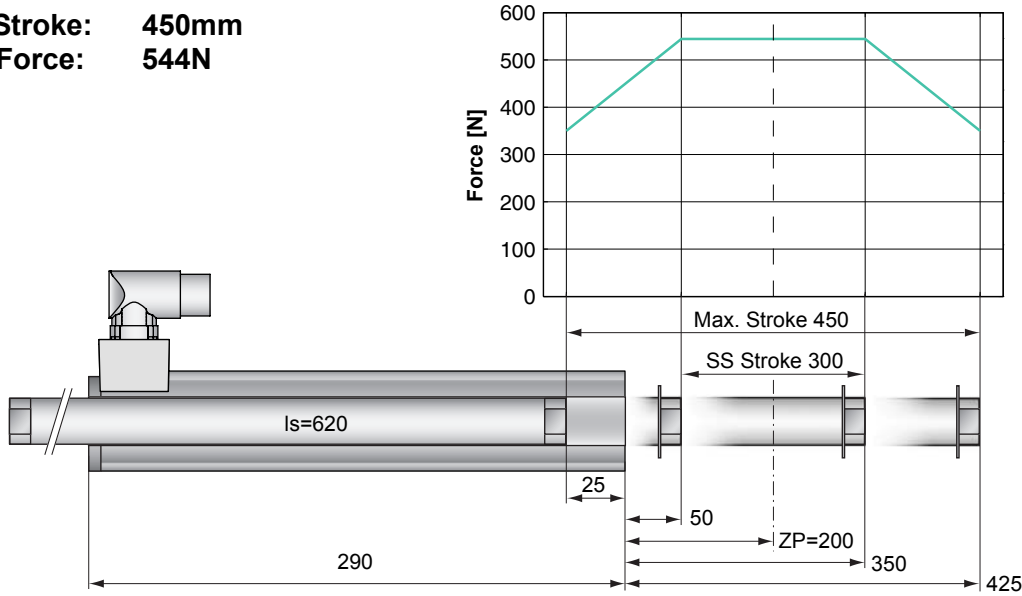

Dimensions in mm

Motor Specification

		E-Winding
		P01-48x210E/300x450-C
Stroke Max.	mm (in)	450 (17.72)
Stroke SS	mm (in)	300 (11.81)
Peak Force E1100-XC	N (lbf)	544 (122.3)
Cont. Force	N (lbf)	133 (30.0)
Cont. Force compressed air cooling	N (lbf)	213 (47.9)
Cont. Force Fan cooling	N (lbf)	235 (52.8)
Border Force	%	64
Force Constant	N/A (lbf/A)	27.2 (6.12)
Max. Current @ 72VDC	A	20.0
Max. Velocity @ 72VDC	m/s (in/s)	2.4 (96)
Phase Resist. 25/80 °C	Ohm	1.8/2.1
Phase Inductance	mH	1.7
Thermal Resistance	°K/W	1.08
Thermal Time Const.	sec	3000
Stator Diameter	mm (in)	48 (1.89)
Stator Length	mm (in)	290 (11.40)
Stator Mass	g (lb)	1930 (4.25)
Slider Diameter	mm (in)	28 (1.10)
Slider Length	mm (in)	620 (24.41)
Slider Mass	g (lb)	2720 (6.00)
Position Repeatability	mm (in)	±0.05 (±0.0020)
Linearity	%	±0.1
Position Rep. with ES	mm (in)	±0.01 (±0.0004)
Linearity with ES	mm (in)	±0.01 (±0.0004)

Position-Time Diagram

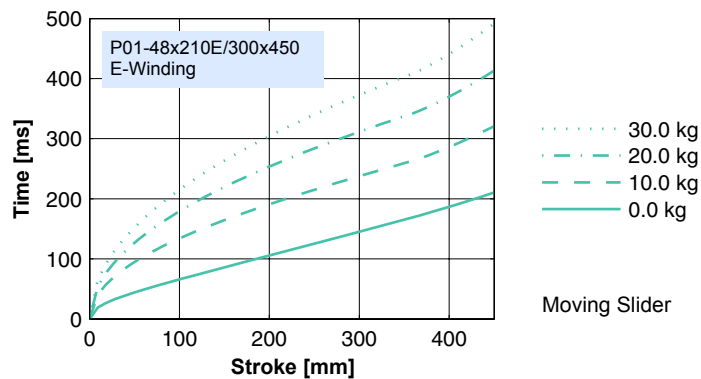

Connector Type

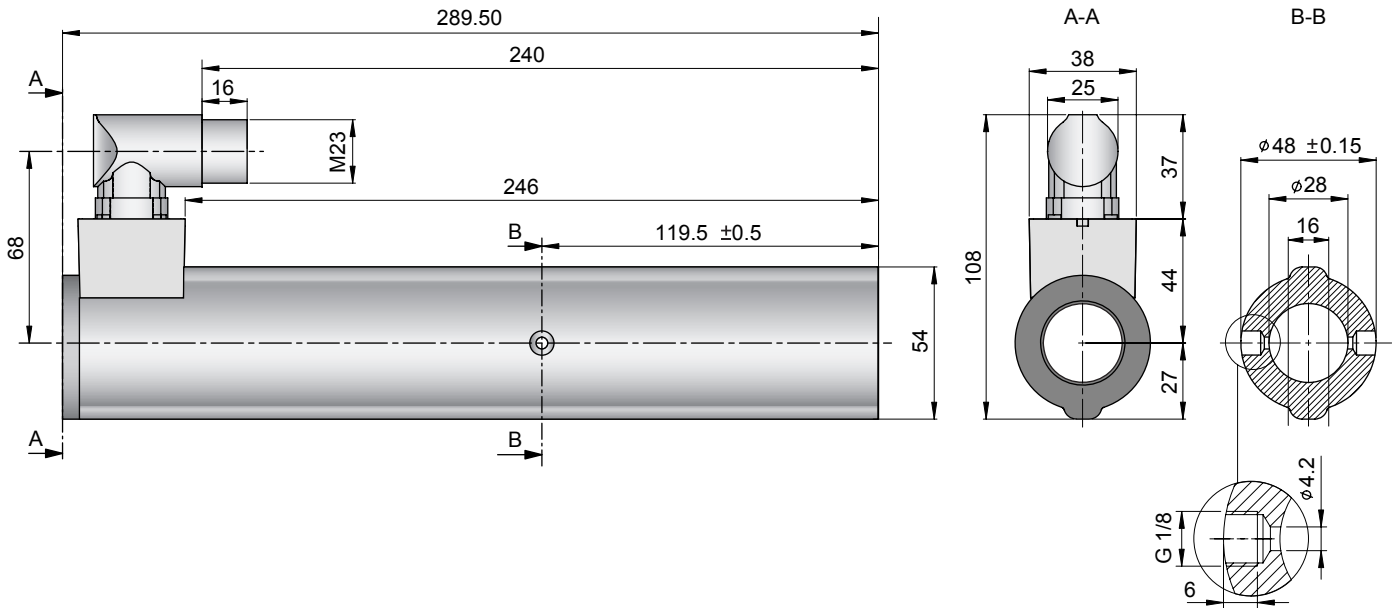

Linear Motor		Stator		Slider	
Type	Art.No	Type	Art. No.	Type	Art No.
P01-48x210E/300x450-C	-->	PS01-48x210E-C	0150-2797	& PL01-28x620/540	0150-1383

Slider

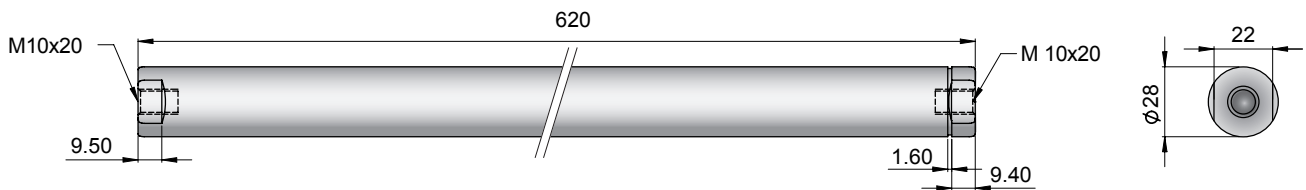

Standard Type	Slider Standard	PL01-28x620/540	0150-1383
Special Sliders	Heavy Duty Slider with WC/C-Coating	PL02-28x620/540	0150-1414
	Hollow Slider hole diameter 6mm		not available
	High Clearance Slider d=27mm, m=2530g	PL01-27x620/540	0150-1470

Connectors

Motor connector Wiring

P01-48...-C

Ph 1+	Red	A
Ph 1-	Pink	B
Ph 2+	Blue	C
Ph 2-	Grey	D
+5VDC	White	E
GND	Inner Shield	F
Sine	Yellow	G
Cosine	Green	H
Temp.	Black	L
Shield	Outer Shield	Case

Accessoires

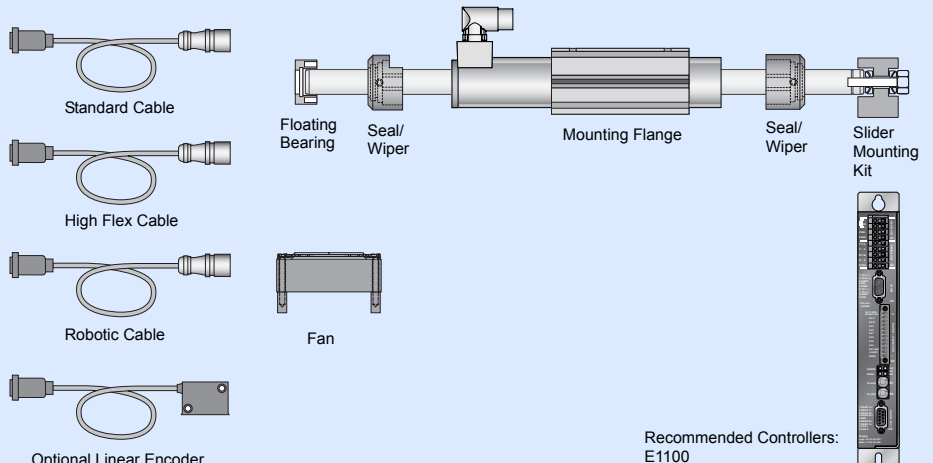

Max. Stroke: 540mm
Peak Force: 544N

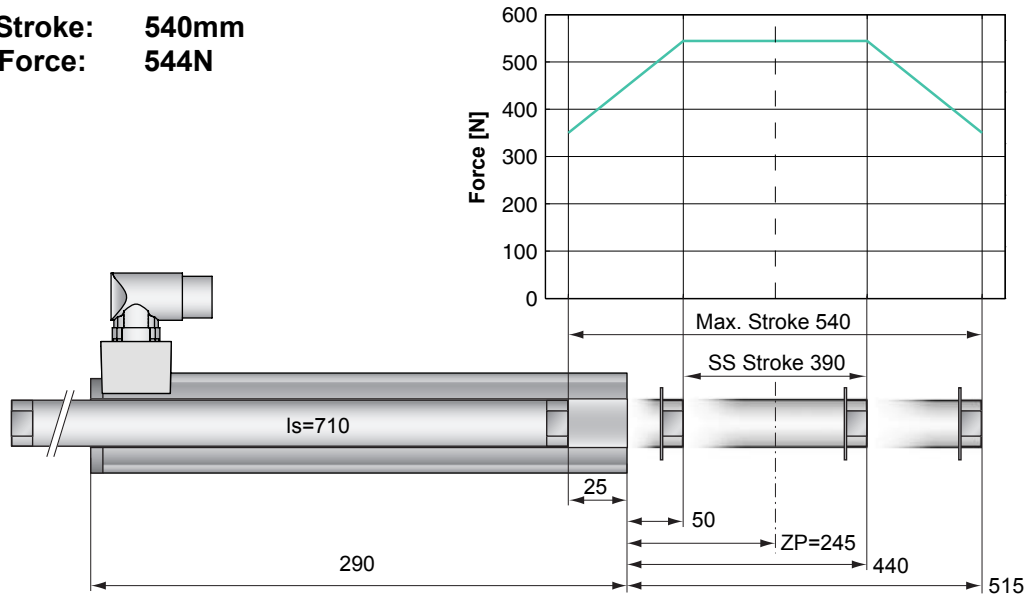

Dimensions in mm

Motor Specification

		E-Winding	
		P01-48x210E/390x540-C	
Stroke Max.	mm (in)	540 (21.26)	
Stroke SS	mm (in)	390 (15.35)	
Peak Force E1100-XC	N (lbf)	544 (122.3)	
Cont. Force	N (lbf)	133 (30.0)	
Cont. Force compressed air cooling	N (lbf)	213 (47.9)	
Cont. Force Fan cooling	N (lbf)	235 (52.8)	
Border Force	%	64	
Force Constant	N/A (lbf/A)	27.2 (6.12)	
Max. Current @ 72VDC	A	20.0	
Max. Velocity @ 72VDC	m/s (in/s)	2.4 (96)	
Phase Resist. 25/80 °C	Ohm	1.8/2.1	
Phase Inductance	mH	1.7	
Thermal Resistance	°K/W	1.08	
Thermal Time Const.	sec	3000	
Stator Diameter	mm (in)	48 (1.89)	
Stator Length	mm (in)	290 (11.40)	
Stator Mass	g (lb)	1930 (4.25)	
Slider Diameter	mm (in)	28 (1.10)	
Slider Length	mm (in)	710 (27.95)	
Slider Mass	g (lb)	3140 (6.92)	
Position Repeatability	mm (in)	±0.05 (±0.0020)	
Linearity	%	±0.1	
Position Rep. with ES	mm (in)	±0.01 (±0.0004)	
Linearity with ES	mm (in)	±0.01 (±0.0004)	

Position-Time Diagram

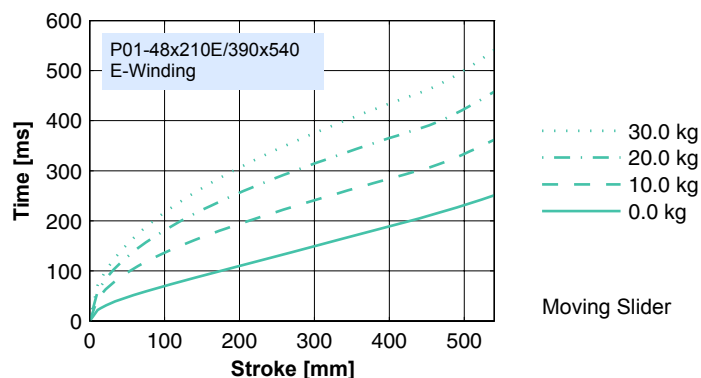

Connector Type

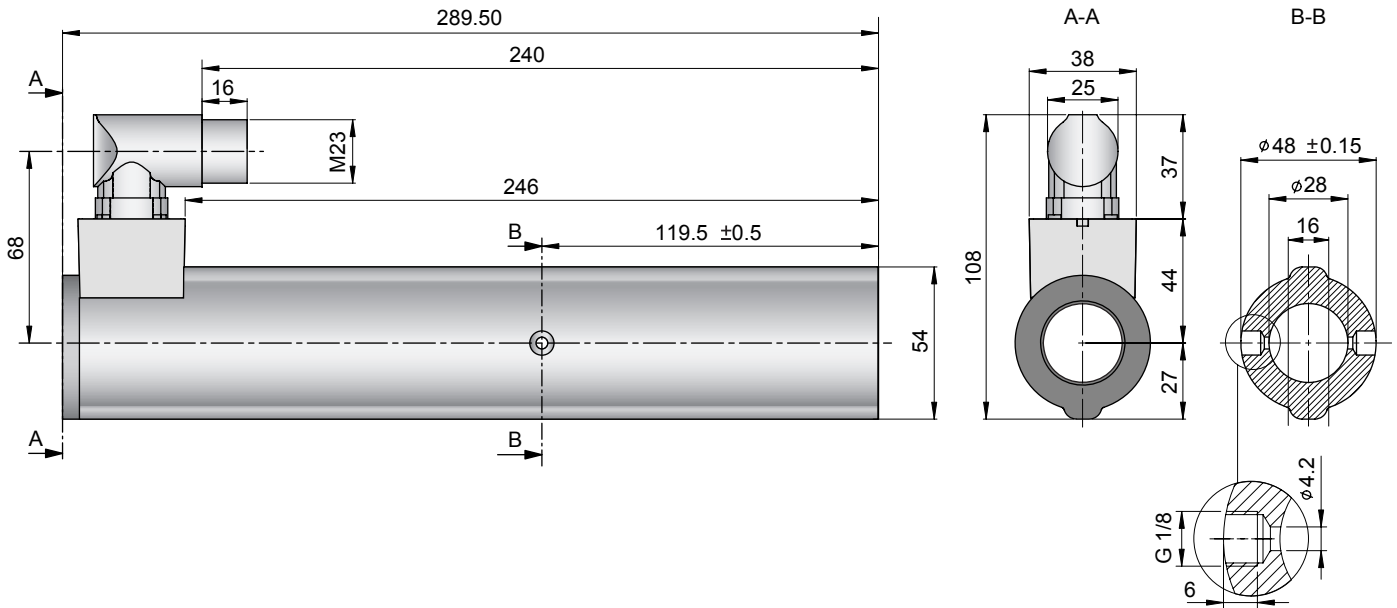

Linear Motor		Stator		Slider	
Type	Art.No	Type	Art. No.	Type	Art No.
P01-48x210E/390x540-C	-->	PS01-48x210E-C	0150-2797	& PL01-28x710/630	0150-1384

Slider

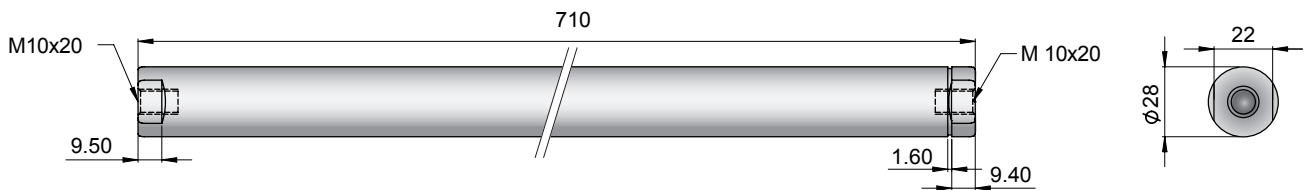

Standard Type	Slider Standard	PL01-28x710/630	0150-1384
Special Sliders	Heavy Duty Slider with WC/C-Coating	PL02-28x710/630	0150-1415
	Hollow Slider hole diameter 6mm		not available
	High Clearance Slider d=27mm, m=2920g	PL01-27x710/630	0150-1471

Connectors

Motor connector Wiring

P01-48...-C

Ph 1+	Red	A
Ph 1-	Pink	B
Ph 2+	Blue	C
Ph 2-	Grey	D
+5VDC	White	E
GND	Inner Shield	F
Sine	Yellow	G
Cosine	Green	H
Temp.	Black	L
Shield	Outer Shield	Case

Accessoires

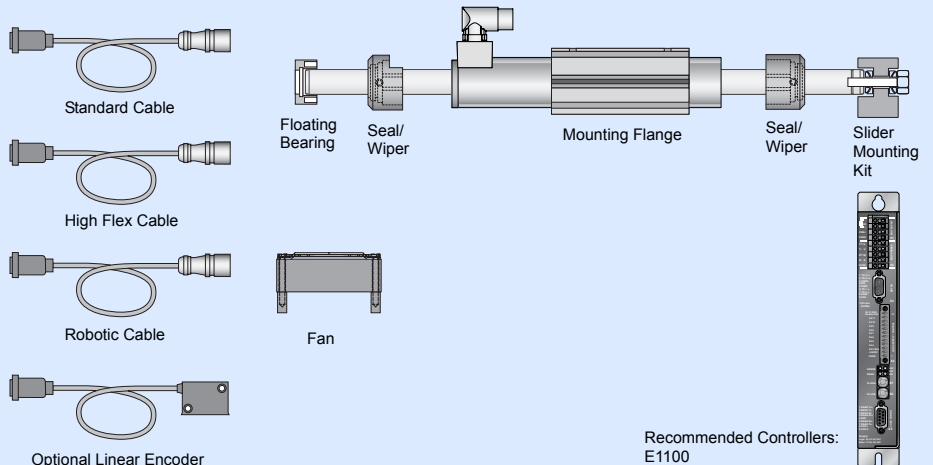

Max. Stroke: 630mm
Peak Force: 544N

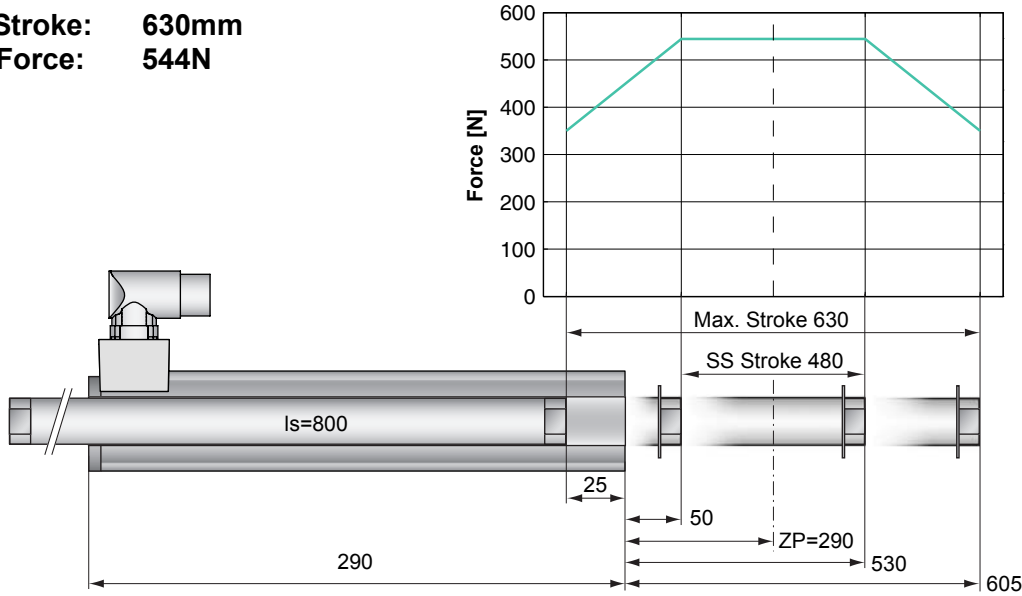

Dimensions in mm

Motor Specification

		E-Winding	
		P01-48x210E/480x630-C	
Stroke Max.	mm (in)	630 (24.80)	
Stroke SS	mm (in)	480 (18.90)	
Peak Force E1100-XC	N (lbf)	544 (122.3)	
Cont. Force	N (lbf)	133 (30.0)	
Cont. Force compressed air cooling	N (lbf)	213 (47.9)	
Cont. Force Fan cooling	N (lbf)	235 (52.8)	
Border Force	%	64	
Force Constant	N/A (lbf/A)	27.2 (6.12)	
Max. Current @ 72VDC	A	20.0	
Max. Velocity @ 72VDC	m/s (in/s)	2.4 (96)	
Phase Resist. 25/80 °C	Ohm	1.8/2.1	
Phase Inductance	mH	1.7	
Thermal Resistance	°K/W	1.08	
Thermal Time Const.	sec	3000	
Stator Diameter	mm (in)	48 (1.89)	
Stator Length	mm (in)	290 (11.40)	
Stator Mass	g (lb)	1930 (4.25)	
Slider Diameter	mm (in)	28 (1.10)	
Slider Length	mm (in)	800 (31.50)	
Slider Mass	g (lb)	3560 (7.85)	
Position Repeatability	mm (in)	±0.05 (±0.0020)	
Linearity	%	±0.1	
Position Rep. with ES	mm (in)	±0.01 (±0.0004)	
Linearity with ES	mm (in)	±0.01 (±0.0004)	

Position-Time Diagram

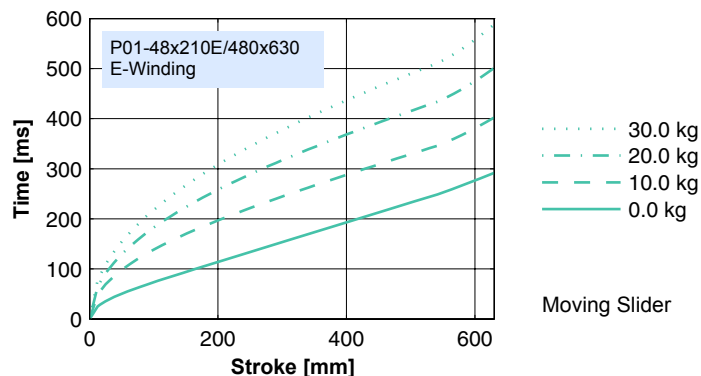

Connector Type

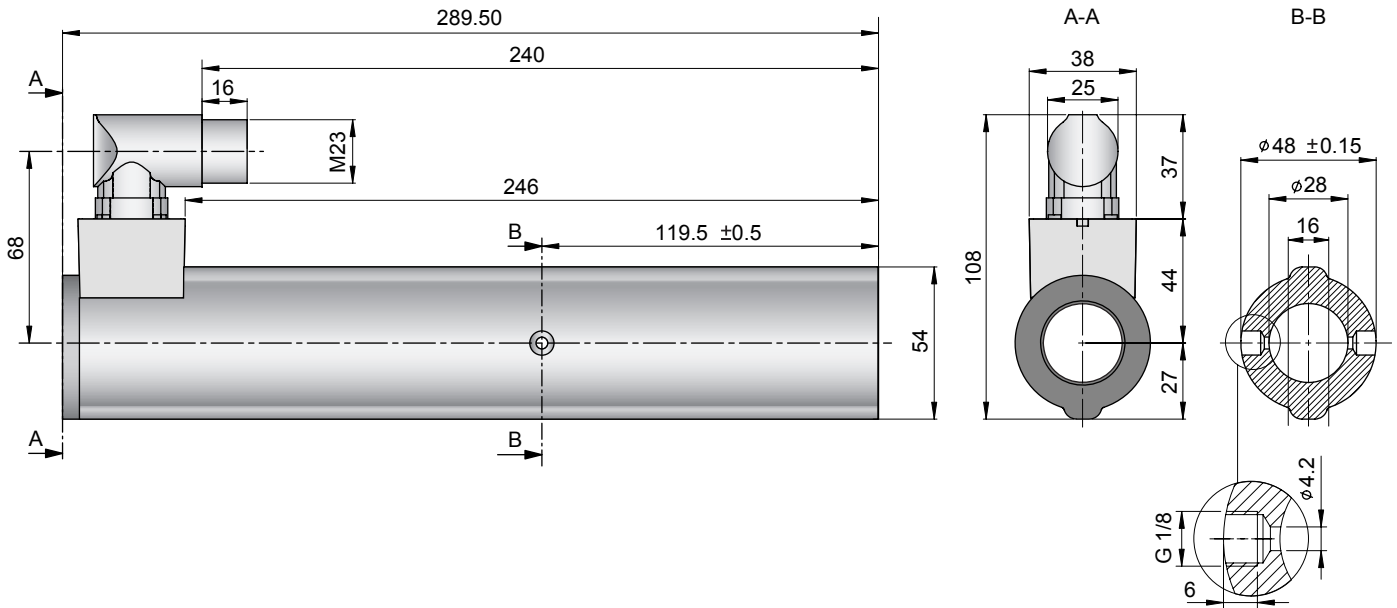

Linear Motor		Stator		Slider	
Type	Art.No	Type	Art. No.	Type	Art No.
P01-48x210E/480x630-C	-->	PS01-48x210E-C	0150-2797	& PL01-28x800/720	0150-1385

Slider

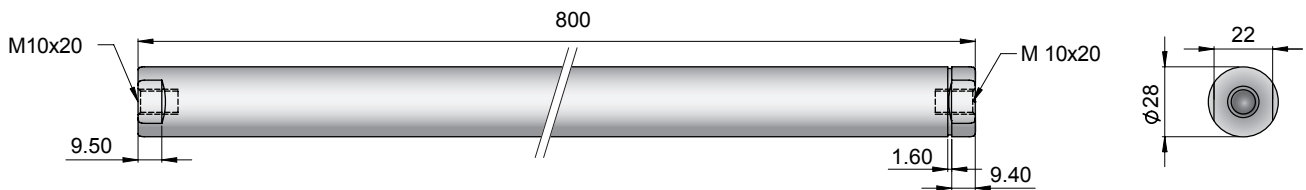

Standard Type	Slider Standard	PL01-28x800/720	0150-1385
Special Sliders	Heavy Duty Slider with WC/C-Coating	PL02-28x800/720	0150-1416
	Hollow Slider hole diameter 6mm		not available
	High Clearance Slider d=27mm, m=3310g	PL01-27x800/720	0150-1472

Connectors

Motor connector Wiring

P01-48...-C

Ph 1+	Red	A
Ph 1-	Pink	B
Ph 2+	Blue	C
Ph 2-	Grey	D
+5VDC	White	E
GND	Inner Shield	F
Sine	Yellow	G
Cosine	Green	H
Temp.	Black	L
Shield	Outer Shield	Case

Accessoires

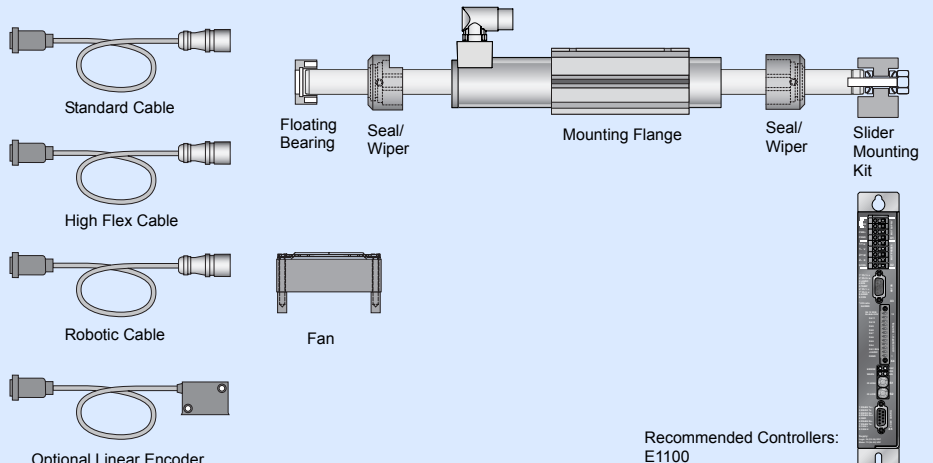

Max. Stroke: 750mm
Peak Force: 544N

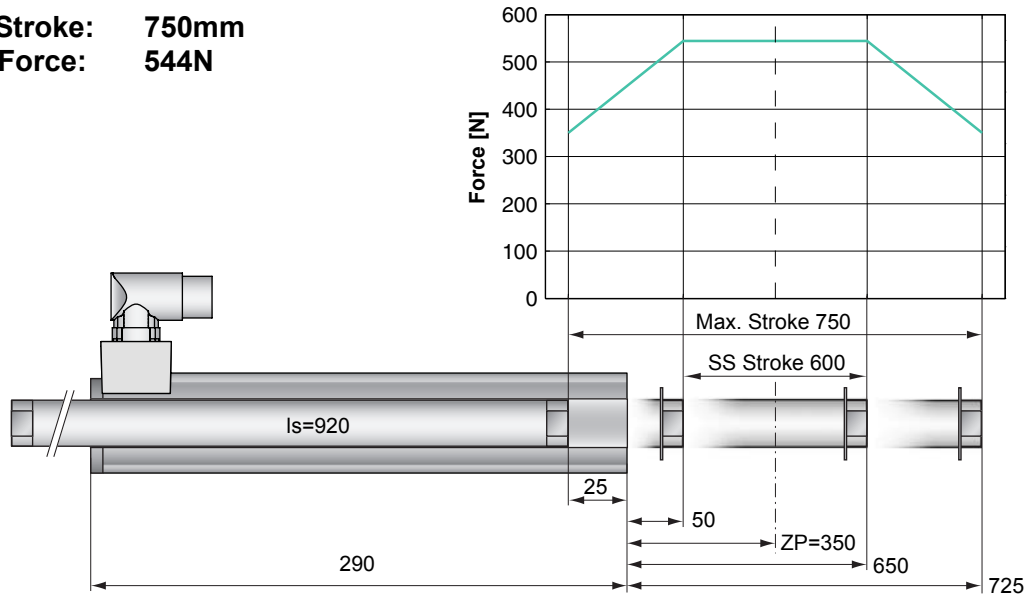

Dimensions in mm

Motor Specification

		E-Winding	
		P01-48x210E/600x750-C	
Stroke Max.	mm (in)	750 (29.53)	
Stroke SS	mm (in)	600 (23.62)	
Peak Force E1100-XC	N (lbf)	544 (122.3)	
Cont. Force	N (lbf)	133 (30.0)	
Cont. Force compressed air cooling	N (lbf)	213 (47.9)	
Cont. Force Fan cooling	N (lbf)	235 (52.8)	
Border Force	%	64	
Force Constant	N/A (lbf/A)	27.2 (6.12)	
Max. Current @ 72VDC	A	20.0	
Max. Velocity @ 72VDC	m/s (in/s)	2.4 (96)	
Phase Resist. 25/80 °C	Ohm	1.8/2.1	
Phase Inductance	mH	1.7	
Thermal Resistance	°K/W	1.08	
Thermal Time Const.	sec	3000	
Stator Diameter	mm (in)	48 (1.89)	
Stator Length	mm (in)	290 (11.40)	
Stator Mass	g (lb)	1930 (4.25)	
Slider Diameter	mm (in)	28 (1.10)	
Slider Length	mm (in)	920 (36.22)	
Slider Mass	g (lb)	4120 (9.08)	
Position Repeatability	mm (in)	±0.05 (±0.0020)	
Linearity	%	±0.1	
Position Rep. with ES	mm (in)	±0.01 (±0.0004)	
Linearity with ES	mm (in)	±0.01 (±0.0004)	

Position-Time Diagram

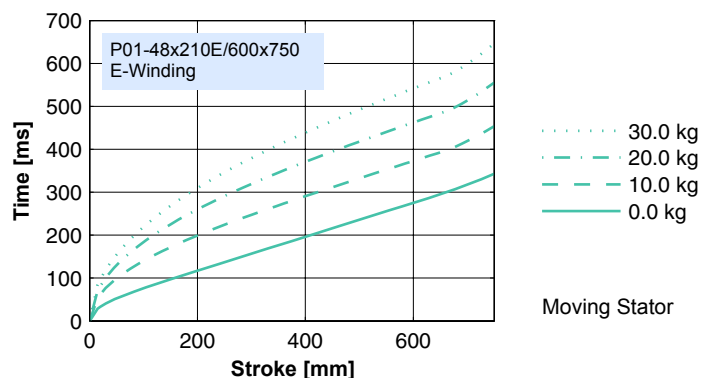

Moving Stator

Connector Type

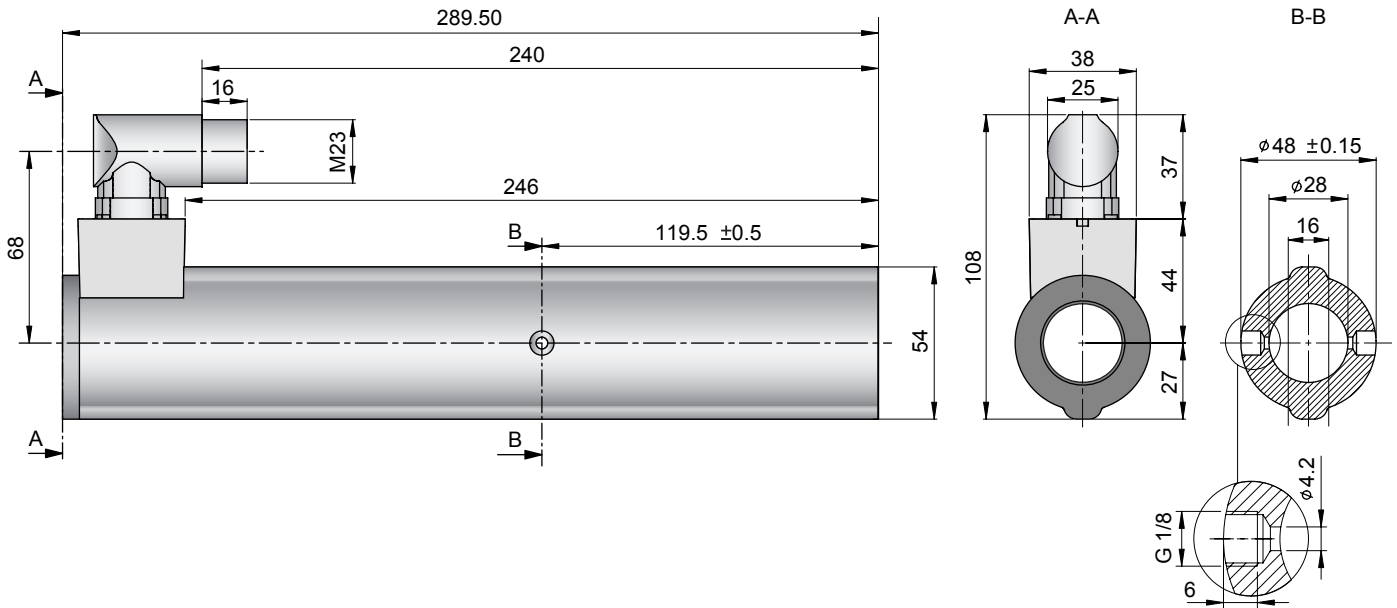

Linear Motor		Stator		Slider	
Type	Art.No	Type	Art. No.	Type	Art No.
P01-48x210E/600x750-C	-->	PS01-48x210E-C	0150-2797	& PL01-28x920/840	0150-1386

Slider

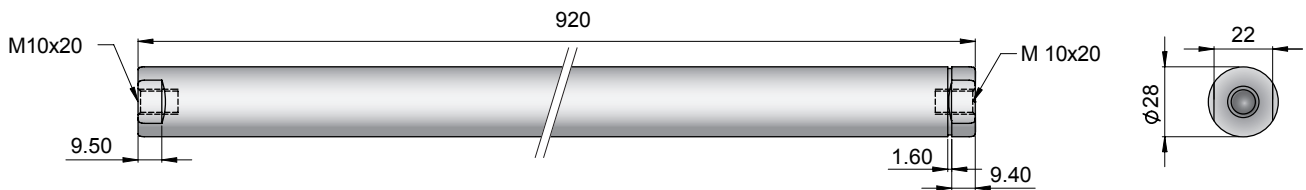

Standard Type	Slider Standard	PL01-28x920/840	0150-1386
Special Sliders	Heavy Duty Slider with WC/C-Coating	PL02-28x920/840	0150-1417
	Hollow Slider hole diameter 6mm		not available
	High Clearance Slider d=27mm, m=3830g	PL01-27x920/840	0150-1447

Connectors

Motor connector Wiring

P01-48...-C

Ph 1+	Red	A
Ph 1-	Pink	B
Ph 2+	Blue	C
Ph 2-	Grey	D
+5VDC	White	E
GND	Inner Shield	F
Sine	Yellow	G
Cosine	Green	H
Temp.	Black	L
Shield	Outer Shield	Case

Accessoires

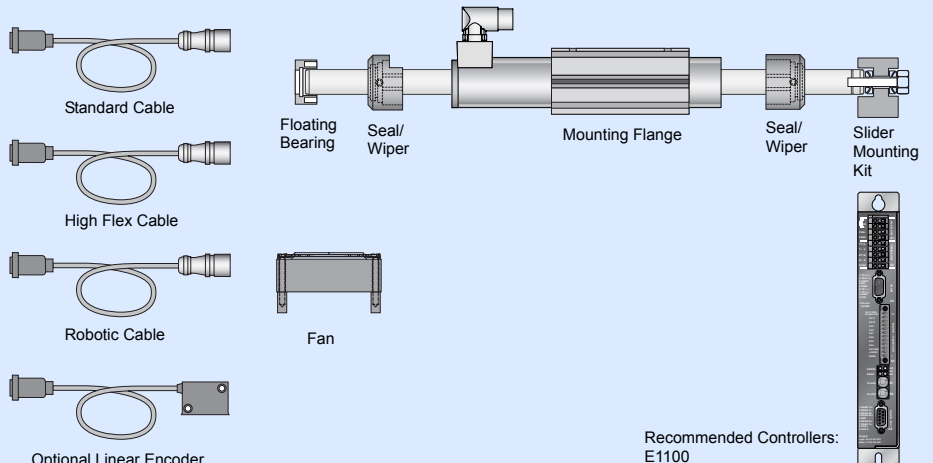

Max. Stroke: 840mm
Peak Force: 544N

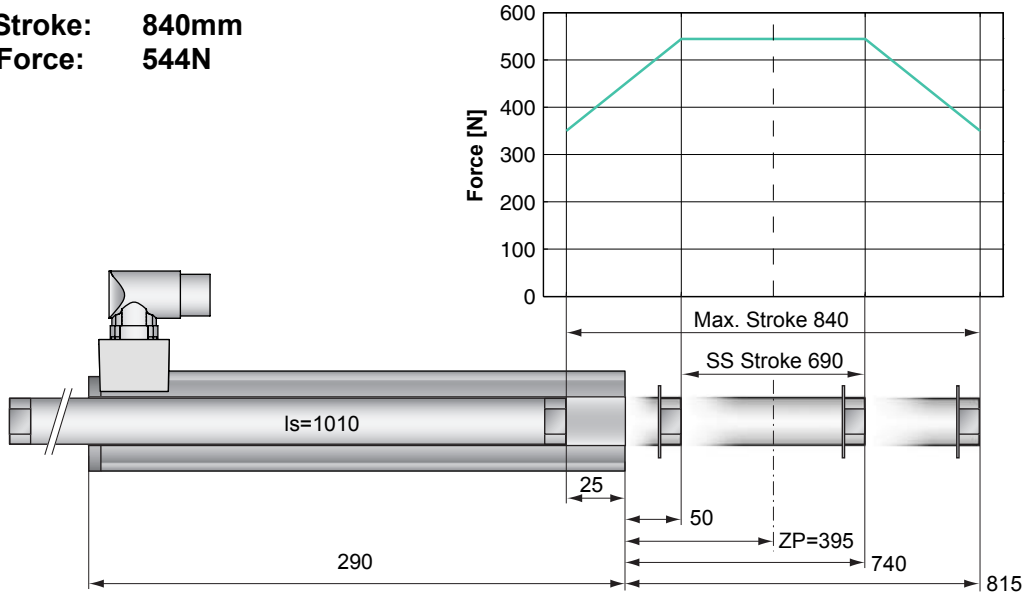

Dimensions in mm

Motor Specification

		E-Winding	
		P01-48x210E/690x840-C	
Stroke Max.	mm (in)	840 (33.07)	
Stroke SS	mm (in)	690 (27.17)	
Peak Force E1100-XC	N (lbf)	544 (122.3)	
Cont. Force	N (lbf)	133 (30.0)	
Cont. Force compressed air cooling	N (lbf)	213 (47.9)	
Cont. Force Fan cooling	N (lbf)	235 (52.8)	
Border Force	%	64	
Force Constant	N/A (lbf/A)	27.2 (6.12)	
Max. Current @ 72VDC	A	20.0	
Max. Velocity @ 72VDC	m/s (in/s)	2.4 (96)	
Phase Resist. 25/80 °C	Ohm	1.8/2.1	
Phase Inductance	mH	1.7	
Thermal Resistance	°K/W	1.08	
Thermal Time Const.	sec	3000	
Stator Diameter	mm (in)	48 (1.89)	
Stator Length	mm (in)	290 (11.40)	
Stator Mass	g (lb)	1930 (4.25)	
Slider Diameter	mm (in)	28 (1.10)	
Slider Length	mm (in)	1010 (39.76)	
Slider Mass	g (lb)	4540 (10.01)	
Position Repeatability	mm (in)	±0.05 (±0.0020)	
Linearity	%	±0.1	
Position Rep. with ES	mm (in)	±0.01 (±0.0004)	
Linearity with ES	mm (in)	±0.01 (±0.0004)	

Position-Time Diagram

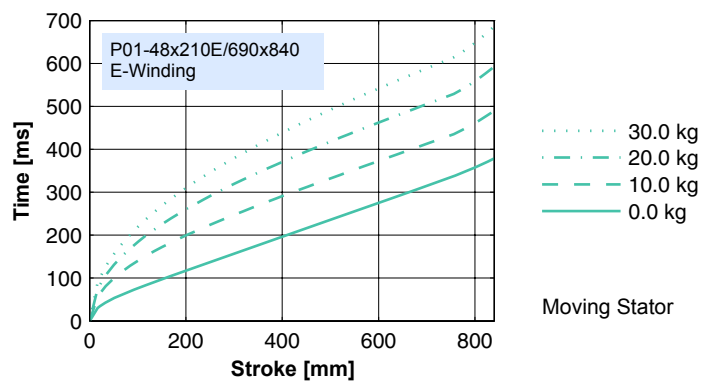

Connector Type

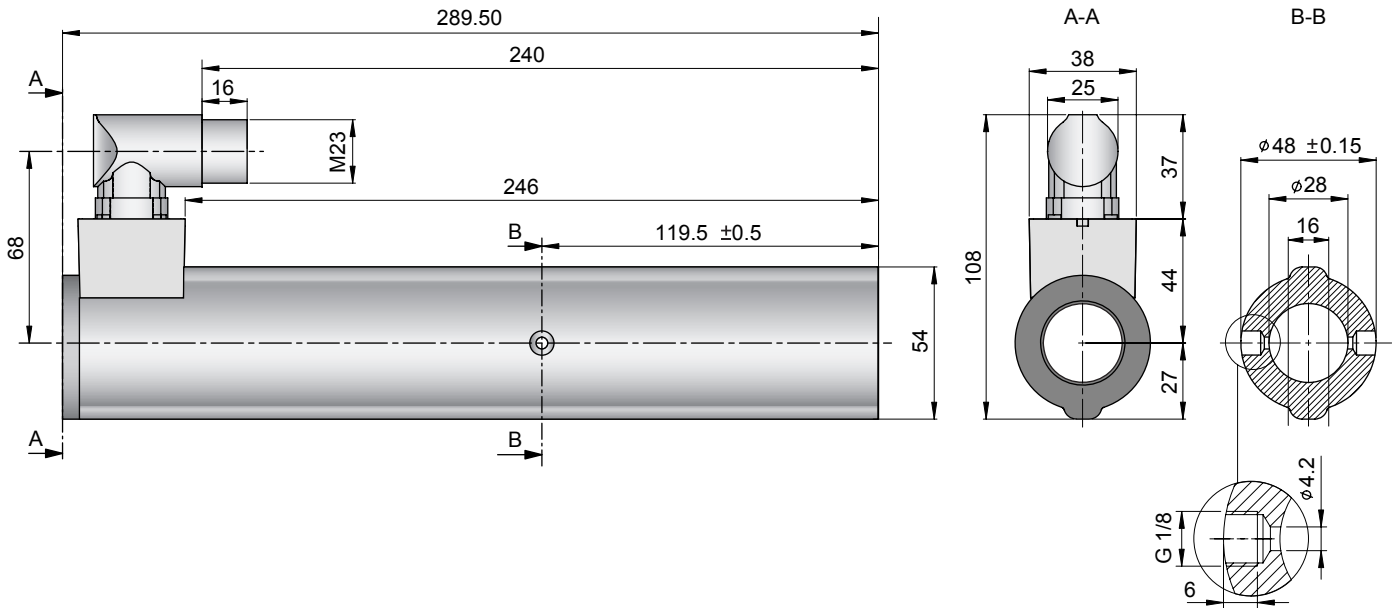

Linear Motor		Stator		Slider	
Type	Art.No	Type	Art. No.	Type	Art No.
P01-48x210E/690x840-C	-->	PS01-48x210E-C	0150-2797	& PL01-28x1010/930	0150-1387

Slider

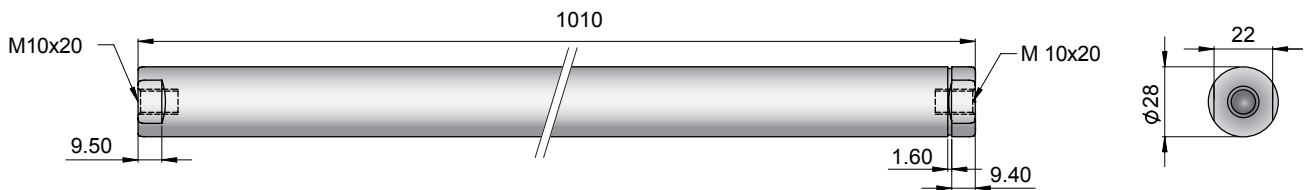

Standard Type	Slider Standard	PL01-28x1010/930	0150-1387
Special Sliders	Heavy Duty Slider with WC/C-Coating		not available
	Hollow Slider hole diameter 6mm		not available
	High Clearance Slider d=27mm, m=4220g	PL01-27x1010/930	0150-1473

Connectors

Motor connector Wiring

P01-48...-C

Ph 1+	Red	A
Ph 1-	Pink	B
Ph 2+	Blue	C
Ph 2-	Grey	D
+5VDC	White	E
GND	Inner Shield	F
Sine	Yellow	G
Cosine	Green	H
Temp.	Black	L
Shield	Outer Shield	Case

Accessoires

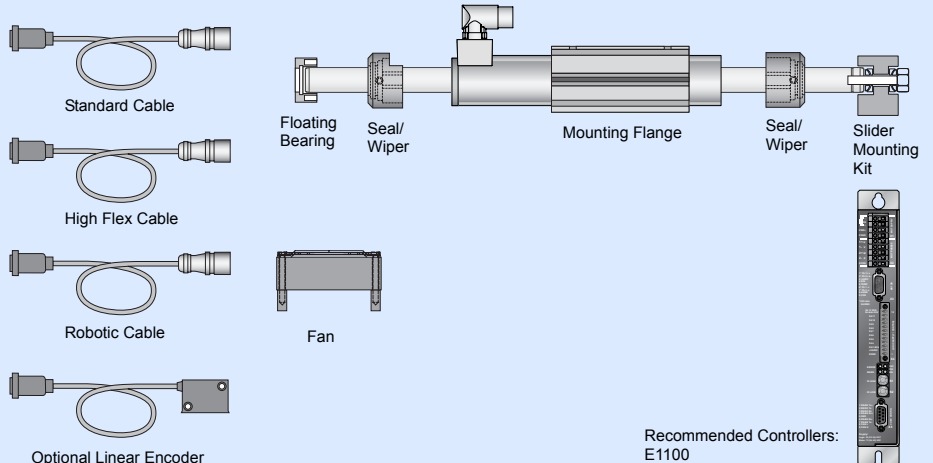

Max. Stroke: 1050mm
Peak Force: 544N

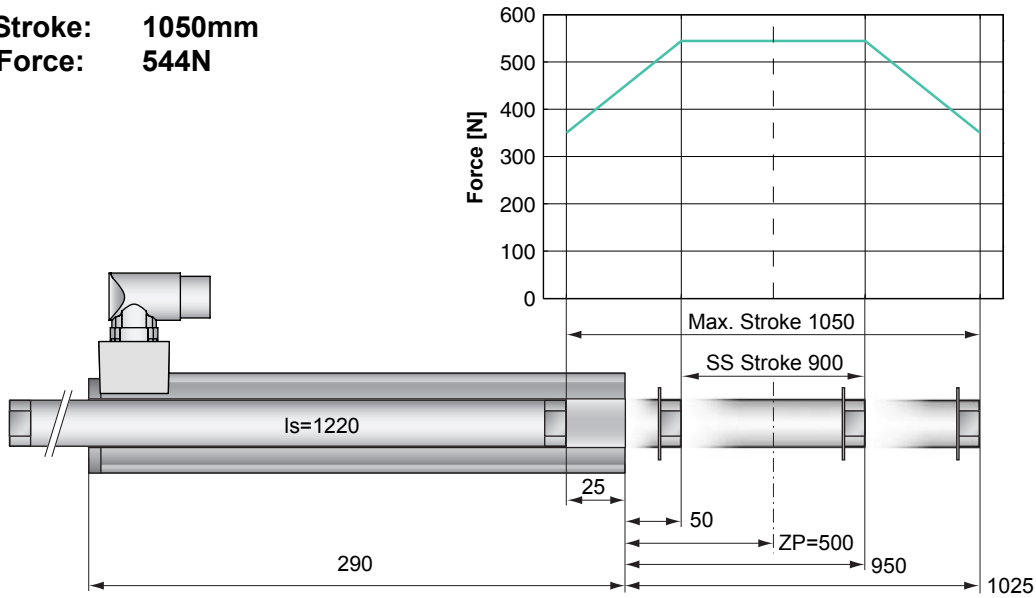

Dimensions in mm

Motor Specification

		E-Winding
		P01-48x210E/900x1050-C
Stroke Max.	mm (in)	1050 (41.34)
Stroke SS	mm (in)	900 (35.43)
Peak Force E1100-XC	N (lbf)	544 (122.3)
Cont. Force	N (lbf)	133 (30.0)
Cont. Force compressed air cooling	N (lbf)	213 (47.9)
Cont. Force Fan cooling	N (lbf)	235 (52.8)
Border Force	%	64
Force Constant	N/A (lbf/A)	27.2 (6.12)
Max. Current @ 72VDC	A	20.0
Max. Velocity @ 72VDC	m/s (in/s)	2.4 (96)
Phase Resist. 25/80 °C	Ohm	1.8/2.1
Phase Inductance	mH	1.7
Thermal Resistance	°K/W	1.08
Thermal Time Const.	sec	3000
Stator Diameter	mm (in)	48 (1.89)
Stator Length	mm (in)	290 (11.40)
Stator Mass	g (lb)	1930 (4.25)
Slider Diameter	mm (in)	28 (1.10)
Slider Length	mm (in)	1220 (48.03)
Slider Mass	g (lb)	5510 (12.15)
Position Repeatability	mm (in)	±0.05 (±0.0020)
Linearity	%	±0.1
Position Rep. with ES	mm (in)	±0.01 (±0.0004)
Linearity with ES	mm (in)	±0.01 (±0.0004)

Position-Time Diagram

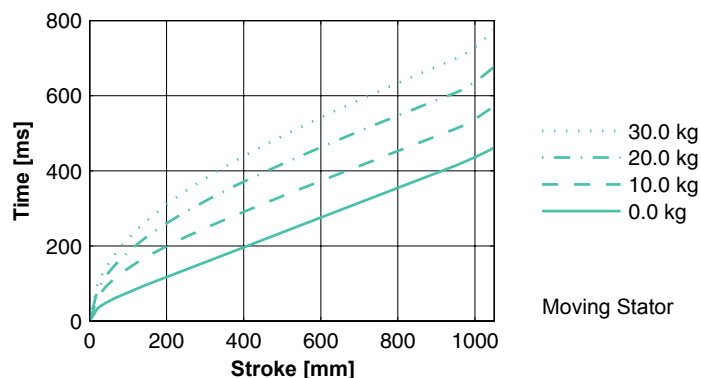

Moving Stator

Connector Type

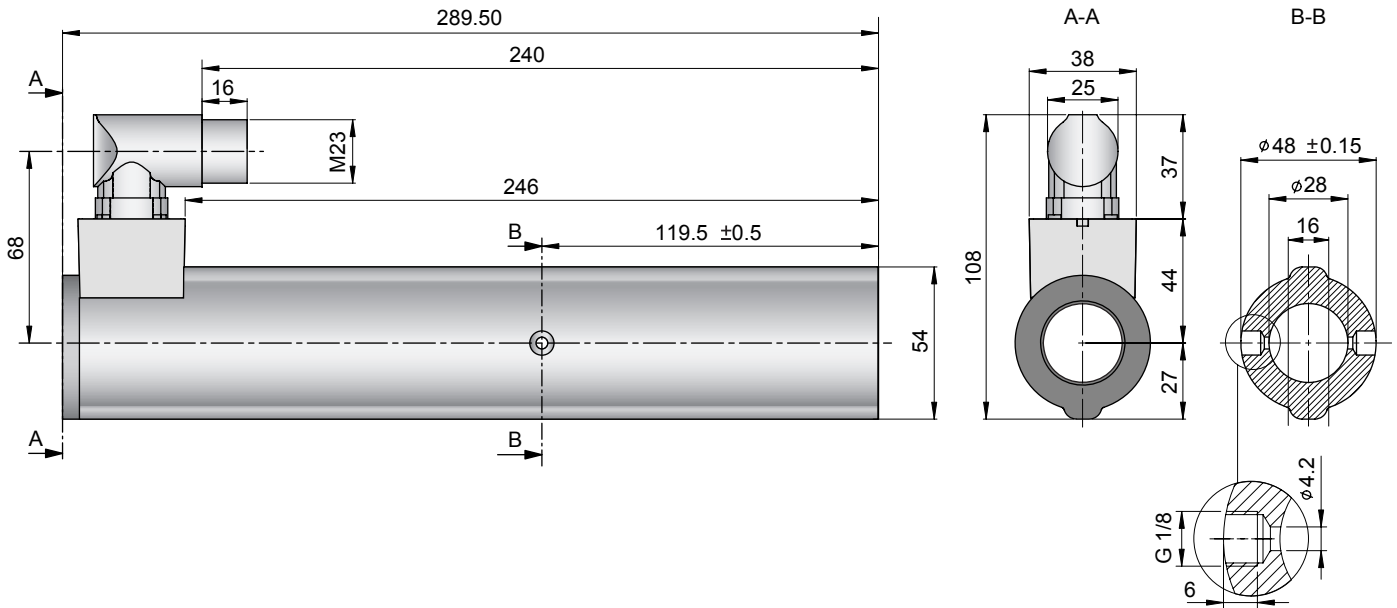

Linear Motor		Stator		Slider	
Type	Art.No	Type	Art. No.	Type	Art No.
P01-48x210E/900x1050-C	-->	PS01-48x210E-C	0150-2797	& PL01-28x1220/1140	0150-1388

Slider

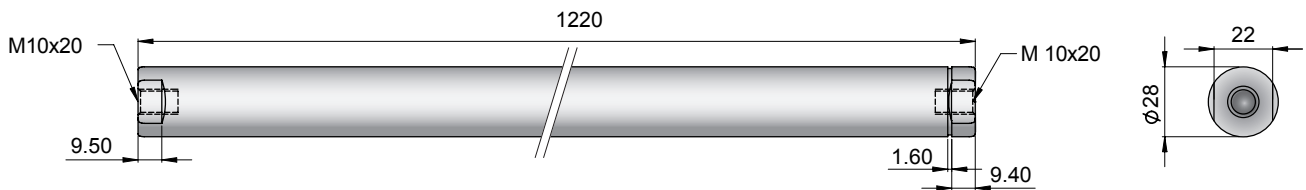

Standard Type	Slider Standard	PL01-28x1220/1140	0150-1388
Special Sliders	Heavy Duty Slider with WC/C-Coating		not available
	Hollow Slider hole diameter 6mm		not available
	High Clearance Slider d=27mm, m=3830g	PL01-27x920/840	0150-1447

Connectors

Motor connector Wiring

P01-48...-C

Ph 1+	Red	A
Ph 1-	Pink	B
Ph 2+	Blue	C
Ph 2-	Grey	D
+5VDC	White	E
GND	Inner Shield	F
Sine	Yellow	G
Cosine	Green	H
Temp.	Black	L
Shield	Outer Shield	Case

Accessoires

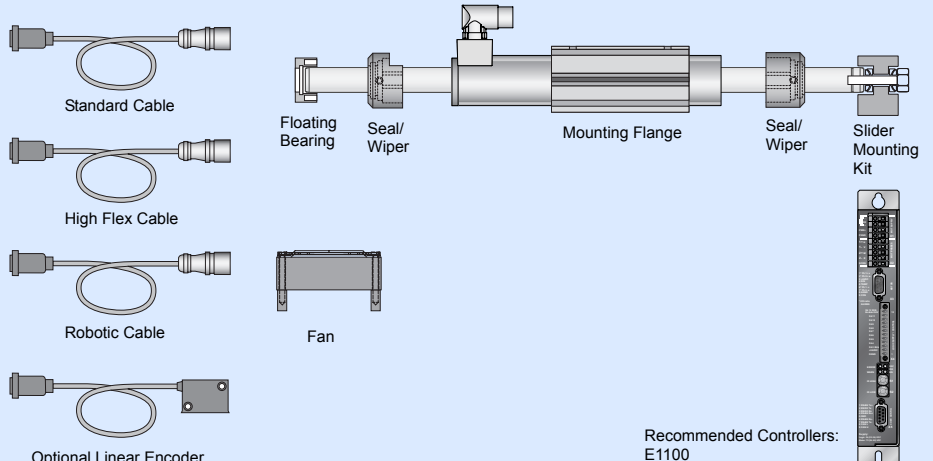

Max. Stroke: 1230mm
Peak Force: 544N

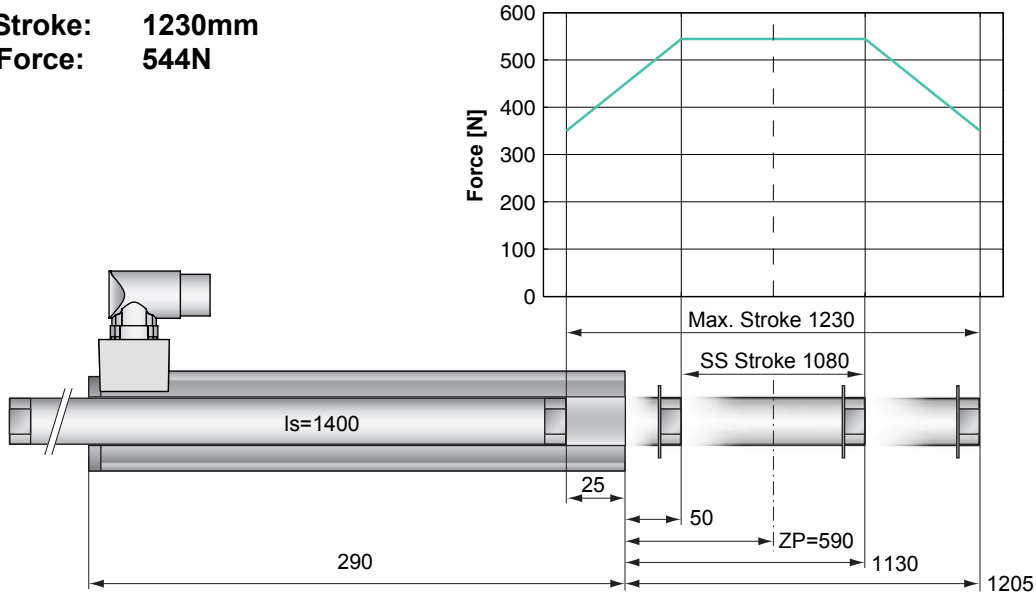

Motor Specification

		E-Winding	
		P01-48x210E/1080x1230-C	
Stroke Max.	mm (in)	1230 (48.43)	
Stroke SS	mm (in)	1080 (42.52)	
Peak Force E1100-XC	N (lbf)	544 (122.3)	
Cont. Force	N (lbf)	133 (30.0)	
Cont. Force compressed air cooling	N (lbf)	213 (47.9)	
Cont. Force Fan cooling	N (lbf)	235 (52.8)	
Border Force	%	64	
Force Constant	N/A (lbf/A)	27.2 (6.12)	
Max. Current @ 72VDC	A	20.0	
Max. Velocity @ 72VDC	m/s (in/s)	2.4 (96)	
Phase Resist. 25/80 °C	Ohm	1.8/2.1	
Phase Inductance	mH	1.7	
Thermal Resistance	°K/W	1.08	
Thermal Time Const.	sec	3000	
Stator Diameter	mm (in)	48 (1.89)	
Stator Length	mm (in)	290 (11.40)	
Stator Mass	g (lb)	1930 (4.25)	
Slider Diameter	mm (in)	28 (1.10)	
Slider Length	mm (in)	1400 (55.12)	
Slider Mass	g (lb)	6350 (14.00)	
Position Repeatability	mm (in)	±0.05 (±0.0020)	
Linearity	%	±0.1	
Position Rep. with ES	mm (in)	±0.01 (±0.0004)	
Linearity with ES	mm (in)	±0.01 (±0.0004)	

Position-Time Diagram

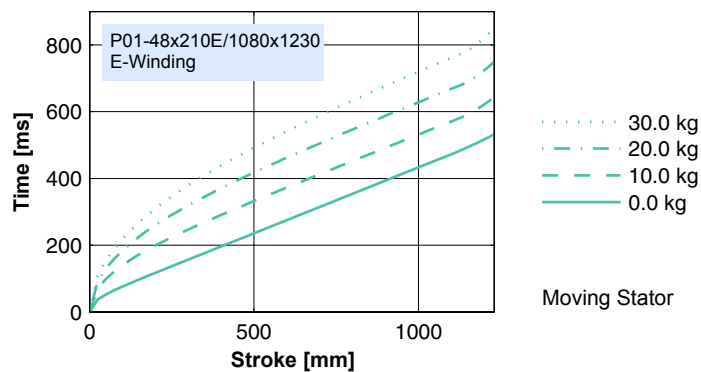

Connector Type

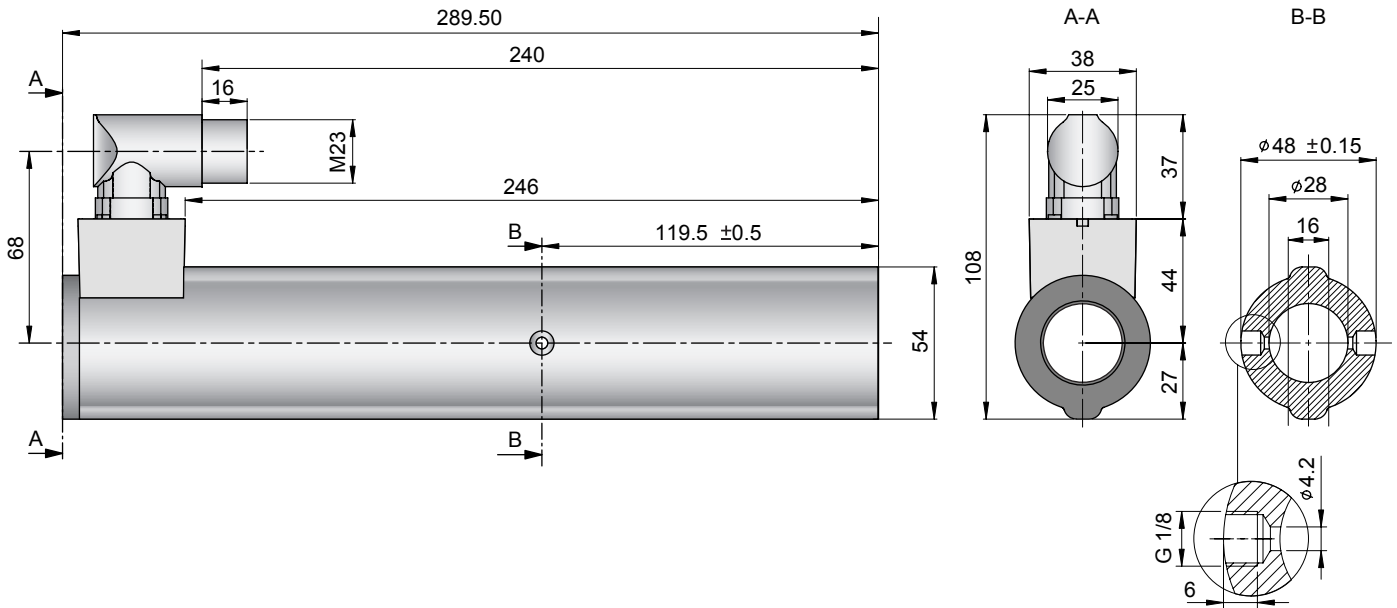

Linear Motor		Stator		Slider	
Type	Art.No	Type	Art. No.	Type	Art No.
P01-48x210E/1080x1230-C	-->	PS01-48x210E-C	0150-2797	& PL01-28x1400/1320	0150-1389

Slider

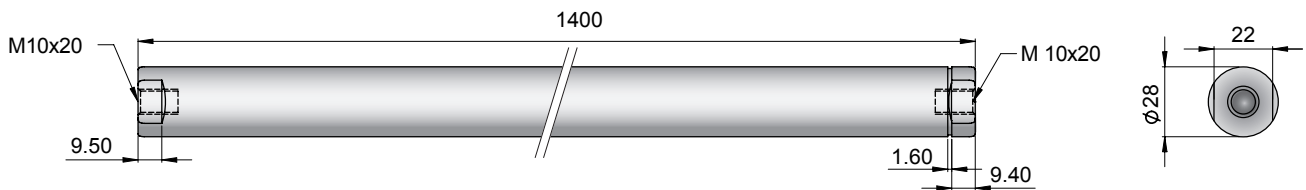

Standard Type	Slider Standard	PL01-28x1400/1320	0150-1389
Special Sliders	Heavy Duty Slider with WC/C-Coating		not available
	Hollow Slider hole diameter 6mm		not available
	High Clearance Slider d=27mm, m=3830g	PL01-27x920/840	0150-1447

Connectors

Motor connector Wiring

P01-48...-C

Ph 1+	Red	A
Ph 1-	Pink	B
Ph 2+	Blue	C
Ph 2-	Grey	D
+5VDC	White	E
GND	Inner Shield	F
Sine	Yellow	G
Cosine	Green	H
Temp.	Black	L
Shield	Outer Shield	Case

Accessoires

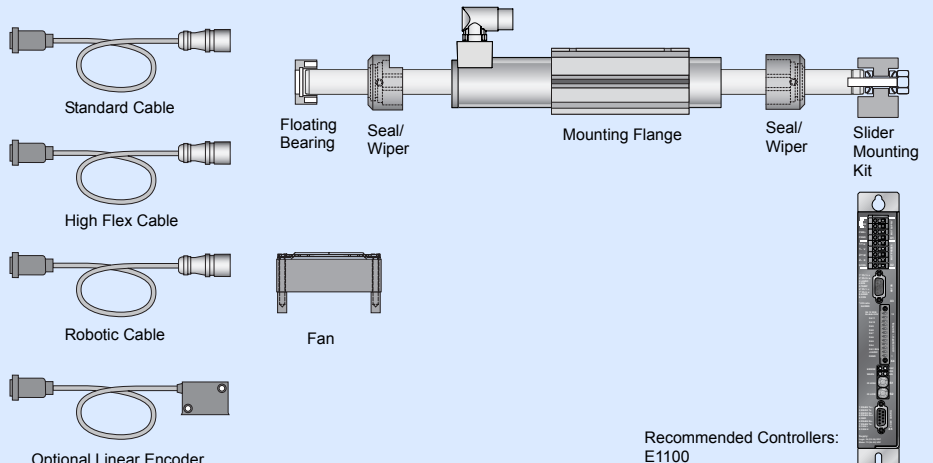

Max. Stroke: 1440mm
Peak Force: 544N

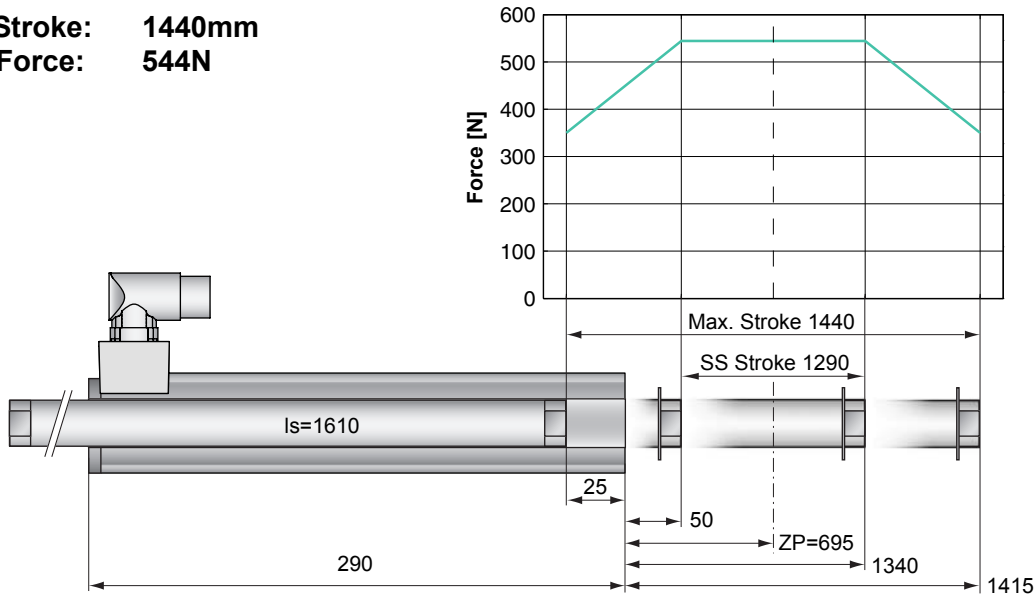

Dimensions in mm

Motor Specification

		E-Winding	
		P01-48x210E/1290x1440-C	
Stroke Max.	mm (in)	1440 (56.69)	
Stroke SS	mm (in)	1290 (50.79)	
Peak Force E1100-XC	N (lbf)	544 (122.3)	
Cont. Force	N (lbf)	133 (30.0)	
Cont. Force compressed air cooling	N (lbf)	213 (47.9)	
Cont. Force Fan cooling	N (lbf)	235 (52.8)	
Border Force	%	64	
Force Constant	N/A (lbf/A)	27.2 (6.12)	
Max. Current @ 72VDC	A	20.0	
Max. Velocity @ 72VDC	m/s (in/s)	2.4 (96)	
Phase Resist. 25/80 °C	Ohm	1.8/2.1	
Phase Inductance	mH	1.7	
Thermal Resistance	°K/W	1.08	
Thermal Time Const.	sec	3000	
Stator Diameter	mm (in)	48 (1.89)	
Stator Length	mm (in)	290 (11.40)	
Stator Mass	g (lb)	1930 (4.25)	
Slider Diameter	mm (in)	28 (1.10)	
Slider Length	mm (in)	1610 (63.39)	
Slider Mass	g (lb)	7330 (16.16)	
Position Repeatability	mm (in)	±0.05 (±0.0020)	
Linearity	%	±0.1	
Position Rep. with ES	mm (in)	±0.01 (±0.0004)	
Linearity with ES	mm (in)	±0.01 (±0.0004)	

Position-Time Diagram

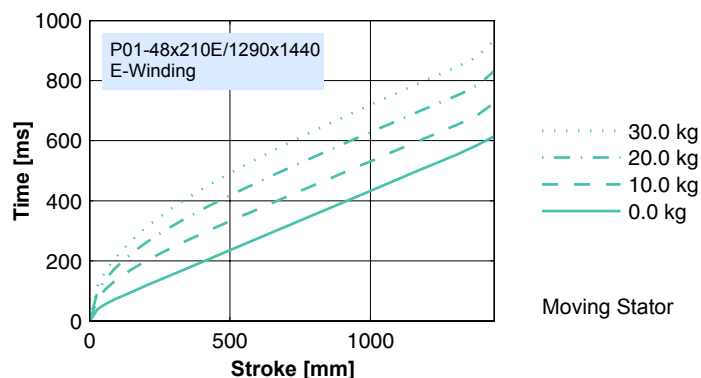

Moving Stator

Connector Type

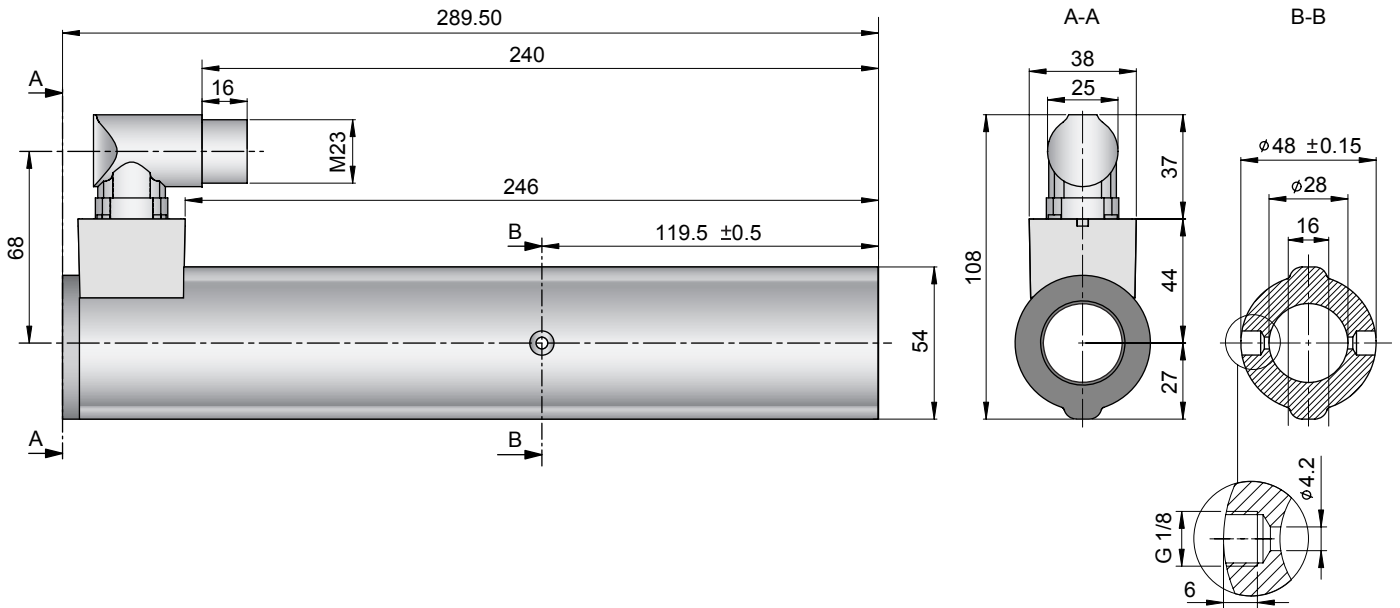

Linear Motor		Stator		Slider	
Type	Art.No	Type	Art. No.	Type	Art No.
P01-48x210E/1290x1440-C	-->	PS01-48x210E-C	0150-2797	& PL01-28x1610/1530	0150-1390

Slider

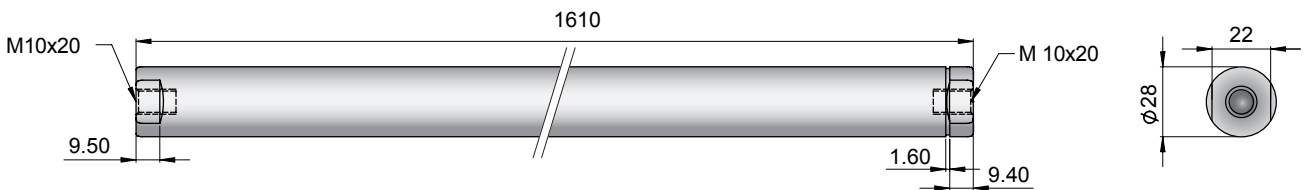

Standard Type	Slider Standard	PL01-28x1610/1530	0150-1390
Special Sliders	Heavy Duty Slider with WC/C-Coating		not available
	Hollow Slider hole diameter 6mm		not available
	High Clearance Slider d=27mm, m=1360g	PL01-27x350/270	0150-1467

Connectors

Motor connector Wiring

P01-48...-C

Ph 1+	Red	A
Ph 1-	Pink	B
Ph 2+	Blue	C
Ph 2-	Grey	D
+5VDC	White	E
GND	Inner Shield	F
Sine	Yellow	G
Cosine	Green	H
Temp.	Black	L
Shield	Outer Shield	Case

Accessoires

