

# Installation Guide Linear Motors

ENG

## P01-37S-HP-SSCP



## Content

<b>1</b>	<b>General information .....</b>	<b>4</b>
1.1	Introduction .....	4
1.2	Explanation of symbols .....	4
1.3	Qualified personnel .....	4
1.4	Liability .....	4
1.5	Copyright .....	4
<b>2</b>	<b>Safety instructions .....</b>	<b>5</b>
<b>3</b>	<b>Installation Instructions .....</b>	<b>7</b>
3.1	Operating Conditions .....	7
3.2	Assembly of the Linear Motor .....	7
3.3	Mounting the Stator .....	8
3.4	Mounting the Payload to the Slider .....	8
3.5	"Moving Slider" Installation .....	10
3.6	"Moving Stator" Installation .....	10
3.6.1	Assembling Instruction .....	11
3.7	Minimum Distance from Slider .....	13
3.7.1	Minimum Distance from Slider to Slider .....	13
3.7.2	Minimum Distance from Slider to metallic Parts .....	13
<b>4</b>	<b>Electrical Connection .....</b>	<b>14</b>
4.1	Motor Cable .....	14
4.1.1	Technical Data of the Stator Cable .....	14
4.1.2	Cable Type Stators .....	14
4.1.3	Technical Data .....	15
4.2	Connectors .....	15
4.2.1	IP Class IP67 .....	15
4.2.2	IP Class IP69k .....	16
4.2.3	Pin Assignment Linear Motor .....	16
<b>5</b>	<b>Accessories .....</b>	<b>17</b>
5.1	Motor Cables .....	17
5.2	Bearing Kit .....	19
5.2.1	Mounting .....	19
5.3	Slider Mounting Kits .....	19
5.3.1	Fixed Bearing .....	19
5.3.2	Floating Bearing .....	20
<b>6</b>	<b>Maintenance and Test Instructions .....</b>	<b>21</b>
6.1	Stator Checking .....	21
6.2	Maintenance of Linear Motors .....	22
6.2.1	Maintenance Schedule .....	22
6.2.2	Cleaning .....	22
6.2.3	Cleaning Agents / Lubricants .....	23
<b>7</b>	<b>Storage, Transport, Installation Altitude .....</b>	<b>23</b>
<b>8</b>	<b>Dimensions .....</b>	<b>23</b>

8.1	Stator .....	23
8.1.1	PS01-37Sx60-HP-B02-SSCP-R / PS01-37Sx60-HP-B03-SSCP-R .....	23
8.1.2	PS01-37Sx60-HP-B02-SSCP-Rn150 .....	24
8.1.3	PS01-37Sx120F-HP-B02-SSCP-R / PS01-37Sx120F-HP-B03-SSCP-R.....	24
8.1.4	PS01-37Sx120F-HP-B02-SSCP-Rn150 .....	25
8.2	Slider .....	25
8.2.1	Slider HP / Heavy Duty HP / HCR .....	25
8.2.2	Hollow Slider HP .....	26
9	<b>International Certificates .....</b>	<b>28</b>
10	<b>EU Declaration of Conformity CE-Marking .....</b>	<b>34</b>
11	<b>UK Declaration of Conformity UKCA-Marking.....</b>	<b>35</b>

# 1 General information

## 1.1 Introduction

This manual includes instructions for the assembly, installation, maintenance, transport, and storage of linear motors. The document is intended for electricians, mechanics, service technicians, and warehouse staff. Be sure to observe the general safety instructions as well as those in each chapter at all times. Keep this manual accessible to the assigned staff.

## 1.2 Explanation of symbols



Triangular warning symbols warn against a danger.



Round command symbols tell what to do.

## 1.3 Qualified personnel

All work such as transport, installation, commissioning and service is only allowed to be carried out by qualified personnel. Qualified personnel in the sense of the safety instructions in this documentation are persons who are familiar with the transport, installation, assembly, commissioning and operation of the product and who have the appropriate qualifications.

This manual must be read carefully before transport, installation, commissioning, service and all safety-related information must be adhered to.

## 1.4 Liability

NTI AG (as manufacturer of LinMot linear motors and MagSpring products) excludes all liability for damages and expenses caused by incorrect use of the products. This also applies to false applications, which are caused by NTI AG's own data and notes, for example in the course of sales, support or application activities. It is the sole responsibility of the user to check the information and information provided by NTI AG regarding their safety-relevant correctness. In addition, the entire responsibility for safety-related product functionality lies exclusively with the user. Product warranties are void if products are used with stators, sliders, servo drives or cables not manufactured by NTI AG unless such use was specifically approved by NTI AG. NTI AG's warranty is limited to repair or replacement as stated in our standard warranty policy as described in our "terms and conditions" previously supplied to the purchaser of our equipment (please request copy of same if not otherwise available). Further reference is made to our general terms and conditions.

## 1.5 Copyright

This work is protected by copyright.

Under the copyright laws, this publication may not be reproduced or transmitted in any form, electronic or mechanical, including photocopying, recording, microfilm, storing in an information retrieval system, not even for training purposes, or translating, in whole or in part, without the prior written consent of NTI AG.

LinMot® is a registered trademark of NTI AG.

## 2 Safety instructions



### Contusions

Sliders contain neodymium magnets and have a strong attractive force. Careless handling could cause fingers or skin to become pinched between two sliders. This may lead to contusions, bruises, and bone fractures. When handling sliders, wear thick protective gloves and keep a minimum distance between sliders. Refer to the "Minimum distance from slider" section for minimum distance.

To reduce the risk of injury, never more than one slider should be held or transported by the same person without packaging.



### Pacemaker / Implanted heart defibrillator

Sliders could affect the functioning of pacemakers and implanted heart defibrillators. For the duration of a strong approach to a magnetic field, these devices switch into test mode and will not function properly.

- If you wear one of those devices keep the following minimum distances between the pacemaker / defibrillator and slider:
  - Min. 250 mm (10") for slider Ø 27 mm and 28 mm (PL01-27 / 28 / PL10-28)
  - Min. 150 mm (6") for slider Ø 19 mm and 20 mm (PL01-19 / 20)
  - Min. 100 mm (4") for slider Ø 12 mm (PL01-12)
- Inform others who wear these devices to comply with these minimum distances!



### Caution - Risk of Electric Shock !

Before working, make sure that there are no high voltages.



### Fast-moving machine parts

The sliders of LinMot linear motors are fast-moving machine parts. All necessary precautions must be taken to prevent persons approaching the moving elements during operation (provide covers, guards, etc.).



### Automatic restart

The motors can start automatically under certain circumstances! If necessary, a corresponding warning symbol must be provided and protection against entering the hazardous area or a suitable safe electronic disconnection must be provided!



### Risk of injury due to a defect or fault

For areas where a defect or fault can result in substantial property damage or even serious personal injury, additional external precautions must be taken or devices must be installed to ensure safe operation even if a defect or fault occurs (eg. suitable safe electronic disconnection, mechanical interlocks, barriers, etc.).



### Magnetic field

Magnets integrated in the sliders produce a strong magnetic field. They could damage TVs, laptops, computer hard drives, credit and ATM cards, data storage media, mechanical watches, hearing aids, and speakers.

- Keep magnets away from devices and objects that could be damaged by strong magnetic fields.
- For the above mentioned objects, keep a minimum distance as described in the "Pacemaker / implanted defibrillator" section.
- For non-anti-magnetic watches, keep the double minimum distance.

**Combustibility**

When machining magnets, the drilling dust could easily ignite. Machining the sliders and the magnets they contain is not permitted.

**Burn hazard**

The sliders of LinMot motors can reach temperatures of 80 °C, which may cause burns upon contact.

**Grounding**

All metal parts that are exposed to contact during any user operation or servicing and likely to become energized shall be reliably connected to the means for grounding.

**Mechanical handling**

Neodymium magnets are brittle and heat-sensitive. Machining the sliders and the magnets they contain is not permitted.

- Colliding magnets could crack. Sharp splinters could be catapulted for several meters and cause eye injury.
- By machining the sliders, heat would result which demagnetises the magnets.

**Slider**

Linear motor sliders consist of a high-precision, thin-walled stainless steel tube in which the neodymium magnets are housed. The LinMot sliders should be handled with care. Avoid contact with other sliders or iron parts as this can damage the magnets and the slider surface. Do not grip the sliders with pliers, as this can also damage the surface. Do not use sliders which are already damaged on the surface (scratches, deformation, etc.). This can cause further damage to the stator.

**Effects on people**

According to the current level of knowledge, magnetic fields of permanent magnets do not have a measurable positive or negative effect on people. It is unlikely that permanent magnets constitute a health risk, but it cannot be ruled out entirely.

- For your own safety, avoid constant contact with magnets.
- Store large magnets at least one meter away from your body.

**Temperature resistance**

Keep slider away from unshielded flame or heat. Temperature above 120°C will cause demagnetization.

### 3 Installation Instructions

#### 3.1 Operating Conditions



Maximum ambient temperature limits:

- 0 °C<sup>1)</sup>...80 °C

Internal temperature sensor error occurs at:

- 120 °C

<sup>1)</sup> Lower temperatures on request.

#### 3.2 Assembly of the Linear Motor



Please attend to the safety instructions in chapter 2 during the assembling!

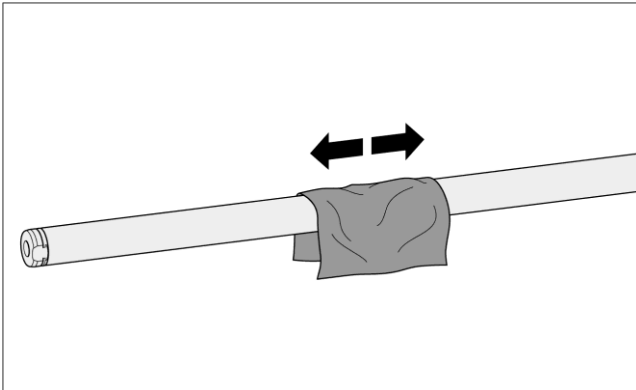

1. Clean the slider with a paper towel.

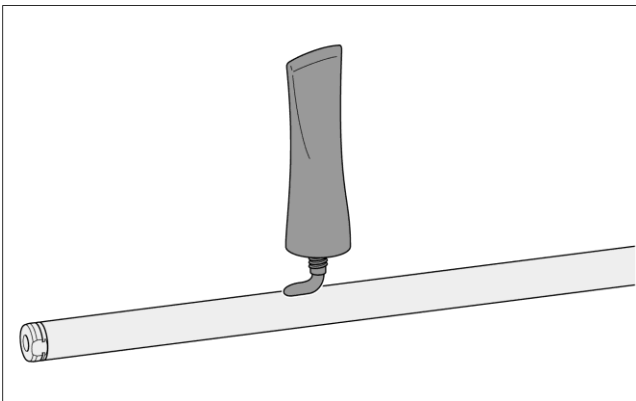

2. Lubricate the slider.

Sliders with a length of more than 500 mm are lubricated with a grease quantity of 4 g (approx. ½ hazelnut) per meter. Shorter sliders are inserted without lubrication.

The grease can be applied by hand or with a soft paper towel.



Always observe the specified grease quantity. Over lubrication leads to a gumming of the grease, which appears particularly at higher operating temperatures!

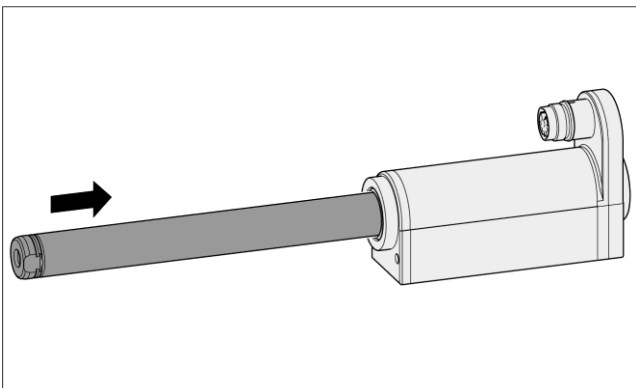

3. Insert the slider in the defined direction (see next assembly step).



Large magnetic attraction forces (Observe warning notice from page 5)! If necessary, cover obvious iron constructions with non-magnetic material (e.g. wood).

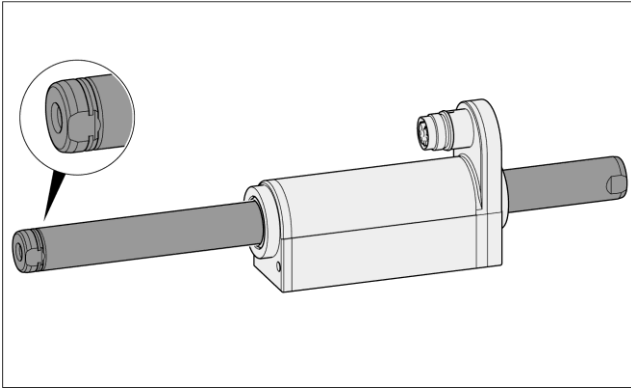

- 4. Checking the installed direction of slider**  
After the installation, the front end of the slider is located at the opposite side of the stator from the cable connector or cable exit.

### 3.3 Mounting the Stator

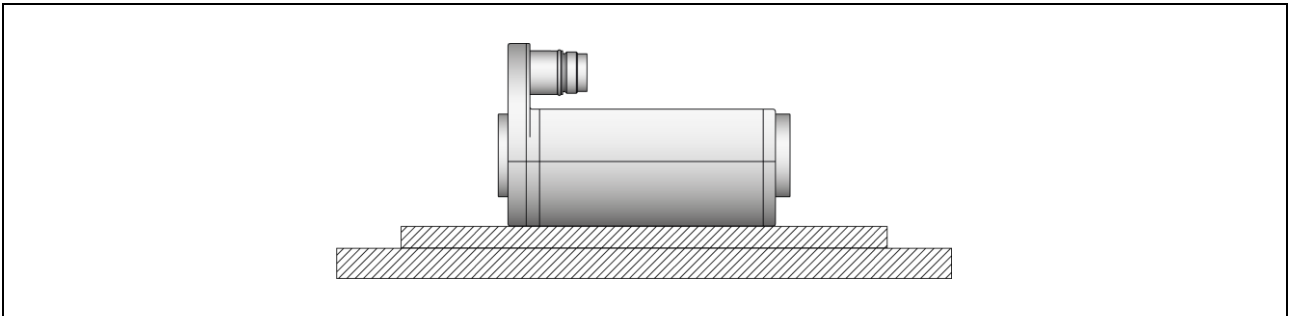

The motor is aligned flat and screwed to the base using the threaded holes on the underside of the motor. The positions of the threaded holes are shown in section 8 «Dimensions».



Max. tightening torque must be observed.

Thread	Max. torque for screw
M5	3.5 Nm

### 3.4 Mounting the Payload to the Slider

The load is mounted as a fixed bearing using spherical washers and conical seats (see the section «Slider mounting kits»).



To avoid shear force on slider and wear on stator, the payload has to be beared by a linear guide.

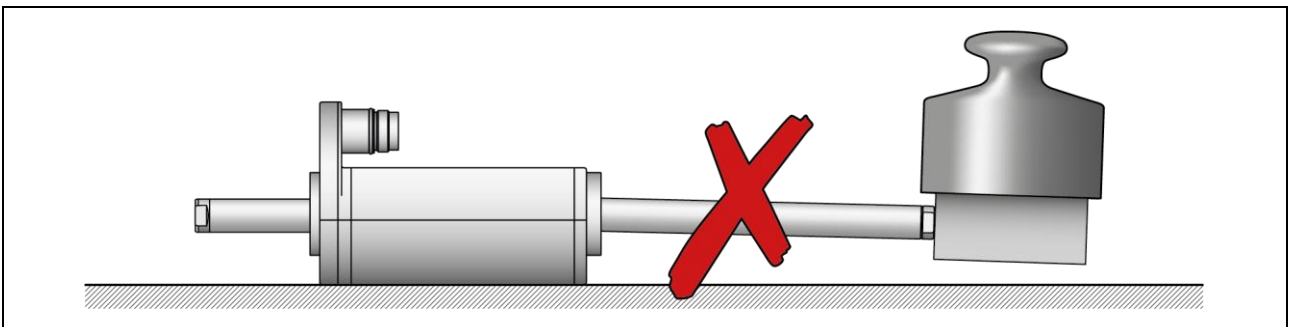



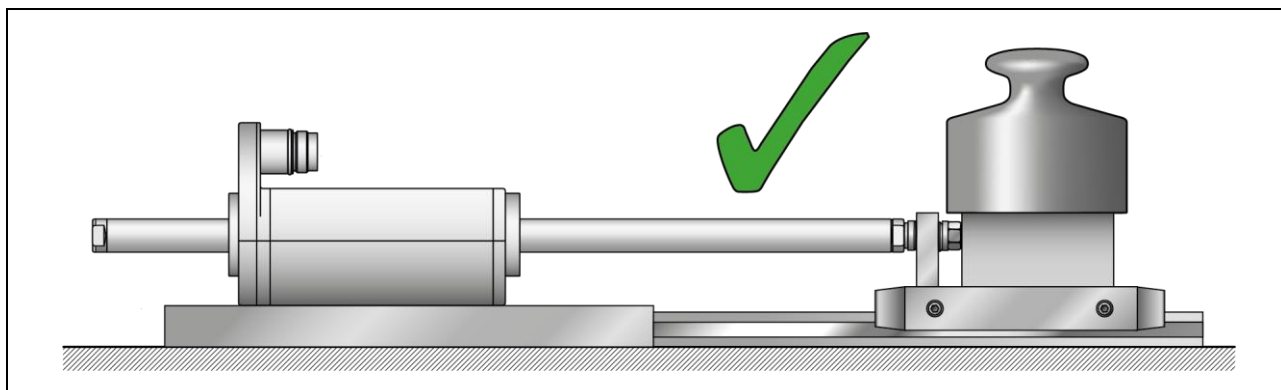

When attaching the load, the wrench for tightening the load must be used only on the load-facing side of the slider. Avoid torsional stress on slider (note the following figures).

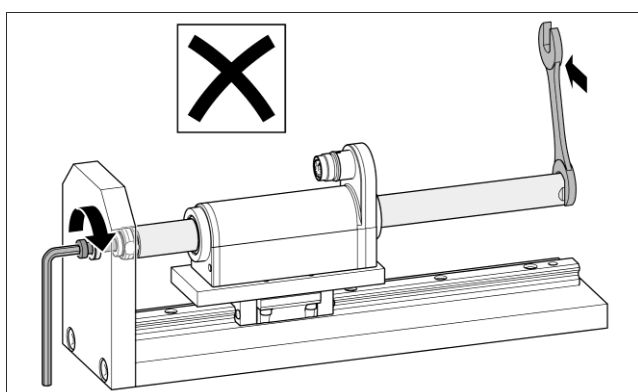

#### Incorrect Mounting

Torsional stress on slider!

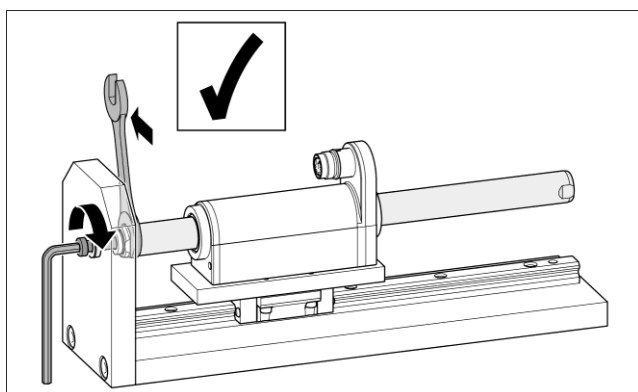

#### Correct Mounting

Slider	Thread	Max. torque for screw (Stainless steel A4)
20 mm	M8	16 Nm

### 3.5 "Moving Slider" Installation

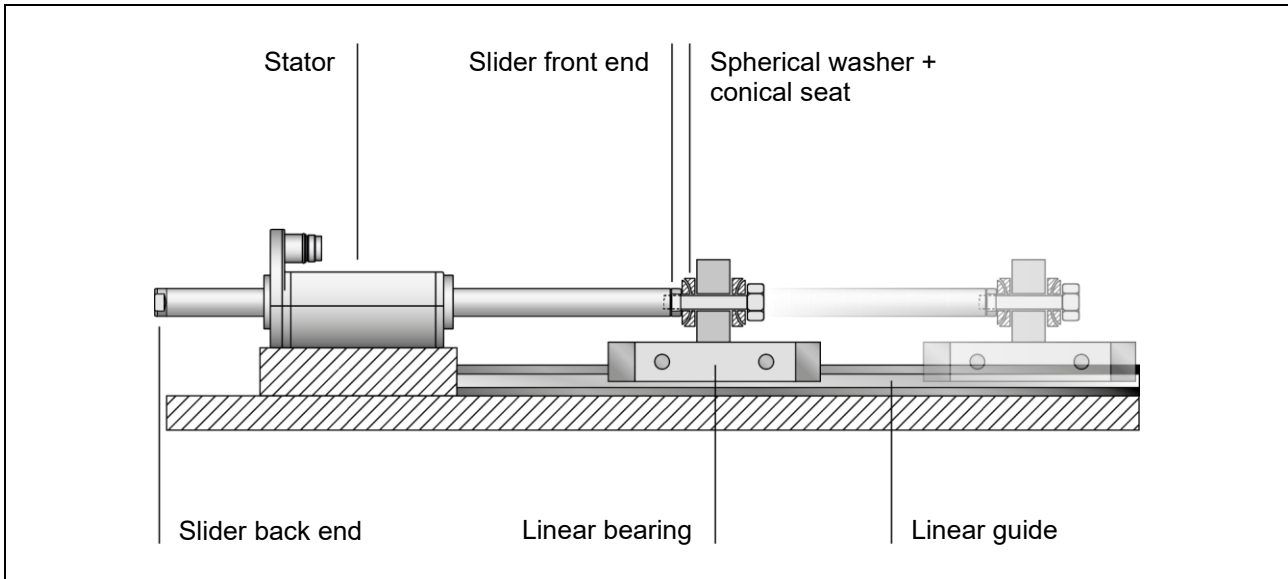

In a "moving slider" installation, the stator is fixed and the slider is the moving part. The load, borne by a linear guide, is attached directly to the end of the slider. In order to compensate for misalignment, spherical axial bearings consisting of spherical washers and conical seats (see the section Slider mounting kits) are used to connect to the load. The mounting kit of slider and an oversized hole for the screw make it possible to adjust a radial and angle offset.

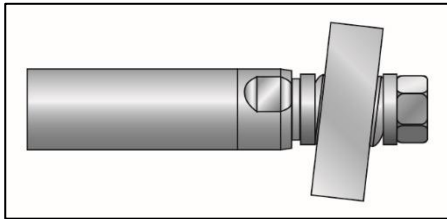

Mounted payload with radial and angle offset.

### 3.6 "Moving Stator" Installation

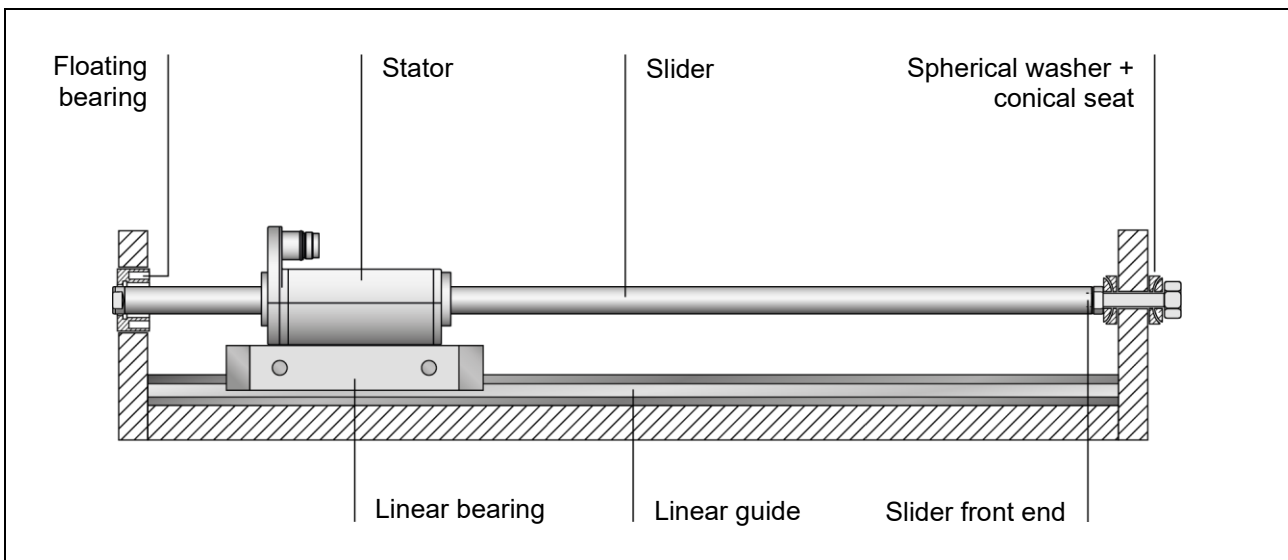

In "moving stator" applications, the slider is fixed and the stator is the moving part. The load is attached to the stator, which is mounted on a linear guide. In order to avoid an overconstrained bearing mount and compensate for alignment errors, the slider may be mounted on one end in a fixed bearing with a spherical axial bearing. On the opposite end, the slider is mounted in a floating bearing. Mounting kits are available for mounting the slider (see the section Slider mounting kits).

### 3.6.1 Assembling Instruction



Please attend to the safety instructions in chapter 2 during the assembling!



If moving stator application is used, the minimum bending radius of the motor cable should be adhered to. See chapter "Motor cable", section Technical data.

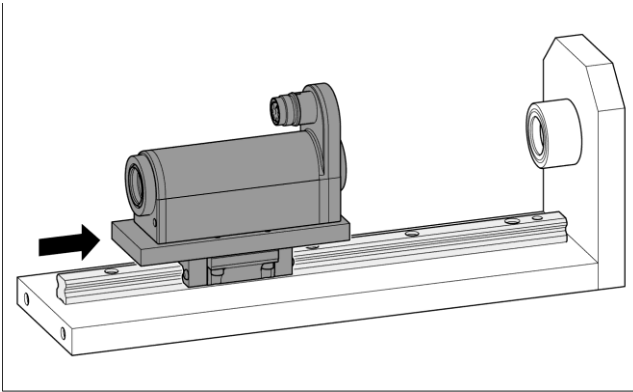

#### 1. Mount stator to its support bearing.

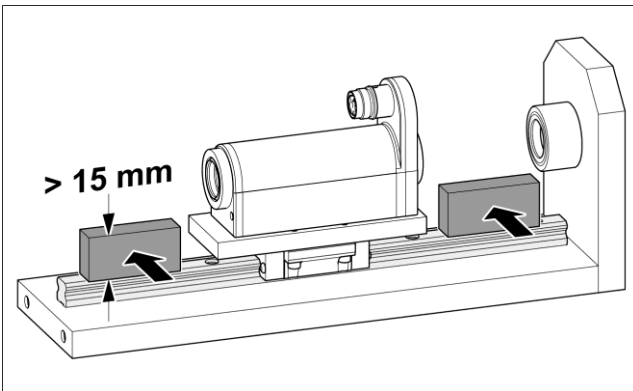

#### 2. Placing a spacer.



Put a spacer (wood, plastic, aluminium with thickness 15 mm) between slider and linear guide. The spacer prevents injuries to the hands and damage to the slider surface!

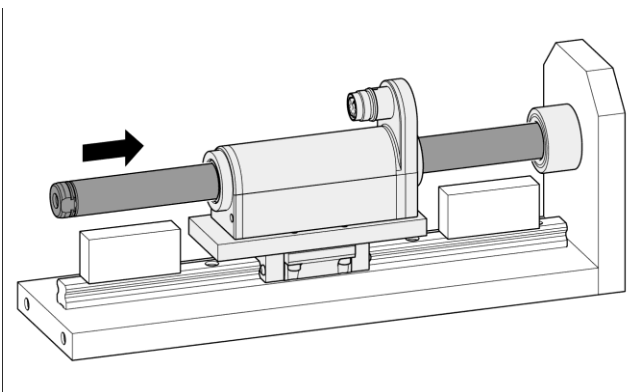

#### 3. Insert slider into stator.

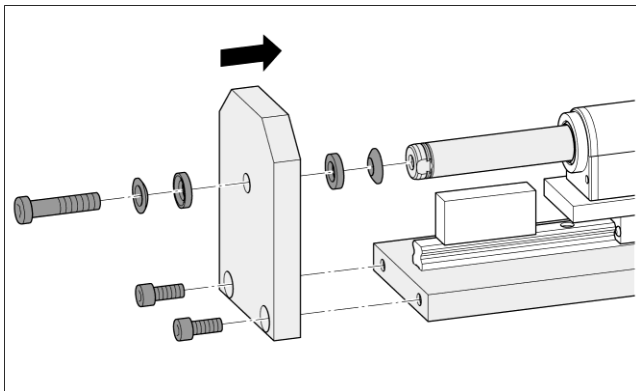

- 4. Installing the slider using the fixed bearing**  
The fixed bearing is screwed to the front end of the slider.



Do not tighten the screw yet!

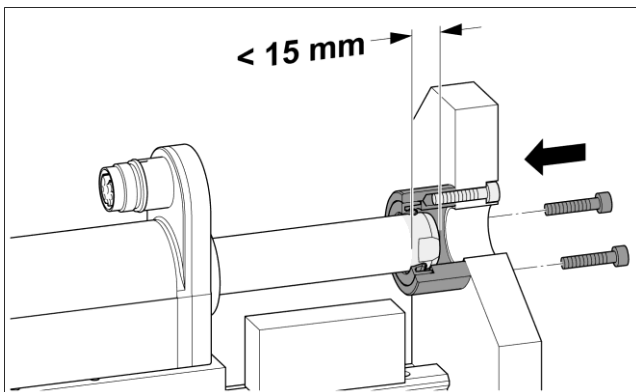

- 5. Mount floating bearing**



Do not tighten the screw!  
The slider is allowed to extend into the floating bearing no more than 15 mm!

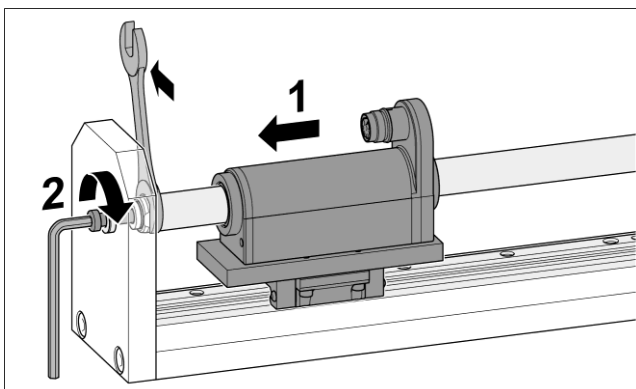

- 6. Move stator (back end) to the fixed end of slider, center slider in stator and tighten the screw.**

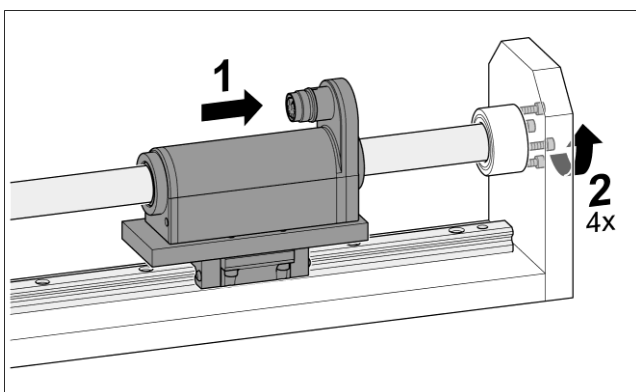

- 7. Move stator (front side) to the floating bearing and tighten screws.**



After the installation of the slider a safety label must be placed close to the slider.

### 3.7 Minimum Distance from Slider

#### 3.7.1 Minimum Distance from Slider to Slider

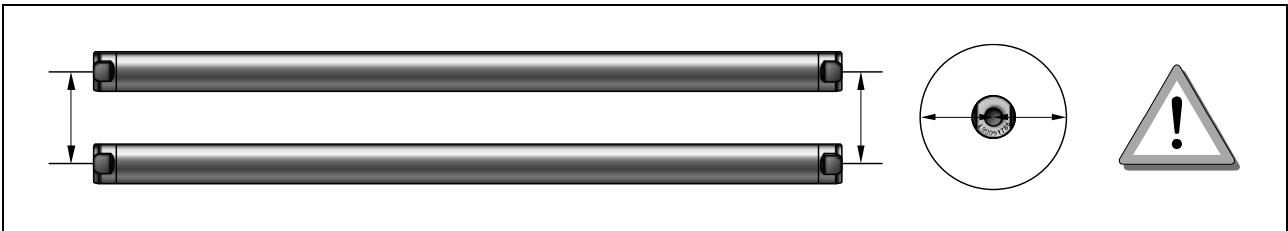

The sliders are made of neodymium magnets and have a strong magnetic attraction. It must be kept a minimum distance between the sliders. This minimized the risk of bruising and secondly, the sliders do not influence each other through their magnetic fields.

Type of slider	PL01	PL01-20 / PL01-19	PL01-28 / PL01-27	PL10-28
PL01-12	30 mm (1.18 in)			
PL01-20 / PL01-19		50 mm (1.97 in)		
PL01-28 / PL01-27			80 mm (3.15 in)	
PL10-28				70 mm (2.76 in)

*The data are measured from slider center to slider center.*

#### 3.7.2 Minimum Distance from Slider to metallic Parts

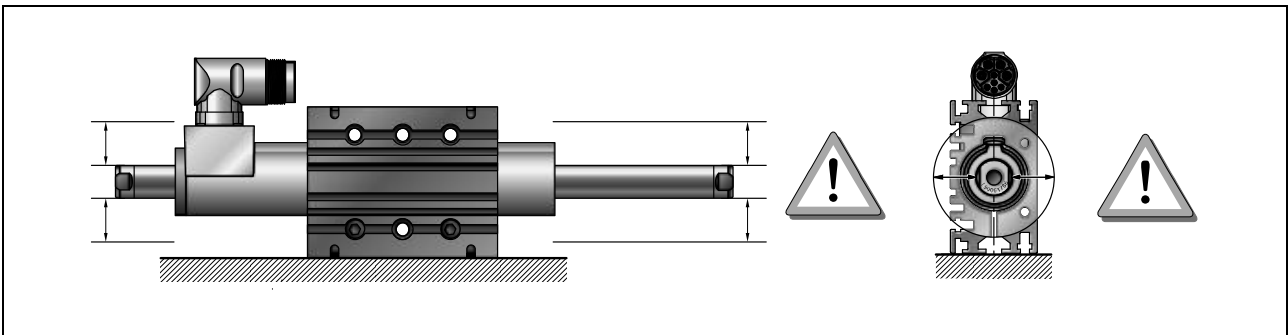

When installing linear motors in modules with metal parts near the slider, undesired forces can arise due to magnetic attraction or eddy currents. These generally manifest as erratic and jerky positioning, or reduced dynamics of the linear motor. In order to avoid this, minimum distances between the slider and any metal parts are to be observed whenever metal materials are used nearby.

Linear Motor	Minimum distance from slider surface to ferromagnetic parts (iron, steel, etc.)	Minimum distance from slider surface to non-ferromagnetic metallic parts (aluminum, bronze, stainless steel, etc.)
P10-70x...	20 mm	10 mm

## 4 Electrical Connection

### 4.1 Motor Cable



Do not connect or disconnect motor when there is power on the servo drive.  
Use only double-shielded original LinMot cable. Cables from other sources must be checked precisely before commissioning.  
Incorrect connections can destroy the drive and stator.



The stator is connected to protective earth via the motor cable. The screw connections of R connector must be tightened up to the stop.  
Three types of cables are available for linear motors. The standard motor cable is intended for stationary installation. The High-Flex cable (suitable for trailing chains) and the robot cable are used for moving cable applications.

#### 4.1.1 Technical Data of the Stator Cable

	PS01-37Sx60-HP-B02-SSCP-Rn150 PS01-37Sx120F-HP-B02-SSCP-Rn150
Cable name	KS05-09
Cable length	1500 mm
Minimum bending radius for fixed installation	25 mm (0.98 in)
Minimum bending radius when moving	Not suitable for applications with moving motor cable.
Approval	UL / CSA 300V
Material wire insulation	TPE-E
Material cable sheath	PUR
Permissible temperature	-40 °C...+80 °C
Oil resistance	very good acc. DIN VDE 0282 Part 10 + HD 22.10
Chemical resistance (to acids, alkalis, solvents, hydraulic fluid)	good

#### 4.1.2 Cable Type Stators

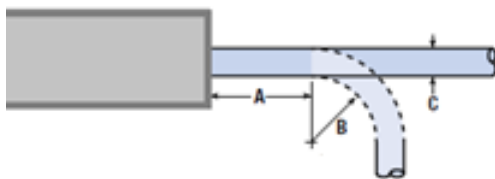

A= 20 mm  
B= 25 mm (Min. Bending radius)  
C= 7.6 mm (Cable-Ø)



The stator cable must not be laid in a freely movable manner. The cable must be laid firmly, observing minimum bending radius for fixed installation (see chapter 4.1.1). If free movement of the cable is desired, an extension cable should be provided.

Max. tensile force 10 N of the stator cable!

**4.1.3 Technical Data**

	Standard cable	High-Flex cable	Robot cable
Cable name	K05-04/05	KS05-04/05	KR05-04/05
Minimum bending radius for fixed installation	25 mm (1 in)	30 mm (1.2 in)	40 mm (1.6 in)
Minimum bending radius when moving	Not suitable for applications with moving motor cable	60 mm (2.4 in) No torsion	80 mm (3.2 in) Max. Torsion: ±270° pro 0.5 m
Approval	UL / CSA 300V	UL / CSA 300V	UL / CSA 300V
Material wire insulation	TPE-U	TPE-E	TPE-E
Material cable sheath	PUR	PUR	PUR
Oil resistance	very good acc. DIN VDE 0282 Part 10 + HD 22.10	very good acc. DIN VDE 0282 Part 10 + HD 22.10	very good acc. DIN VDE 0282 Part 10 + HD 22.10
Chemical resistance (to acids, alkalis, solvents, hydraulic fluid)	good	good	good

**4.2 Connectors**

Depending on the choice of stator, 2 different types of motor connectors or cable connectors are available. The cable type stator (Type ...Rn150) has a motor connector with protection class IP 67. All cable connectors with this protection class are suitable for this. All cable connectors with protection class IP 69k are suitable for the connector type stator (welded-on connector). Motor connector and cable connector are screwed together tightly. Dimensions and tightening torque are shown in the following illustrations.

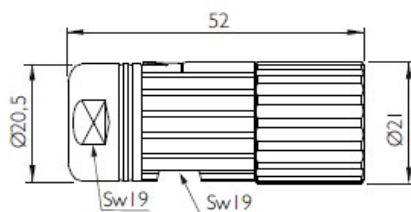
**4.2.1 IP Class IP67****R-Connector**

Material: Nickel-plated  
Max. torque: 0.6 Nm

**Note:** This cable connector is used for assembled standard cables.

**Ordering information**

Item	Description	Item-No.
MC01-R/f	Motor connector R/f	0150-3129

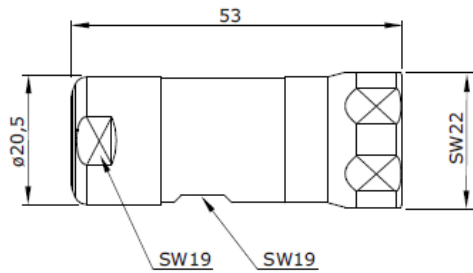
**4.2.2 IP Class IP69k****R-Connector**

Material: Stainless steel (1.4404)

Max. torque: 0.6 Nm

**Note:** This cable connector is used for assembled trailing chain cables and robot cables.**Ordering information**

Item	Description	Item-No.
MC01-R/f-IP69K-SSC	Motor connector R/f, IP69k, SSC	0150-3347

**4.2.3 Pin Assignment Linear Motor**

Do not connect or disconnect motor when there is power on the servo drive.  
Use only double-shielded original LinMot cable. Cables from other sources must be checked precisely before commissioning.  
Incorrect connections can destroy the drive and stator.

Connector Type	R-Connector
	Pin
Phase1+	1
Phase1-	2
Phase2+	3
Phase2-	4
+5V	A
SIGNAL-GROUND*	B
Sensor Sin	C
Sensor Cos	D
Temp sensor	E
SHIELD** of stator and stator cable	Case
Connector on the stator (-cables)	



Extension cables are double shielded. The two shields of the extension cables must not be connected together: the inner shield of the extension cables is used as GROUND and must be connected to SIGNAL-GROUND\*; only the outer shield must be connected to SHIELD\*\* of the connector.



## 5 Accessories

### 5.1 Motor Cables

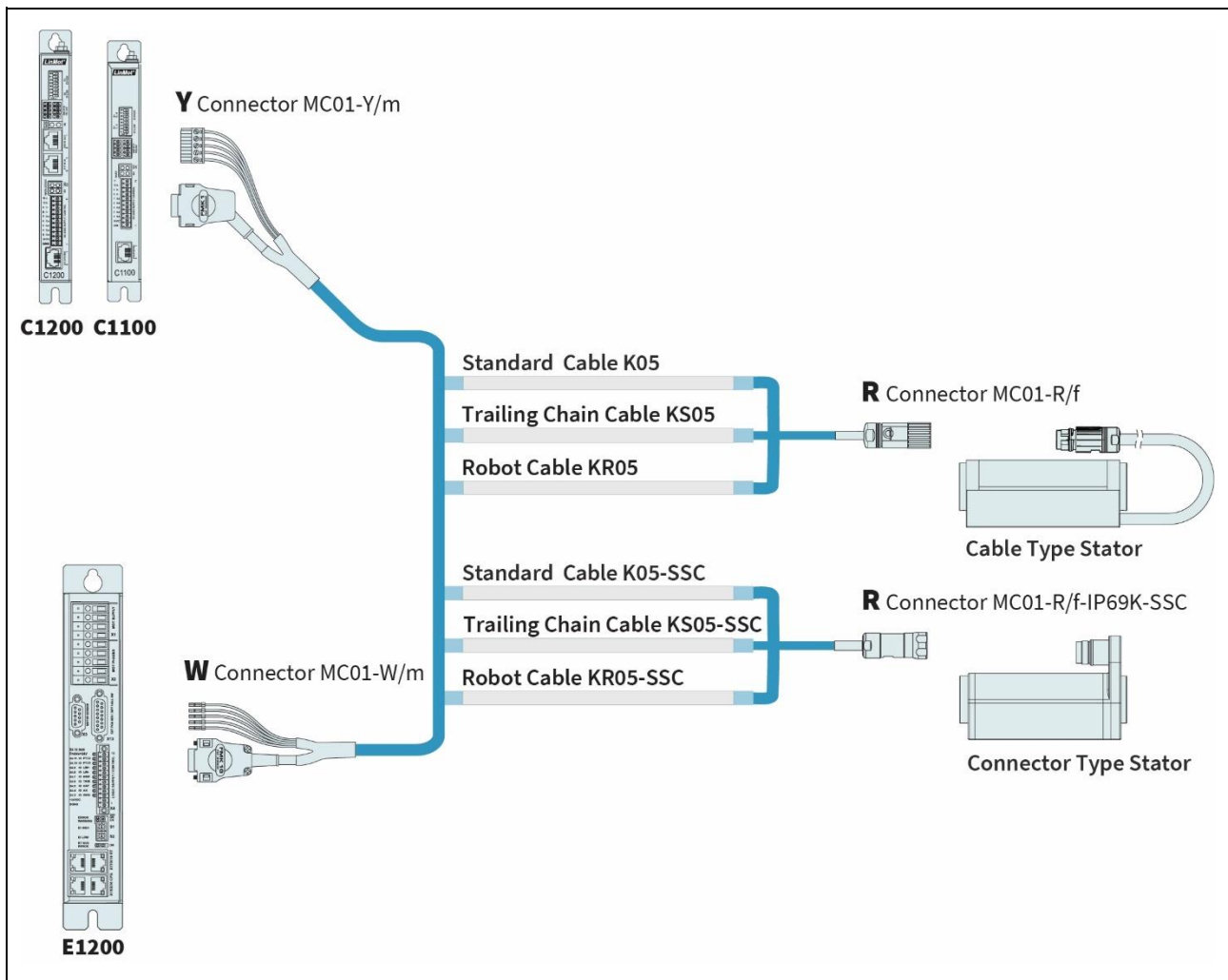

Item	Description	Item-No.
K05-W/R-2	Motor Cable W/R, 2 m	0150-2119
K05-W/R-4	Motor Cable W/R, 4 m	0150-2120
K05-W/R-6	Motor Cable W/R, 6 m	0150-2121
K05-W/R-8	Motor Cable W/R, 8 m	0150-2122
K05-W/R-	Motor Cable W/R, Custom length	0150-3262
K05-Y/R-2	Motor Cable Y/R, 2 m	0150-2421
K05-Y/R-4	Motor Cable Y/R, 4 m	0150-2422

K05-Y/R-6	Motor Cable Y/R, 6 m	0150-2423
K05-Y/R-8	Motor Cable Y/R, 8 m	0150-2424
K05-Y-Fe/R-	Motor Cable Y/R, Custom length	0150-3501
K05-W/R-SSC-	Motor Cable W/R-SSC, Custom length	0150-3586
K05-Y-Fe/R-SSC-	Motor Cable Y-Fe/R-SSC, Custom length	0150-3715

Item	Description	Item-No.
KS05-W/R-4	Trailing Chain Cable W/R, 4 m	0150-2106
KS05-W/R-6	Trailing Chain Cable W/R, 6 m	0150-2131
KS05-W/R-8	Trailing Chain Cable W/R, 8 m	0150-2107
KS05-W/R-	Trailing Chain Cable W/R, Custom length	0150-3256
KS05-Y/R-2	Trailing Chain Cable Y/R, 2 m	0150-4165
KS05-Y/R-4	Trailing Chain Cable Y/R, 4 m	0150-2433
KS05-Y/R-6	Trailing Chain Cable Y/R, 6 m	0150-2434
KS05-Y/R-8	Trailing Chain Cable Y/R, 8 m	0150-2435
KS05-Y-Fe/R-	Trailing Chain Cable Y-Fe/R, Custom length	0150-3507
KS05-W/R-SSC-2	Trailing Chain Cable W/R-SSC, 2 m	0150-2683
KS05-W/R-SSC-4	Trailing Chain Cable W/R-SSC, 4 m	0150-2684
KS05-W/R-SSC-6	Trailing Chain Cable W/R-SSC, 6 m	0150-2685
KS05-W/R-SSC-8	Trailing Chain Cable W/R-SSC, 8 m	0150-2686
KS05-W/R-SSC-	Trailing Chain Cable W/R-SSC, Custom length	0150-3583
KS05-Y/R-SSC-2	Trailing Chain Cable Y/R-SSC, 2 m	0150-2687
KS05-Y/R-SSC-4	Trailing Chain Cable Y/R-SSC, 4 m	0150-2688
KS05-Y/R-SSC-6	Trailing Chain Cable Y/R-SSC, 6 m	0150-2689
KS05-Y/R-SSC-8	Trailing Chain Cable Y/R-SSC, 8 m	0150-2690
KS05-Y-Fe/R-SSC-	Trailing Chain Cable Y-Fe/R-SSC, Custom length	0150-3646

Item	Description	Item-No.
KR05-W/R-	Robot Cable KR05-W/R, Custom length	0150-3336
KR05-Y-Fe/R-	Robot Cable KR05-Y-Fe/R, Custom length	0150-3512
KR05-W/R-SSC-	Robot Cable KR05-W/R-SSC-, Custom length	0150-3587
KR05-Y-Fe/R-SSC-	Robot Cable KR05-Y-Fe/R-SSC-, Custom length	0150-4364

Item	Description	Item-No.
MC01-W/m	Motor Connector W/m	0150-3140
MC01-Y-Fe/m	Motor Connector Y-Fe/m	0150-3289
MC01-R/f	Motor Connector R/f	0150-3129
MC01-R/f-IP69K-SSC	Motor Connector R/f, IP69k, SSC	0150-3347
K05-04/05	Motor Cable per m	0150-1920
KS05-04/05	Trailing Chain Cable per m	0150-1938
KR05-04/05	Robot Cable per m	0150-1846

## 5.2 Bearing Kit



For fast, uncomplicated maintenance, the linear motors P01-37S-HP-SSCP are equipped with replaceable slider bearings. The integrated sliding bearings are easy to replace in a few manual steps. These plastic bearings are specially designed for food processing and allow easy wash-down of the stator and slider. The available bearing set always consists of 2 wiper rings and the front and rear bearing sleeve.

Item	Description	Item-No.
PBS01-37S-B02-SSCP	Spare-Bearing Set for PBS01-37S-B02-SSCP	0150-4189
PBS01-37S-B03-SSCP	Spare-Bearing Set for PBS01-37S-B03-SSCP	0150-4192

### 5.2.1 Mounting

- First remove the old wiper rings and the bearing sleeves.
- The wiper rings can easily be pulled out with pliers. To do this, the bearing sleeves can first be pushed up with a screwdriver and then pulled out with pliers.
- Finally, the new bearing sleeves and the wiper rings can be inserted.



Note that the bearing sleeves are damaged when removed and cannot be reused.

## 5.3 Slider Mounting Kits

### 5.3.1 Fixed Bearing

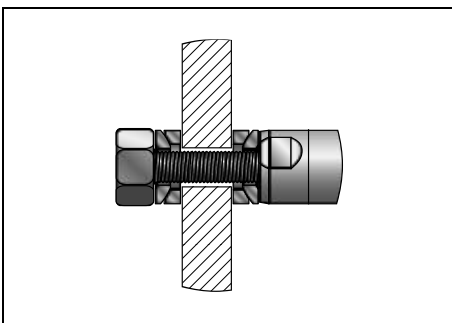

Slider mounting kit consists of a spring washer, a pair of spherical washers, and a pair of conical seats. It allows the slider to be fixed in the direction of motion. It also helps to compensate for radial and angle offset.

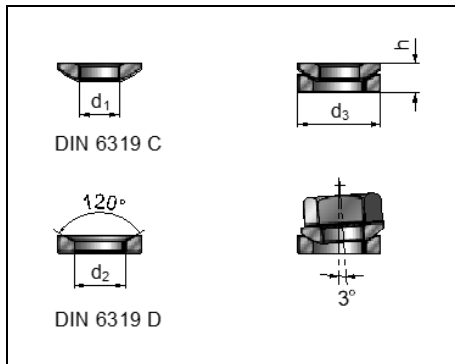

**Material**

Spherical washer / conical seat: case hardened steel

Item	Item No.	Slider	Thread	d1	d2	d3	h
PLF01-20-SS (Stainless steel)	0150-3296	19mm 20mm	M8	8.4mm (0.33in)	9.6mm (0.38in)	17mm (0.67in)	5.5mm (0.22in)

### 5.3.2 Floating Bearing

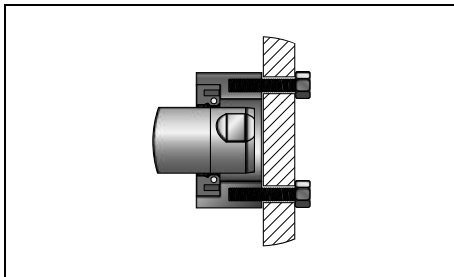

Floating bearing assembly that permits radial adjustment of slider position and permits a small amount of radial and axial movement.

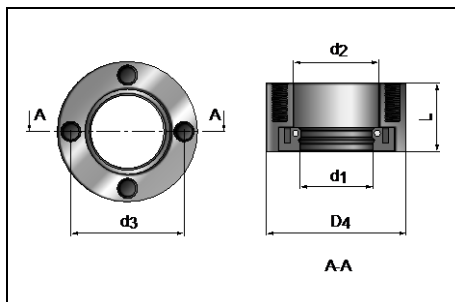

**Material**

Housing:

Stainless steel 1.4305

Bearing:

Nitrile butadiene rubber

Spring steel DIN17223

Item	Item No.	Slider	Thread	d1	d2	d3	D4	L
PLL01-20	0150-3084	20mm	M5	20mm (0.79in)	23mm (0.90in)	30mm (1.18in)	37mm (1.46in)	20mm (0.79in)

## 6 Maintenance and Test Instructions

### 6.1 Stator Checking

The following tables show the resistive value between the different connector pins for each stator type. If the value is not within a range of +/- 10% the stator may be damaged (temperature of the stator for all measurements: 20°C).

#### PS01-37Sx60-HP-B02-SSCP-R (0150-4099)

Phase1+ / Phase1-	Red / Orange	Pin 1 / Pin 2	3.2 $\Omega$
Phase2+ / Phase2-	Blue / Gray	Pin 3 / Pin 4	3.2 $\Omega$
5V / GND	White / Brown	Pin A / Pin B	160 $\Omega$
Sensor Sine / GND	Yellow / Brown	Pin C / Pin B	33 k $\Omega$
Sensor Cosine / GND	Green / Brown	Pin D / Pin B	33 k $\Omega$
Temp. Sensor / GND	Black / Brown	Pin E / Pin B	10 k $\Omega$
Phase / GND	-	Pin 1,2,3,4 / Pin B	>20 M $\Omega$
All Pin / Shield	-	Pin 1-E / Housing	>20 M $\Omega$

#### PS01-37Sx60-HP-B03-SSCP-R (0150-4098)

Phase1+ / Phase1-	Red / Orange	Pin 1 / Pin 2	3.2 $\Omega$
Phase2+ / Phase2-	Blue / Gray	Pin 3 / Pin 4	3.2 $\Omega$
5V / GND	White / Brown	Pin A / Pin B	160 $\Omega$
Sensor Sine / GND	Yellow / Brown	Pin C / Pin B	33 k $\Omega$
Sensor Cosine / GND	Green / Brown	Pin D / Pin B	33 k $\Omega$
Temp. Sensor / GND	Black / Brown	Pin E / Pin B	10 k $\Omega$
Phase / GND	-	Pin 1,2,3,4 / Pin B	>20 M $\Omega$
All Pin / Shield	-	Pin 1-E / Housing	>20 M $\Omega$

#### PS01-37Sx60-HP-B02-SSCP-Rn150 (0150-4613)

Phase1+ / Phase1-	Red / Orange	Pin 1 / Pin 2	3.2 $\Omega$
Phase2+ / Phase2-	Blue / Gray	Pin 3 / Pin 4	3.2 $\Omega$
5V / GND	White / Brown	Pin A / Pin B	160 $\Omega$
Sensor Sine / GND	Yellow / Brown	Pin C / Pin B	33 k $\Omega$
Sensor Cosine / GND	Green / Brown	Pin D / Pin B	33 k $\Omega$
Temp. Sensor / GND	Black / Brown	Pin E / Pin B	10 k $\Omega$
Phase / GND	-	Pin 1,2,3,4 / Pin B	>20 M $\Omega$
All Pin / Shield	-	Pin 1-E / Housing	>20 M $\Omega$

#### PS01-37Sx120F-HP-B02-SSCP-R (0150-4097)

Phase1+ / Phase1-	Red / Orange	Pin 1 / Pin 2	2.6 $\Omega$
Phase2+ / Phase2-	Blue / Gray	Pin 3 / Pin 4	2.6 $\Omega$
5V / GND	White / Brown	Pin A / Pin B	160 $\Omega$
Sensor Sine / GND	Yellow / Brown	Pin C / Pin B	33 k $\Omega$
Sensor Cosine / GND	Green / Brown	Pin D / Pin B	33 k $\Omega$
Temp. Sensor / GND	Black / Brown	Pin E / Pin B	10 k $\Omega$
Phase / GND	-	Pin 1,2,3,4 / Pin B	>20 M $\Omega$
All Pin / Shield	-	Pin 1-E / Housing	>20 M $\Omega$

**PS01-37Sx120F-HP-B03-SSCP-R (0150-4096)**

Phase1+ / Phase1-	Red / Orange	Pin 1 / Pin 2	2.6 $\Omega$
Phase2+ / Phase2-	Blue / Gray	Pin 3 / Pin 4	2.6 $\Omega$
5V / GND	White / Brown	Pin A / Pin B	160 $\Omega$
Sensor Sine / GND	Yellow / Brown	Pin C / Pin B	33 k $\Omega$
Sensor Cosine / GND	Green / Brown	Pin D / Pin B	33 k $\Omega$
Temp. Sensor / GND	Black / Brown	Pin E / Pin B	10 k $\Omega$
Phase / GND	-	Pin 1,2,3,4 / Pin B	>20 M $\Omega$
All Pin / Shield	-	Pin 1-E / Housing	>20 M $\Omega$

**PS01-37Sx120F-HP-B02-SSCP-Rn150 (0150-4342)**

Phase1+ / Phase1-	Red / Orange	Pin 1 / Pin 2	2.6 $\Omega$
Phase2+ / Phase2-	Blue / Gray	Pin 3 / Pin 4	2.6 $\Omega$
5V / GND	White / Brown	Pin A / Pin B	160 $\Omega$
Sensor Sine / GND	Yellow / Brown	Pin C / Pin B	33 k $\Omega$
Sensor Cosine / GND	Green / Brown	Pin D / Pin B	33 k $\Omega$
Temp. Sensor / GND	Black / Brown	Pin E / Pin B	10 k $\Omega$
Phase / GND	-	Pin 1,2,3,4 / Pin B	>20 M $\Omega$
All Pin / Shield	-	Pin 1-E / Housing	>20 M $\Omega$

## 6.2 Maintenance of Linear Motors

The person responsible for the operation of the motors must ensure that the specified maintenance work is carried out. The following maintenance schedule is designed for the operating conditions in the food industry with contact of liquid media. The inspection cycle is 2.5 million movement cycles or 1500 friction-kilometer.

### 6.2.1 Maintenance Schedule

When	What	Task
Every 2.5 million movement cycles or 1500 friction-kilometer	Slider bearing Wiper	Check and, if necessary, replace the bearing sleeves and wiper rings (see section 5.2 «Bearing kit»).
	Slider	Check that the slider surface is clean and not scratched. Scratched sliders must be replaced, otherwise Clean the slider. See the following section.
	Electrical connection	Tighten the electrical connection between cable and stator. Tightening torque: 0.6 Nm (R-Connector)
	Ease of movement	If friction is felt during movement, the motor must be stopped immediately. Check the alignment of the load bearing and slider.

### 6.2.2 Cleaning

- Pull the sliders carefully out of the stator.  
**Attention!:** Strong magnetic attraction forces (note safety instruction “contusions” on page 5.)! Use non-magnetic material (e.g. wood) to cover close-by iron constructions.
- Clean the slider and bearings with a soft disposable paper, using for example acetone or benzene cleaner. Common cleaning agents used in the food industry may also be used. However, these should not leave any residues.
- Then, if the application allows, the slider and the bearings should be lubricated.  
The bearings are each greased with 1 g grease LU02. There should only be a light layer of grease on the inside. **Note!:** Avoid overlubrication!  
Finally, grease the slider according to paragraph 3.2 "Assembly of the linear motor".

### 6.2.3 Cleaning Agents / Lubricants

All LinMot stainless steel motors have a protection class of IP69. Standard cleaning agents in food and pharmaceutical industries with usual concentration and amount, can be used for the cleaning. If necessary, the compatibility with the bearing material (PEEK / PPS), the wiper material (NBR FDA) and the cable sheath material (PUR) must be checked.

#### Ordering information

Item	Description	Item-No.
LU02-08	Lubricant for linear motors * (8 g)	0150-1953
LU02-50	Lubricant for linear motors * (50 g)	0150-1954
LU02-1000	Lubricant for linear motors * (1000 g)	0150-1955

*\* LinMot LU02 Lubricant corresponds to KLÜBERSYNTH UH1 14-31 which was developed for the food processing industry.*

## 7 Storage, Transport, Installation Altitude

- Sliders are to be stored and transported only in the plastic containers (with cardboard inlay) provided for this purpose, or already installed and secured in LinMot P stators.
- Remove the slider from this plastic containers only for assembling.
- The storage area must be dry, dust-free, frost-free and vibration-free.
- Prescribed storage temperature: -15 °C...70 °C
- The motor must be protected against extreme weather conditions.
- The air in the storage area must not contain any harmful gases.
- The max. installation altitude is 4'000 m above sea level.  
Beyond 1'000 m, a derating of 0.5% per 100 m must be taken into account on the rated force in the case of air cooling.

## 8 Dimensions

### 8.1 Stator

#### 8.1.1 PS01-37Sx60-HP-B02-SSCP-R / PS01-37Sx60-HP-B03-SSCP-R

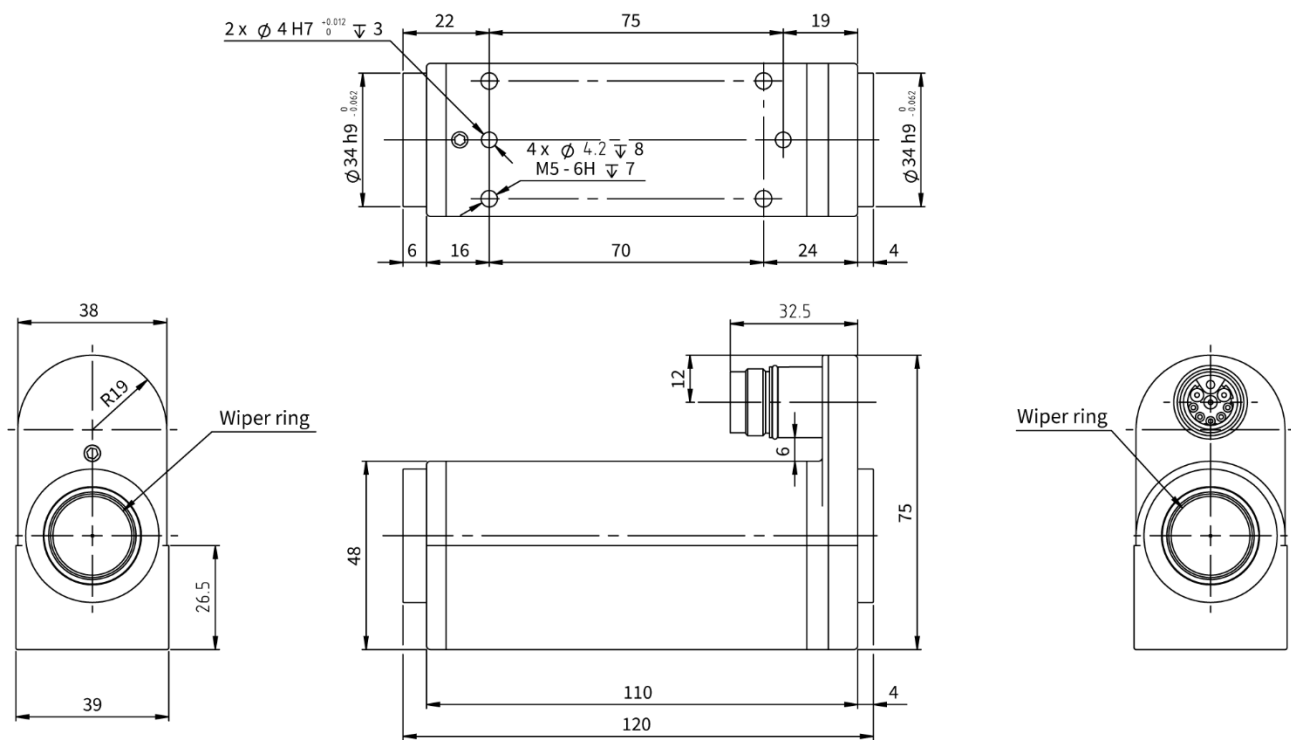

in mm

### 8.1.2 PS01-37Sx60-HP-B02-SSCP-Rn150

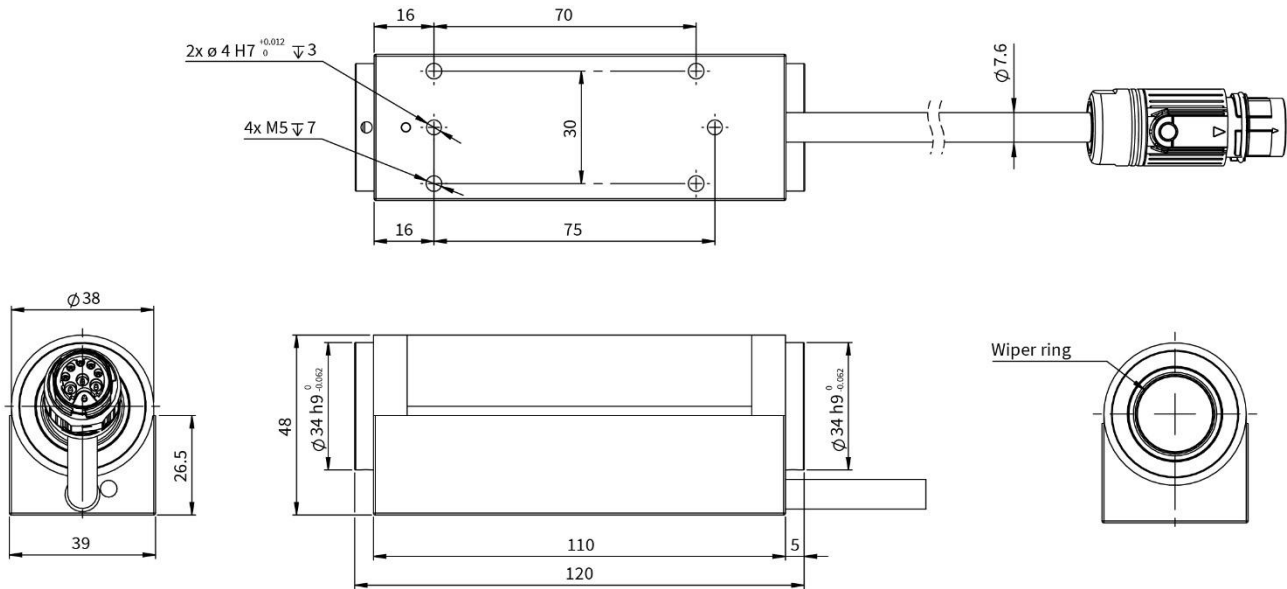

in mm

### 8.1.3 PS01-37Sx120F-HP-B02-SSCP-R / PS01-37Sx120F-HP-B03-SSCP-R

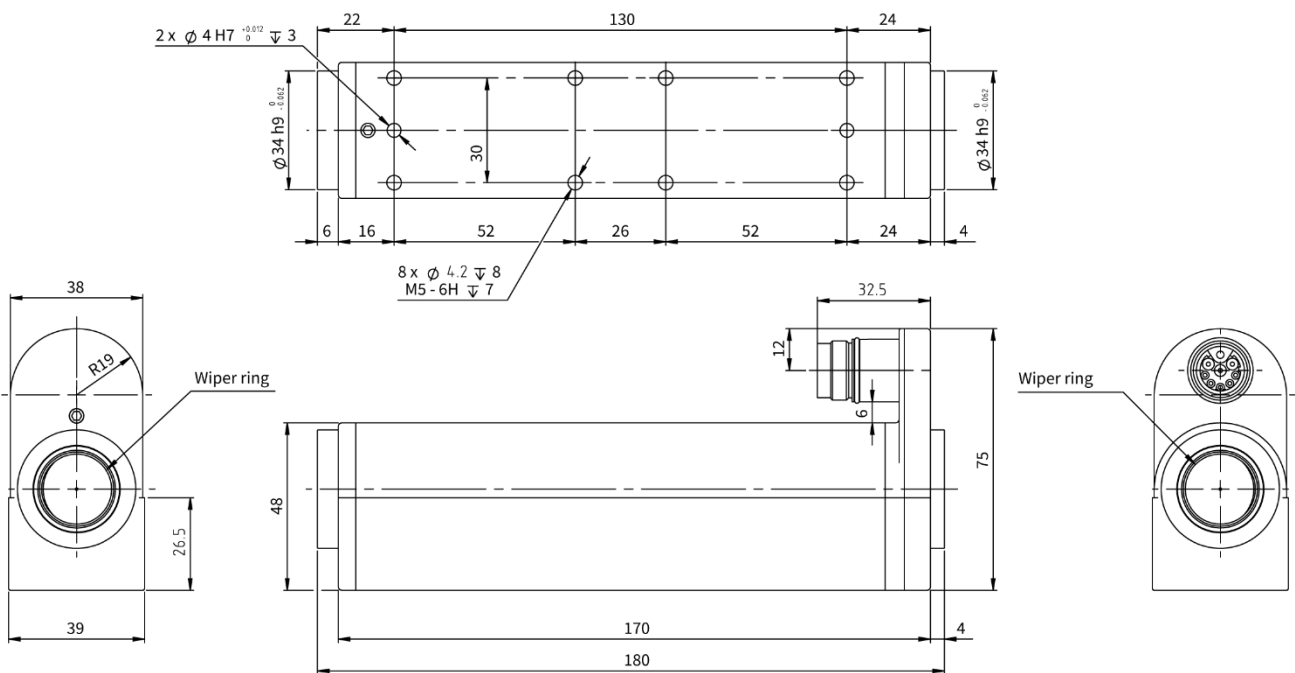

in mm

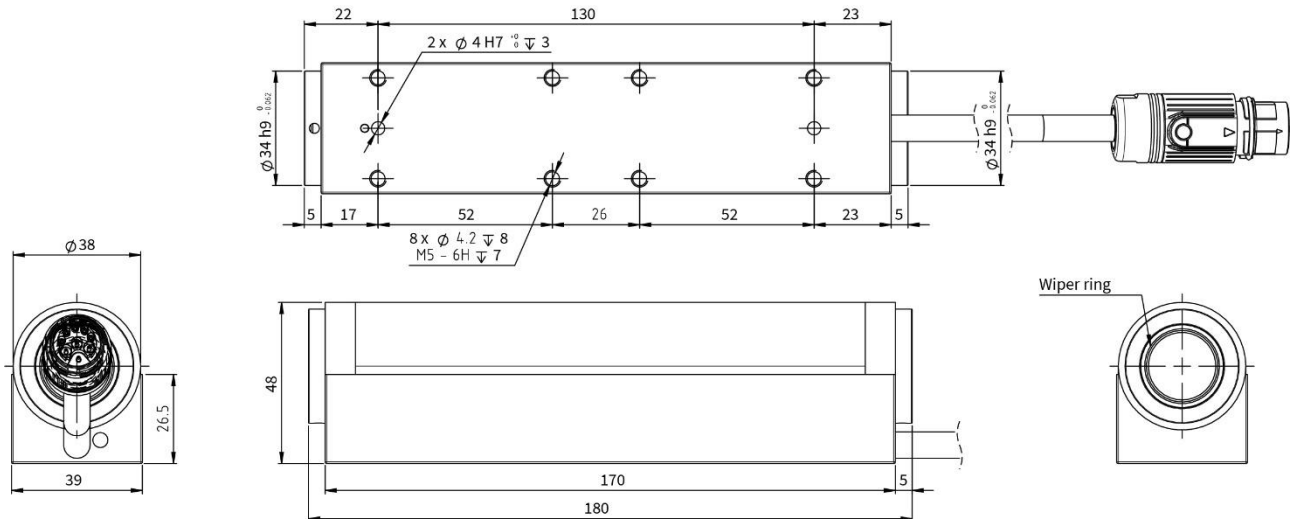

**8.1.4 PS01-37Sx120F-HP-B02-SSCP-Rn150**

in mm

**8.2 Slider**

For normal applications in both dry and wet environments the standard sliders of the PL01 series are sufficient. Their slider tube is made of an austenitic, acid-resistant 18/10 chrome-nickel steel, material no. 1.4301 (AISI 304). The heavy duty sliders PL02 are additionally coated with tungsten carbide (WC/C), have better emergency running properties and are superior to standard sliders in terms of service life in abrasive environments. Sliders of the HCR series ("high corrosion resistant") are made of stainless steel 1.4404 - chrome-nickel-molybdenum (AISI 316L). Their use is particularly recommended in environments with a high chloride content at temperatures above 60°C.

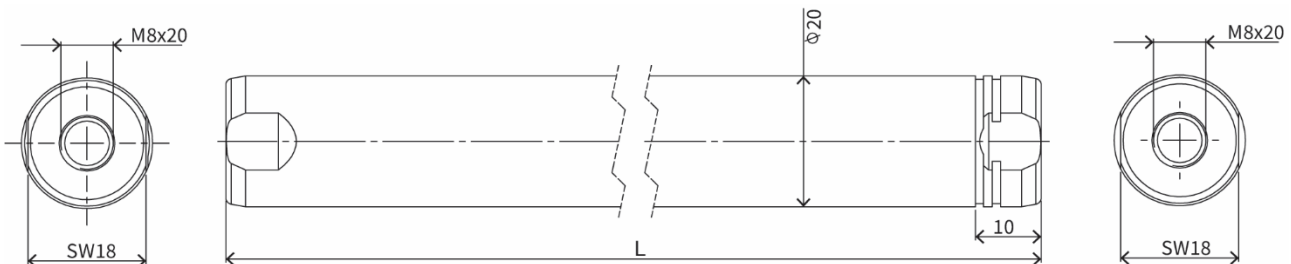
**8.2.1 Slider HP / Heavy Duty HP / HCR**

Item	Description	Item-No.	Length L [mm]
PL01-20x160/100-HP	Slider 'High Performance'	0150-2513	160
PL01-20x200/140-HP	Slider 'High Performance'	0150-2512	200
PL01-20x240/180-HP	Slider 'High Performance'	0150-1505	240
PL01-20x300/240-HP	Slider 'High Performance'	0150-1506	300
PL01-20x360/300-HP	Slider 'High Performance'	0150-1507	360
PL01-20x400/340-HP	Slider 'High Performance'	0150-1508	400
PL01-20x500/440-HP	Slider 'High Performance'	0150-1509	500
PL01-20x600/540-HP	Slider 'High Performance'	0150-1510	600
PL01-20x700/640-HP	Slider 'High Performance'	0150-1511	700
PL01-20x800/740-HP	Slider 'High Performance'	0150-1512	800
PL01-20x900/840-HP	Slider 'High Performance'	0150-1513	900
PL01-20x1000/940-HP	Slider 'High Performance'	0150-1514	1000
PL01-20x1200/1140-HP	Slider 'High Performance'	0150-1515	1200
PL01-20x1400/1340-HP	Slider 'High Performance'	0150-1516	1400

PL01-20x1600/1540-HP	Slider 'High Performance'	0150-1517	1600
----------------------	---------------------------	-----------	------

Item	Description	Item-No.	Length L [mm]
PL02-20x160/100-HP	Slider 'heavy duty' 'High Performance'	on request	160
PL02-20x200/140-HP	Slider 'heavy duty' 'High Performance'	on request	200
PL02-20x240/180-HP	Slider 'heavy duty' 'High Performance'	0150-2162	240
PL02-20x300/240-HP	Slider 'heavy duty' 'High Performance'	0150-2163	300
PL02-20x360/300-HP	Slider 'heavy duty' 'High Performance'	0150-2164	360
PL02-20x400/340-HP	Slider 'heavy duty' 'High Performance'	0150-2165	400
PL02-20x500/440-HP	Slider 'heavy duty' 'High Performance'	0150-2166	500
PL02-20x600/540-HP	Slider 'heavy duty' 'High Performance'	0150-2167	600
PL02-20x700/640-HP	Slider 'heavy duty' 'High Performance'	0150-2168	700
PL02-20x800/740-HP	Slider 'heavy duty' 'High Performance'	0150-2169	800
PL02-20x900/840-HP	Slider 'heavy duty' 'High Performance'	0150-2170	900

Item	Description	Item-No.	Length L [mm]
PL01-20x160/100-HP-W01	Slider 'High Performance' HCR	0150-4552	160
PL01-20x200/140-HP-W01	Slider 'High Performance' HCR	0150-4557	200
PL01-20x240/180-HP-W01	Slider 'High Performance' HCR	0150-4258	240
PL01-20x300/240-HP-W01	Slider 'High Performance' HCR	0150-4274	300
PL01-20x360/300-HP-W01	Slider 'High Performance' HCR	0150-4275	360
PL01-20x400/340-HP-W01	Slider 'High Performance' HCR	0150-4276	400
PL01-20x500/440-HP-W01	Slider 'High Performance' HCR	0150-4277	500
PL01-20x600/540-HP-W01	Slider 'High Performance' HCR	0150-4278	600
PL01-20x700/640-HP-W01	Slider 'High Performance' HCR	0150-4279	700
PL01-20x800/740-HP-W01	Slider 'High Performance' HCR	0150-4280	800
PL01-20x900/840-HP-W01	Slider 'High Performance' HCR	0150-4281	900
PL01-20x1000/940-HP-W01	Slider 'High Performance' HCR	0150-4282	1000
PL01-20x1200/1140-HP-W01	Slider 'High Performance' HCR	0150-4283	1200
PL01-20x1400/1340-HP-W01	Slider 'High Performance' HCR	0150-4284	1400
PL01-20x1600/1540-HP-W01	Slider 'High Performance' HCR	0150-4285	1600

### 8.2.2 Hollow Slider HP

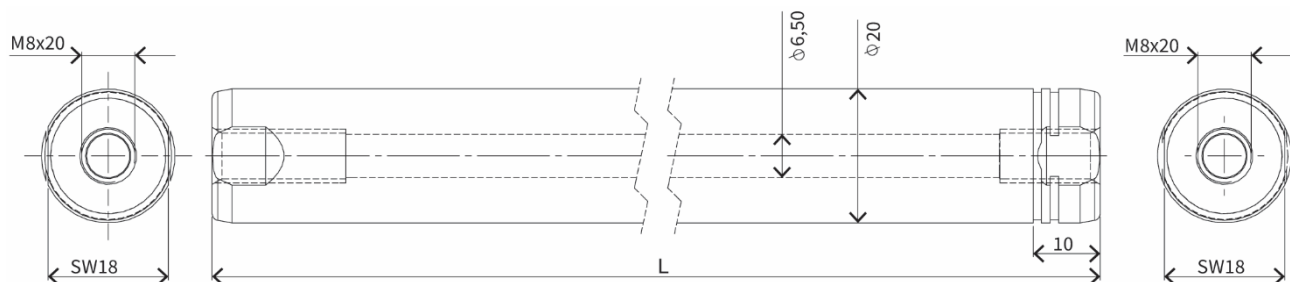



**Note:** Inner wall of slider is not made of chrome steel.

Item	Description	Item-No.	Length L [mm]
PL01-20x160/100-HP-L	Slider 'High Performance L'	on request	160
PL01-20x200/140-HP-L	Slider 'High Performance L'	on request	200
PL01-20x240/180-HP-L	Slider 'High Performance L'	0150-2540	240
PL01-20x300/240-HP-L	Slider 'High Performance L'	0150-3696	300
PL01-20x360/300-HP-L	Slider 'High Performance L'	0150-1537	360
PL01-20x400/340-HP-L	Slider 'High Performance L'	0150-3697	400

PL01-20x500/440-HP-L	Slider 'High Performance L'	0150-3698	500
PL01-20x600/540-HP-L	Slider 'High Performance L'	0150-3699	600
PL01-20x700/640-HP-L	Slider 'High Performance L'	0150-3700	700
PL01-20x800/740-HP-L	Slider 'High Performance L'	0150-3701	800
PL01-20x900/840-HP-L	Slider 'High Performance L'	0150-3702	900
PL01-20x1000/940-HP-L	Slider 'High Performance L'	0150-3703	1000
PL01-20x1200/1140-HP-L	Slider 'High Performance L'	0150-2510	1200
PL01-20x1400/1340-HP-L	Slider 'High Performance L'	on request	1400
PL01-20x1600/1540-HP-L	Slider 'High Performance L'	on request	1600

**9 International Certificates**

<p>Europe</p> 	<p>See chapter “EU Declaration of Conformity CE-Marking”</p>
<p>UK</p> 	<p>See chapter “UK Declaration of Conformity UKCA-Marking”</p>
<p><b>IECEE CB SCHEME</b></p>	<p>Ref. Certif. Nr. CH-8521</p>
<p>USA / Canada</p> 	<p>File Number E354430</p> <p>Refers to cURus marked motors</p>

		Ref. Certif. No.  CH-8521
IEC SYSTEM FOR MUTUAL RECOGNITION OF TEST CERTIFICATES FOR ELECTRICAL EQUIPMENT (IECEE) CB SCHEME		
<b>CB TEST CERTIFICATE</b>		
Product	Linear motor	
Name and address of the applicant	NTI AG      Bodenackerstrasse 2   SWITZERLAND 8957 Spreitenbach	
Name and address of the manufacturer	NTI AG      Bodenackerstrasse 2   SWITZERLAND 8957 Spreitenbach	
Name and address of the factory	NTI AG      Bodenackerstrasse 2   SWITZERLAND 8957 Spreitenbach	
<i>Note: When more than one factory, please report on page 2</i>		
Ratings and principal characteristics	<input type="checkbox"/> Additional Information on page 2 supplied via servo drive, see TR 17-EL-0006.E02 for details	
Trade mark (if any)	LinMot	
Customers's Testing Facility (CTF) Stage used	---	
Model / Type Ref.	PR series PS series P04 series P05 series	
Additional information (if necessary may also be reported on page 2)	---	
A sample of product was tested and found to be in conformity with IEC	<input type="checkbox"/> Additional Information on page 2 IEC 61000-6-2:2016 IEC 61000-6-4:2006, IEC 61000-6-4:2006/AMD1:2010 IEC 61000-6-7:2014	
National differences	EU Group Differences; EU Special National Conditions; EU A-Deviations	
As shown in the Test Report Ref. No. which forms part of this Certificate	17-EL-0006.E01 + .E02 + .Z01	

This CB Test Certificate is issued by the National Certification Body	
Electrosuisse Luppenstrasse 1 8320 Fehraltorf SWITZERLAND	
Signed by:      Martin Plüss Date:                2017-03-13	
page 1 of 1	

## CERTIFICATE OF COMPLIANCE

**Certificate Number** UL-US-2138367-0  
**Report Reference** E354430-20210817  
**Date** 23-Aug-2021

**Issued to:** NTI AG  
Bodenaeckerstr 2 SPREITENBACH  
Switzerland 8957

**This is to certify that  
representative samples of**

NDMM2 - Incomplete Rotating Machines and Rotating  
Machine Parts - Component

See Addendum Page for Product Designation(s).

Have been investigated by UL in accordance with the  
component requirements in the Standard(s) indicated on  
this Certificate. UL Recognized components are incomplete  
in certain constructional features or restricted in  
performance capabilities and are intended for installation in  
complete equipment submitted for investigation to UL LLC.

**Standard(s) for Safety:** UL 1004-1, 2nd Ed., Issue Date: 2012-09-19, Revision  
Date: 2020-11-05

**Additional Information:** See the UL Online Certifications Directory at  
<https://iq.ulprospector.com> for additional information

This *Certificate of Compliance* does not provide authorization to apply the UL Recognized Component Mark.  
Only the UL Follow-Up Services Procedure provides authorization to apply the UL Mark.

Only those products bearing the UL Recognized Component Mark should be considered as being UL Certified  
and covered under UL's Follow-Up Services.

Look for the UL Recognized Component Mark on the product.

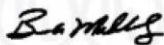

Bruce Mahrenholz, Director North American Certification Program

UL LLC

Any information and documentation involving UL Mark services are provided on behalf of UL LLC (UL) or any authorized licensee of UL. For questions, please  
contact a local UL Customer Service Representative at <http://ul.com/aboutul/locations/>





# CERTIFICATE OF COMPLIANCE

**Certificate Number** UL-US-2138367-0  
**Report Reference** E354430-20210817  
**Date** 23-Aug-2021

This is to certify that representative samples of the product as specified on this certificate were tested according to the current UL requirements

Model	Category Description
<b>PS01</b> , PS01, Followed by 2 digits, Followed by "x" or "Sx", Followed by 2 or 3 digits, Followed by "-", "F", "H" or "G", Followed by HP, followed by "B" plus 2 digits, Followed by SSCP, followed by "G" plus 2 digits (optional), followed by R, C, H, M or MF, Followed by 2 or 3 digits (optional), followed by any alphanumeric digit (optional)	Incomplete Motor Parts
<b>SM01</b> , SM01, Followed by 2 digits, Followed by "x" or "Sx", Followed by 2 or 3 digits, Followed by "-", "F", "H" or "G", Followed by HP, Followed by R, C, H, M or MF, Followed by 2 or 3 digits (Optional), Followed by 2 or 3 digits, Followed by "BE" plus 2 digits (Optional), Followed by "MS" plus 2 digits (Optional), Followed by "EN" plus 2 digits (Optional), Followed by "FS" plus 2 digits (Optional), Followed by "BK" plus 2 digits (Optional), Followed by SSCP, followed by "-" or any alphanumeric digit.	Incomplete Motor Parts
<b>SM02</b> , SM02, Followed by 2 digits, Followed by "x" or "Sx", Followed by 2 or 3 digits, Followed by "-", "F", "H" or "G", Followed by HP, Followed by R, C, H, M or MF, Followed by 2 or 3 digits (Optional), Followed by 2 or 3 digits, Followed by "BE" plus 2 digits (Optional), Followed by "MS" plus 2 digits (Optional), Followed by "EN" plus 2 digits (Optional), Followed by "FS" plus 2 digits (Optional), Followed by "BK" plus 2 digits (Optional), Followed by SSCP, followed by "-" or any alphanumeric digit.	Incomplete Motor Parts

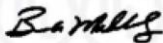

Bruce Mahrenholz, Director North American Certification Program

UL LLC

Any information and documentation involving UL Mark services are provided on behalf of UL LLC (UL) or any authorized licensee of UL. For questions, please contact a local UL Customer Service Representative at <http://ul.com/aboutul/locations/>



## CERTIFICATE OF COMPLIANCE

**Certificate Number** UL-CA-2128754-0  
**Report Reference** E354430-20210817  
**Date** 23-Aug-2021

**Issued to:** NTI AG  
Bodenaeckerstr 2 SPREITENBACH  
Switzerland 8957

**This is to certify that  
representative samples of**

NDMM8 - Incomplete Rotating Machines and Rotating  
Machine Parts Certified for Canada - Component  
See Addendum Page for Product Designation(s).

Have been investigated by UL in accordance with the  
component requirements in the Standard(s) indicated on  
this Certificate. UL Recognized components are incomplete  
in certain constructional features or restricted in  
performance capabilities and are intended for installation in  
complete equipment submitted for investigation to UL LLC.

**Standard(s) for Safety:** CSA C22.2 NO. 100, 7th Ed., Issue Date: 2014-07-01,  
Revision Date: 2017-04-01

**Additional Information:** See the UL Online Certifications Directory at  
<https://iq.ulprospector.com> for additional information

This *Certificate of Compliance* does not provide authorization to apply the UL Recognized Component Mark.  
Only the UL Follow-Up Services Procedure provides authorization to apply the UL Mark.

Only those products bearing the UL Recognized Component Mark should be considered as being UL Certified  
and covered under UL's Follow-Up Services.

Look for the UL Recognized Component Mark on the product.

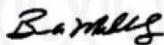

Bruce Mahrenholz, Director North American Certification Program

UL LLC

Any information and documentation involving UL Mark services are provided on behalf of UL LLC (UL) or any authorized licensee of UL. For questions, please  
contact a local UL Customer Service Representative at <http://ul.com/aboutul/locations/>





# CERTIFICATE OF COMPLIANCE

**Certificate Number** UL-CA-2128754-0  
**Report Reference** E354430-20210817  
**Date** 23-Aug-2021

This is to certify that representative samples of the product as specified on this certificate were tested according to the current UL requirements

Model	Category Description
<b>PS01</b> , PS01, Followed by 2 digits, Followed by "x" or "Sx", Followed by 2 or 3 digits, Followed by "-", "F", "H" or "G", Followed by HP, followed by "B" plus 2 digits, Followed by SSCP, followed by "G" plus 2 digits (optional), followed by R, C, H, M or MF, Followed by 2 or 3 digits (optional), followed by any alphanumeric digit (optional)	Incomplete Motor Parts
<b>SM01</b> , SM01, Followed by 2 digits, Followed by "x" or "Sx", Followed by 2 or 3 digits, Followed by "-", "F", "H" or "G", Followed by HP, Followed by R, C, H, M or MF, Followed by 2 or 3 digits (Optional), Followed by 2 or 3 digits, Followed by "BE" plus 2 digits (Optional), Followed by "MS" plus 2 digits (Optional), Followed by "EN" plus 2 digits (Optional), Followed by "FS" plus 2 digits (Optional), Followed by "BK" plus 2 digits (Optional), Followed by SSCP, followed by "-" or any alphanumeric digit.	Incomplete Motor Parts
<b>SM02</b> , SM02, Followed by 2 digits, Followed by "x" or "Sx", Followed by 2 or 3 digits, Followed by "-", "F", "H" or "G", Followed by HP, Followed by R, C, H, M or MF, Followed by 2 or 3 digits (Optional), Followed by 2 or 3 digits, Followed by "BE" plus 2 digits (Optional), Followed by "MS" plus 2 digits (Optional), Followed by "EN" plus 2 digits (Optional), Followed by "FS" plus 2 digits (Optional), Followed by "BK" plus 2 digits (Optional), Followed by SSCP, followed by "-" or any alphanumeric digit.	Incomplete Motor Parts

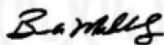

Bruce Mahrenholz, Director North American Certification Program

UL LLC

Any information and documentation involving UL Mark services are provided on behalf of UL LLC (UL) or any authorized licensee of UL. For questions, please contact a local UL Customer Service Representative at <http://ul.com/aboutul/locations/>



## 10 EU Declaration of Conformity CE-Marking

NTI AG / LinMot®  
Bodenaeckerstrasse 2  
8957 Spreitenbach

Switzerland

Tel.: +41 (0)56 419 91 91

Fax: +41 (0)56 419 91 92

declares under sole responsibility the compliance of the products:

- Linear Motors of the Series **PS01-37S SSCP**

with the EMC Directive 2014/30/EU.

Applied harmonized standards:

- **EN 61000-6-2: 2005 (Immunity for industrial environments)**
- **EN 61000-6-4: 2007 + A1: 2011 (Emission for industrial environments)**

According to the EMC directive, the listed devices are not independently operable products.

Compliance of the directive requires the correct installation of the product, the observance of specific installation guides and product documentation. This was tested on specific system configurations.

The safety instructions of the manuals are to be considered.

The product must be mounted and used in strict accordance with the installation instructions contained within the installation guide, a copy of which may be obtained from NTI AG.

Company: NTI AG  
Spreitenbach, 19.01.2026



Dr.-Ing. Ronald Rohner  
CEO NTI AG

## 11 UK Declaration of Conformity UKCA-Marking

NTI AG / LinMot®  
Bodenaeckerstrasse 2  
8957 Spreitenbach

Switzerland

Tel.: +41 (0)56 419 91 91

Fax: +41 (0)56 419 91 92

declares under sole responsibility the compliance of the products:

- Linear Motors of the Series **PS01-37S SSCP**

with the EMC Regulation S.I. 2016 No. 1091.

Applied designated standards:

- **EN 61000-6-2: 2005 (Immunity for industrial environments)**
- **EN 61000-6-4: 2007 + A1: 2011 (Emission for industrial environments)**

According to the EMC regulation, the listed devices are not independently operable products.

Compliance of the regulation requires the correct installation of the product, the observance of specific installation guides and product documentation. This was tested on specific system configurations.

The safety instructions of the manuals are to be considered.

The product must be mounted and used in strict accordance with the installation instructions contained within the installation guide, a copy of which may be obtained from NTI AG.

Company: NTI AG  
Spreitenbach, 19.01.2026



Dr.-Ing. Ronald Rohner  
CEO NTI AG

# ALL LINEAR MOTION FROM A SINGLE SOURCE

## Europe / Asia Headquarters

### **NTI AG - LinMot & MagSpring**

Bodenaeckerstrasse 2  
CH-8957 Spreitenbach

Sales / Administration: T +41-(0)56-419 91 91  
F +41-(0)56-419 91 92  
[office@linmot.com](mailto:office@linmot.com)

Tech. Support: +41-(0)56-544 71 00  
[support@linmot.com](mailto:support@linmot.com)

Web: <http://www.linmot.com/>

## North / South America Headquarters

### **LinMot USA, Inc.**

N1922 State Road 120, Unit 1  
Lake Geneva, WI 53147

Sales / Administration : 262-743-2555  
[usasales@linmot.com](mailto:usasales@linmot.com)

Tech. Support: [usasupport@linmot.com](mailto:usasupport@linmot.com)

Web: <http://www.linmot.com/>

Visit <http://www.linmot.com/> to find a distributor next to you.