

The copyright to this document, which is personally entrusted to the recipient, remains with our company. Without our written permission, the document may not be copied nor reproduced nor communicated or made accessible to third parties without our written permission.

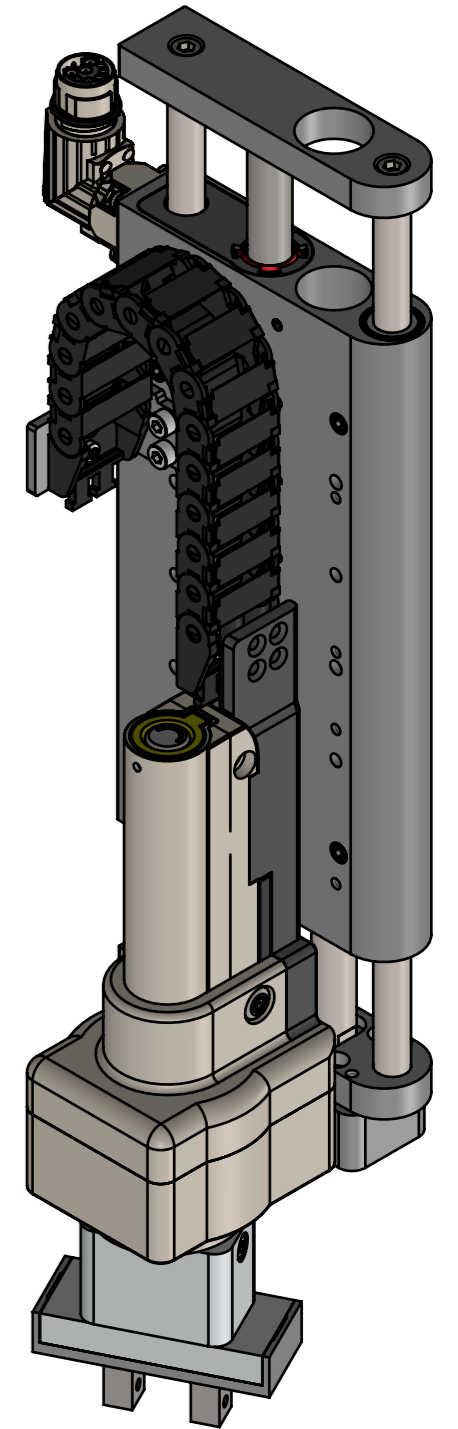
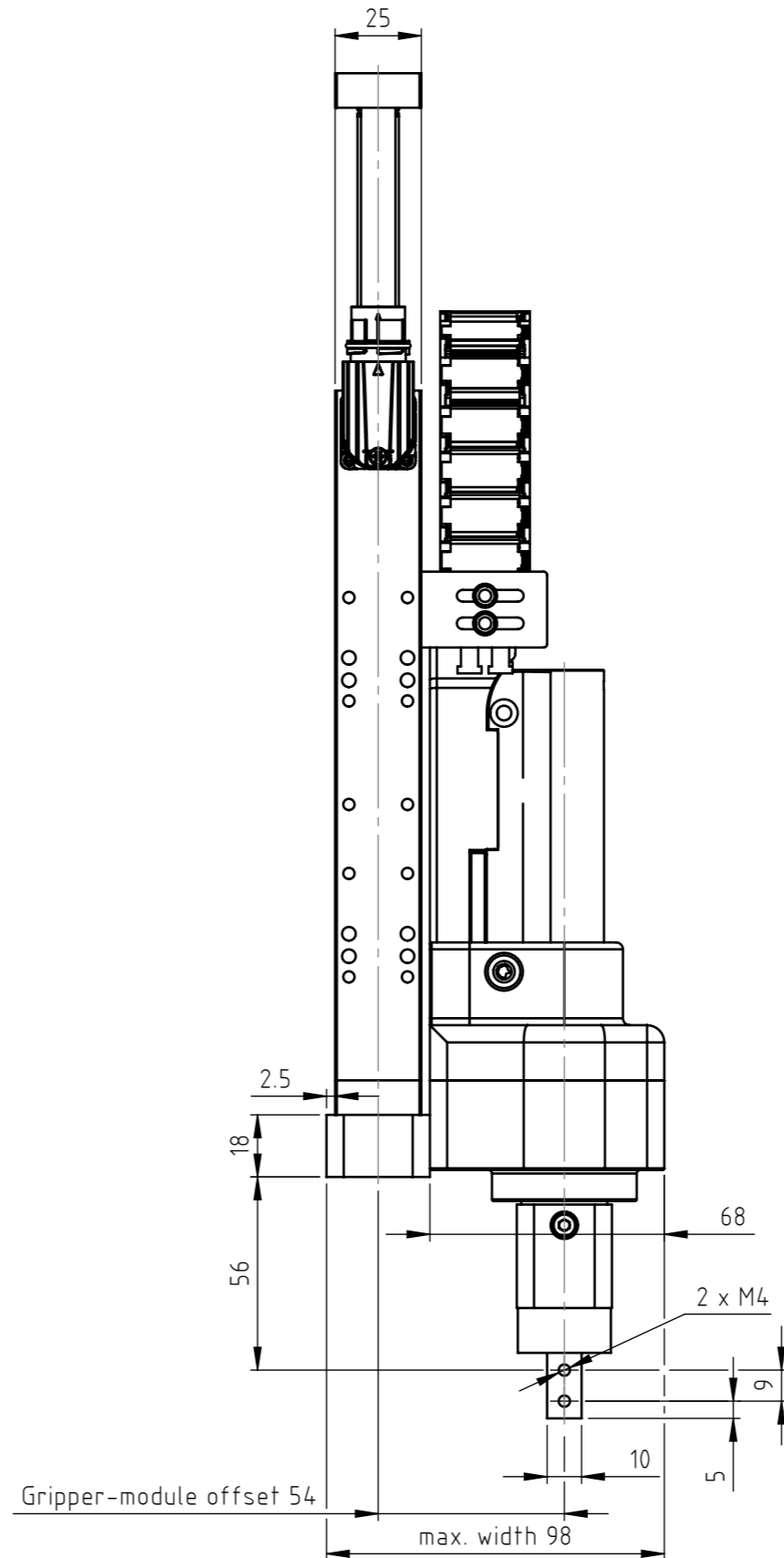
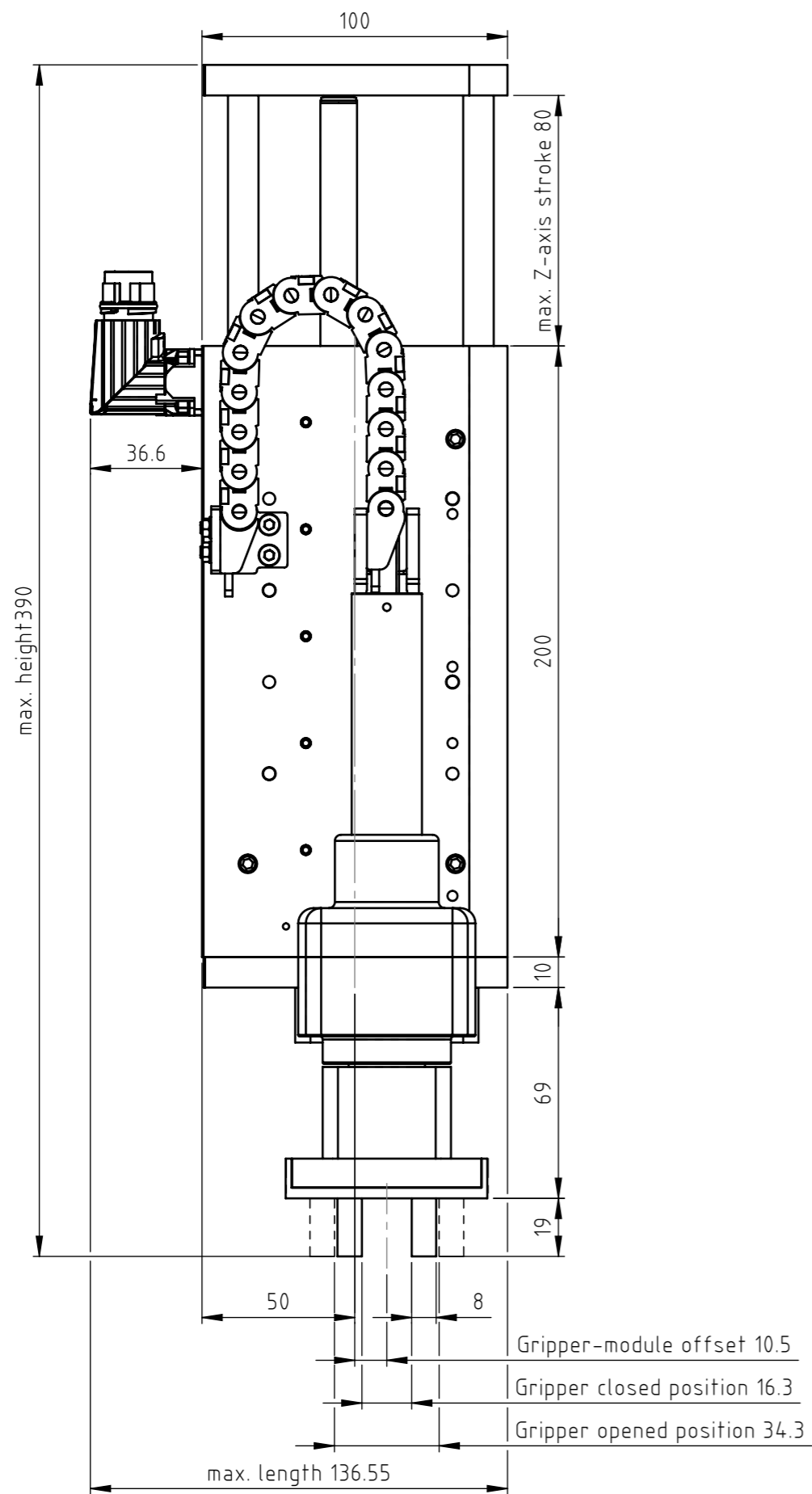

Rev.	Change	Date	Author	Appr.
A	Document created	05.06.2026	JB	FH

General tolerance DIN ISO 2768 - mK	Created by J.-E. Beekhuis	Status 05.06.2026/jb	Material
LinMot®	0380-0153_VA01_80-23x160H-MS12_S_18-E50x08-GT21-MS03_TC01		<input type="checkbox"/> Safety Rel. Weight (g) <input type="checkbox"/> UL-Rel. 3189.87
	Title, additional title VA01_80-23x160H-MS12_S_18-E50x08-GT21-MS03_TC01		Document type Assembly drawing
NTI AG LinMot & MagSpring Bodenaeckerstrasse 2 CH-8957 Spreitenbach	Vertikalachse / DM03-23x160 & GM51-23x80 Art.No.: 0300-0089		Drawing number / Index 0380-0153A
Template type: SW2020 Version: V1-1 SW_A3_hori_Sheet_format_V1-1	Scale 1:2		Sheet 1 / 3 A3

The copyright to this document, which is personally entrusted to the recipient, remains with our company. Without our written permission, the document may not be copied nor reproduced nor communicated or made accessible to third parties without our written permission.

Stage type	VA01_80-23x160H-MS12_S_18-E50x08-GT21-MS03_TC01		
Motor type	Z-axis: 0150-6193 DM03-23x160H-XP-R-80_CS10_MS12	Gripper: 0150-6302 GM51-23Sx80F-XP-K_35-18_E50x08-NG_GT21_MS03	
Serial number		Serial number	
Stroke	80	Stroke	18
Max. Force@48VDC [N]	137.3	Max. clamping force [N]	41
Max. Force@72VDC [N]	137.3	Max. continuous clamping force: Closing direction [N]	12
Position resolution [mm]	0.002	Max. continuous clamping force: Opening direction [N]	8
Repeatability [mm]	±0.05	Max. torque [Nm]	1.03
Max. acceleration [m/s ²]	< 50	Continuous torque [Nm]	0.32
Max. Velocity@48VDC [m/s]	2.5	Repeatability - Linear [mm]	±0.05
Max. Velocity@72VDC [m/s]	3.8	Repeatability - Rotary [°]	±0.05
Deviation	see datasheet	Min. opening/ closing time [s]	0.02
Moving mass [kg]	0.800	Max. rotation speed [rpm]	3000 (×see note in datasheet)
Module mass [kg]	2.140		
Cable weight [kg/km]	83.0	Module mass [kg]	1.100
Max. payload	see datasheet	Max. payload	see datasheet
Grease type - Motor	0150-1954 / 0150-1955 LU02	Grease type - Motor	0150-6972 ELKALUB VP 874
Grease type - Bearings	0150-6972 ELKALUB VP 874	Grease type - lever mechanic	0150-2744 Interflon Food Grease 2 für INOX
Grease type - MagSpring	0150-1954 / 0150-1955 LU02		

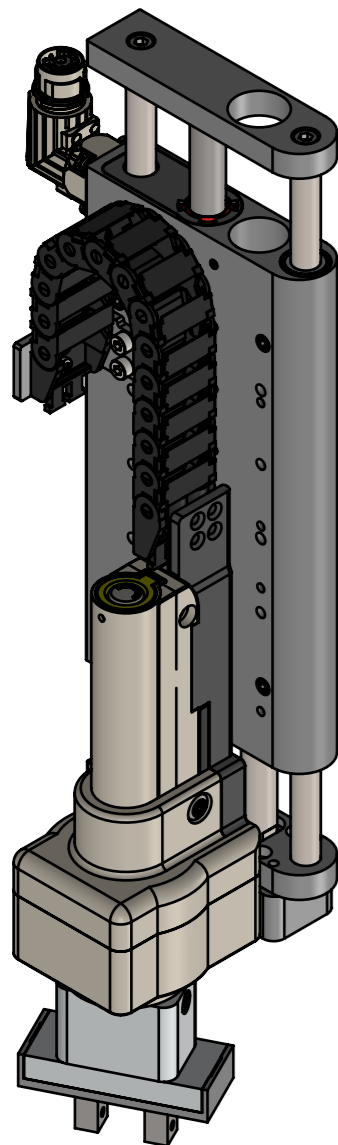

Accessories			
Stage type	VA01_80-23x160H-MS12_S_18-E50x08-GT21-MS03_TC01		
Motor type	Z-axis: 0150-6193 DM03-23x160H-XP-R-80_CS10_MS12	Gripper: 0150-6302 GM51-23Sx80F-XP-K_35-18_E50x08-NG_GT21_MS03	
Motor cable	Not selected	Selected: 0150-2186 KS03-R/K-2 0150-6571 KS05-09-R/NG-2	
External sensor	Not selected	Not selected	
Cable guide	Chosen: 0150-6443 GM51-23-TC-26x12.5		
Force sensor	Not selected	Not selected	

Rev.	Change	Date	Author	Appr.
A	Document created	05.06.2026	JB	FH

General tolerance DIN ISO 2768 - mK	Created by J.-E. Beekhuis	Status 05.06.2026/jb	Material
LinMot®	0380-0153_VA01_80-23x160H-MS12_S_18-E50x08-GT21-MS03_TC01		<input type="checkbox"/> Safety Rel. Weight (g) <input type="checkbox"/> UL-Rel.
NTI AG LinMot & MagSpring Bodenaeckerstrasse 2 CH-8957 Spreitenbach	Title, additional title VA01_80-23x160H-MS12_S_18-E50x08-GT21-MS03_TC01 Vertikalachse / DM03-23x160 & GM51-23x80 Art.No.: 0300-0089		Document type Assembly drawing Drawing number / Index 0380-0153A
Template type: SW2020 Version: V1-1 SW_A3_hori_Sheet_format_V1-1	Scale 2:5		Sheet 2 / 3 A3

The copyright to this document, which is personally entrusted to the recipient, remains with our company. Without our written permission, the document may not be copied nor reproduced nor communicated or made accessible to third parties without our written permission.

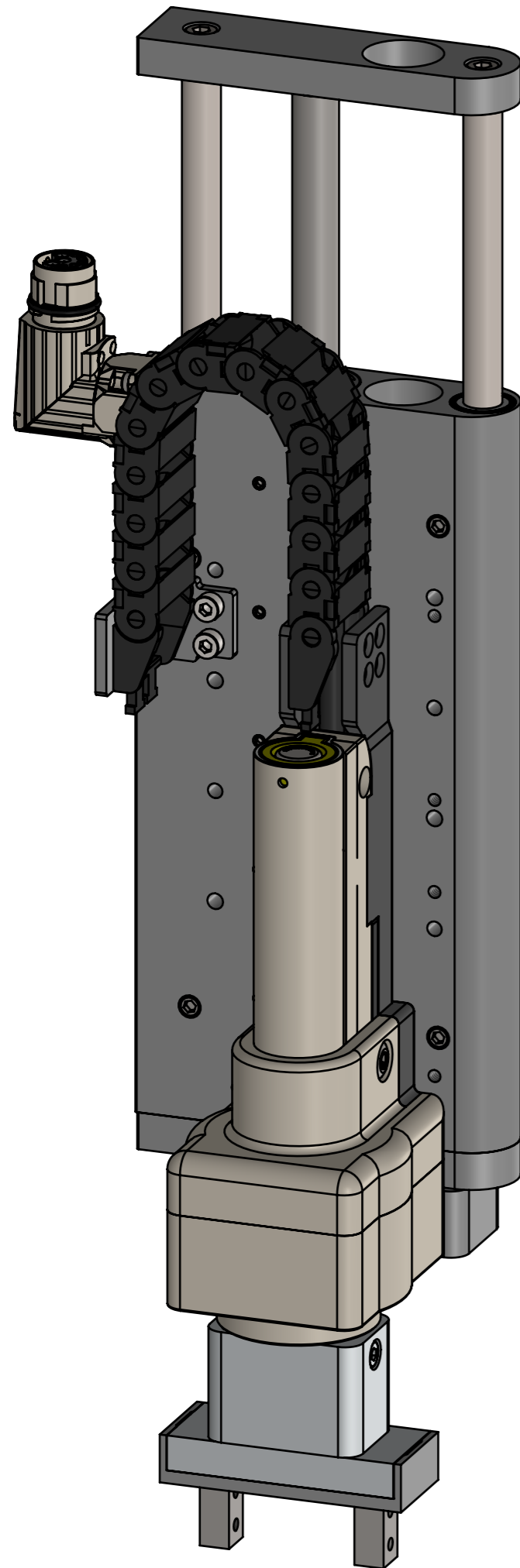

1x 0150-6756 GM50/51-23_DM03-23-AP
 4x ISO 4762 M4x20
 4x ISO 2338 ϕ 4x12
 2x ISO 7041 M5x30

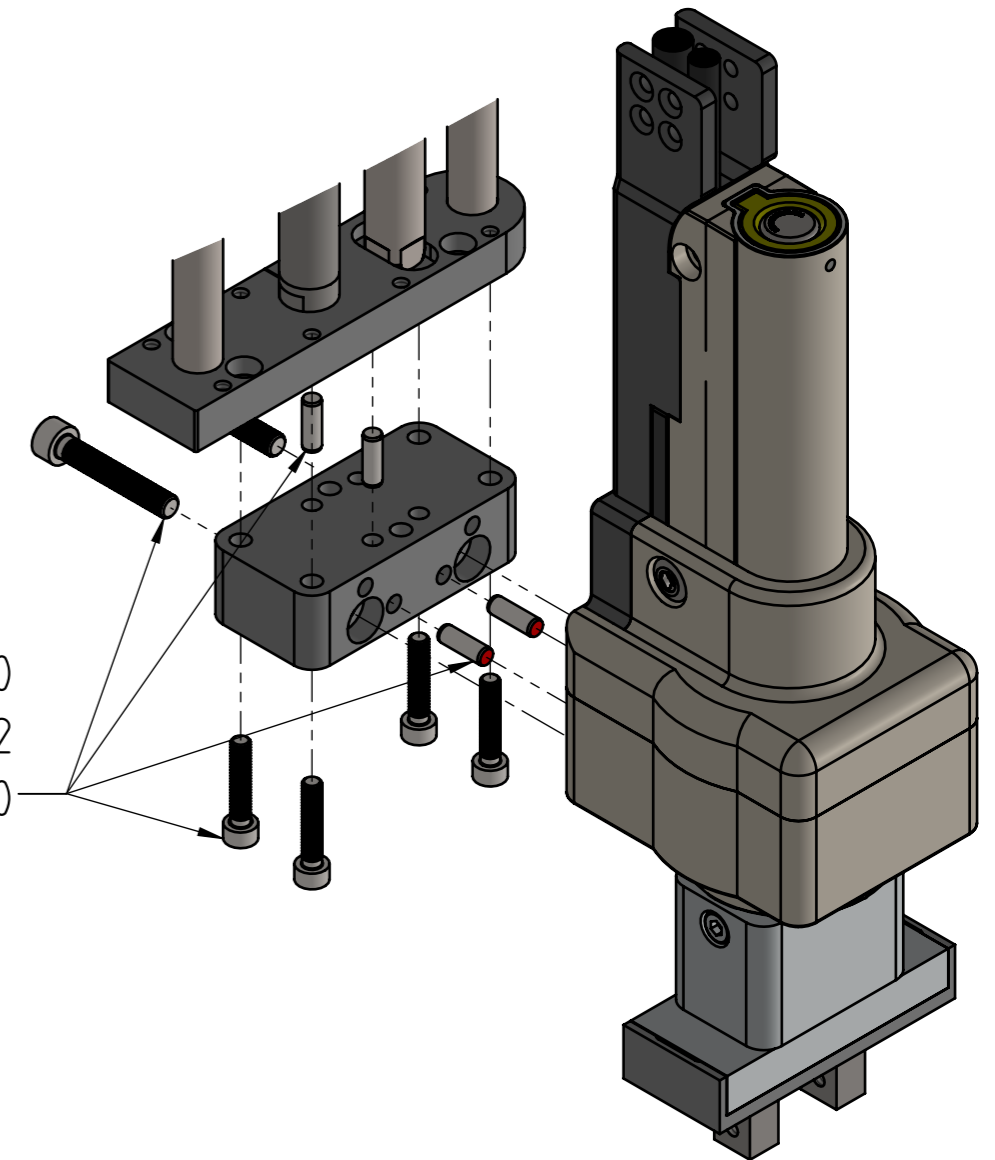

A	Document created	05.06.2026	JB	FH
Rev.	Change	Date	Author	Appr.

General tolerance DIN ISO 2768 - mK	Created by J.-E. Beekhuis	Status 05.06.2026/jb	Material
LinMot®	0380-0153_VA01_80-23x160H-MS12_S_18-E50x08-GT21-MS03_TC01		<input type="checkbox"/> Safety Rel. Weight (g) <input type="checkbox"/> UL-Rel. 3149.82
NTI AG LinMot & MagSpring Bodenaeckerstrasse 2 CH-8957 Spreitenbach	Title, additional title VA01_80-23x160H-MS12_S_18-E50x08-GT21-MS03_TC01 Vertikalachse / DM03-23x160 & GM51-23x80 Art.No.: 0300-0089		Document type Assembly drawing Drawing number / Index 0180-0153A
Template type: SW2020 Version: V1-1 SW_A3_hori_Sheet_format_V1-1	Scale 2:3		Sheet 3 / 3 A3