

The copyright in this document, which is personally entrusted to the recipient, remains with our company. Without our written permission, the document may not be copied nor reproduced nor communicated or made accessible to third parties without our written permission.

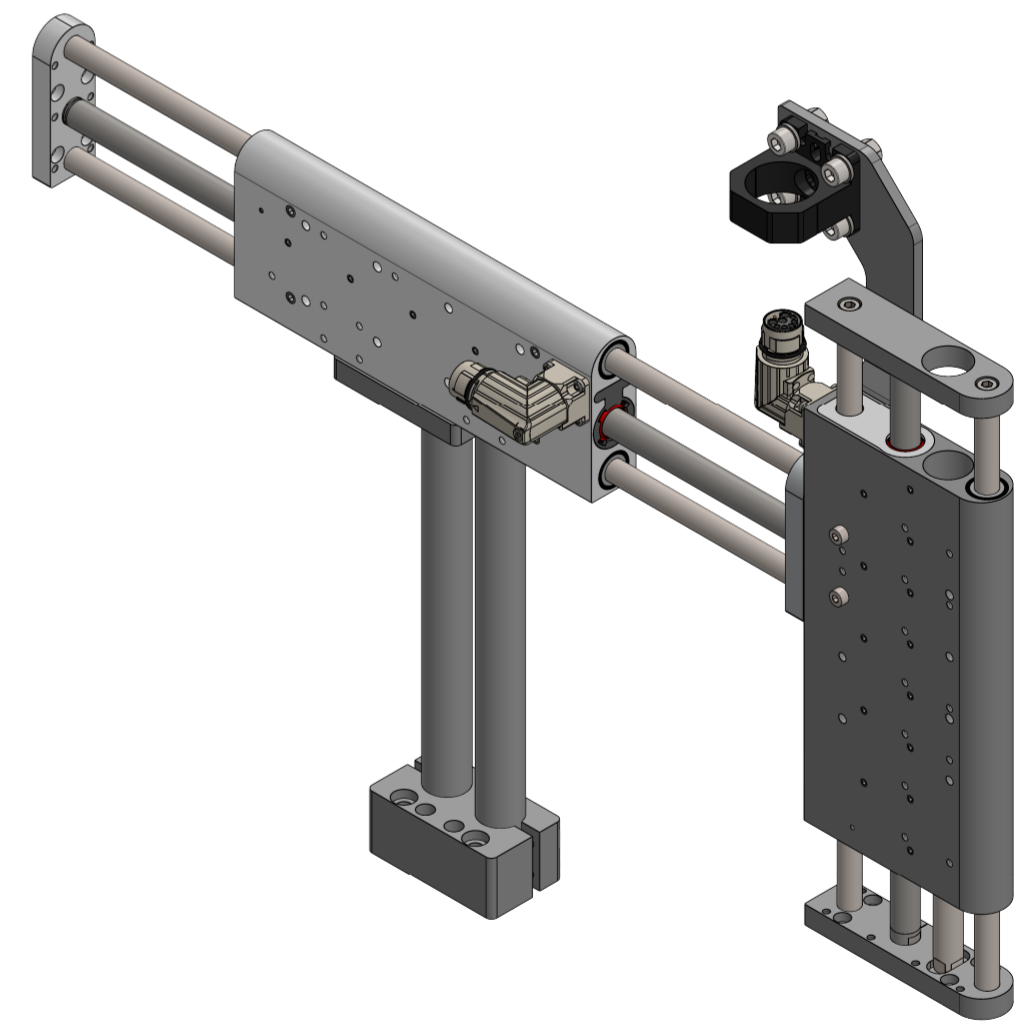
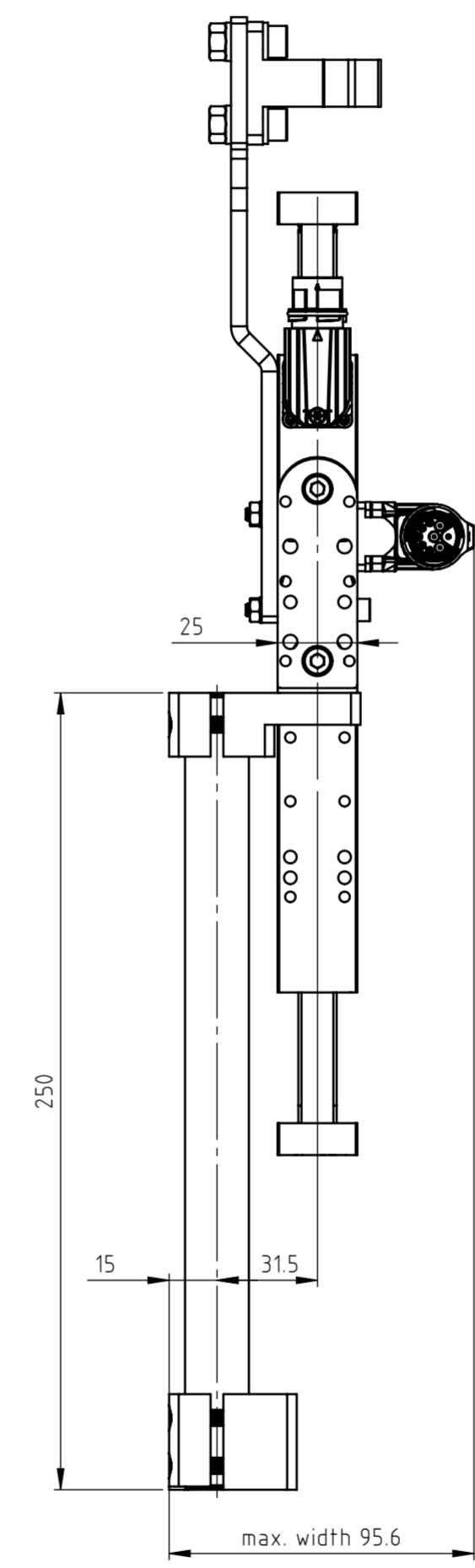
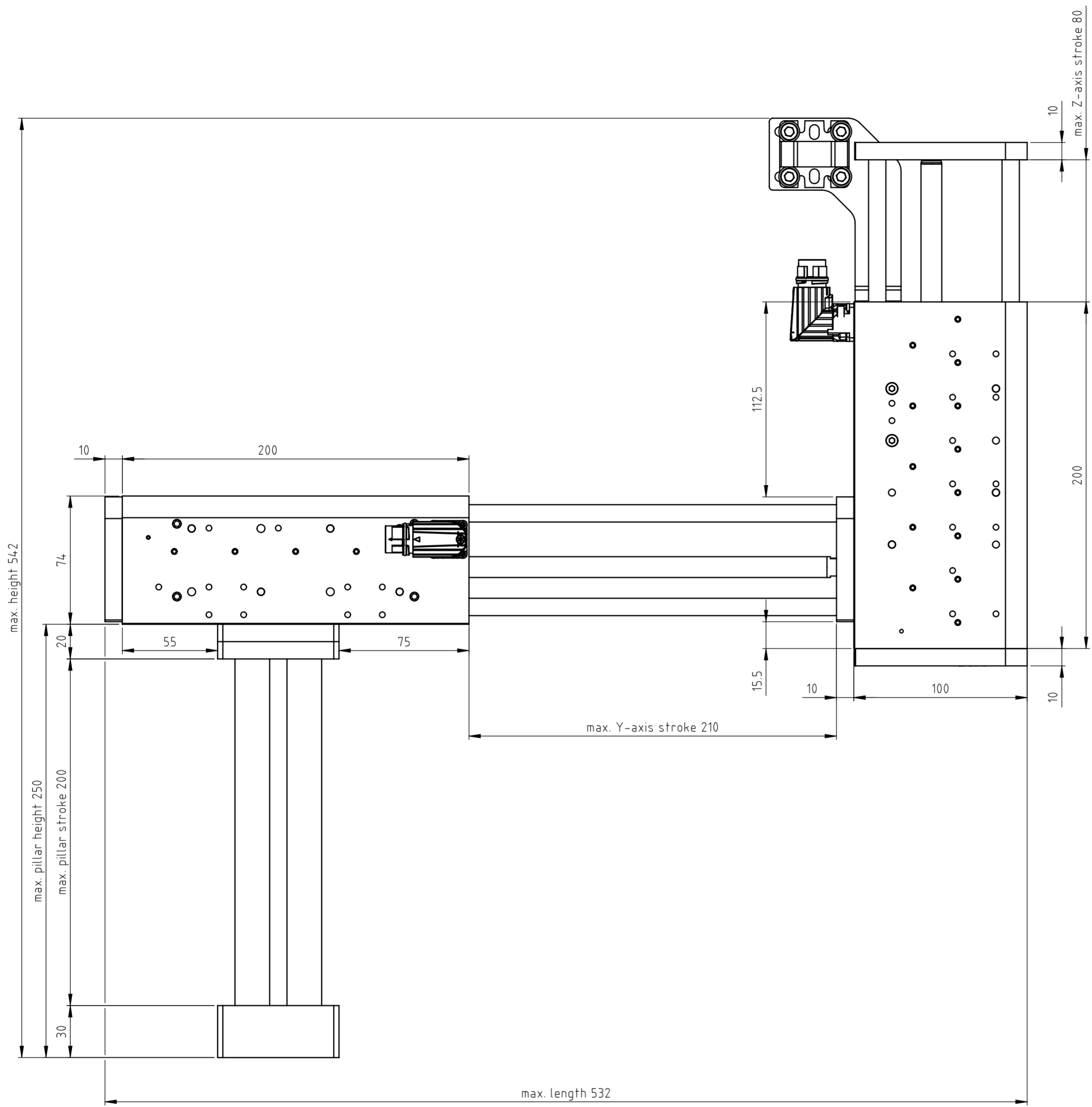

| | | | |
|------|------------------|------------|--------------|
| | | | |
| A | Document created | 14.11.2024 | JB FH |
| Rev. | Change | Date | Author Appr. |

| | | | |
|---|---|--|-------------------|
| General tolerance DIN ISO 2768 - mK | Created by J.-E. Beekhuis | Status 06.02.2025/jb | Material |
| LinMot® | File name 0380-0003_PP03_210-23x160F_80-23x160F-MS11_PS01_TC01 | <input type="checkbox"/> Safety Rel. <input type="checkbox"/> UL-Rel. | Weight (g) |
| NTI AG LinMot & MagSpring Bodenaeckerstrasse 2 CH-8957 Spreitenbach | Title, additional title PP03_210-23x160F_ 80-23x160F-MS11_PS01_TC01 | Document type Assembly drawing | |
| Template type: SW2020 Version: V1-1 SW_A2_hori_Sheet_format_V1-1 | Pick&Place / DM01-23 & DM03-23 Art.No.: 0300-0003 | Drawing number / Index 0380-0003A | |
| | Scale 1:2 | | Sheet 1 / 3 A2 |

The copyright to this document, which is personally entrusted to the recipient, remains with our company. Without our written permission, the document may not be copied nor reproduced nor communicated or made accessible to third parties without our written permission.

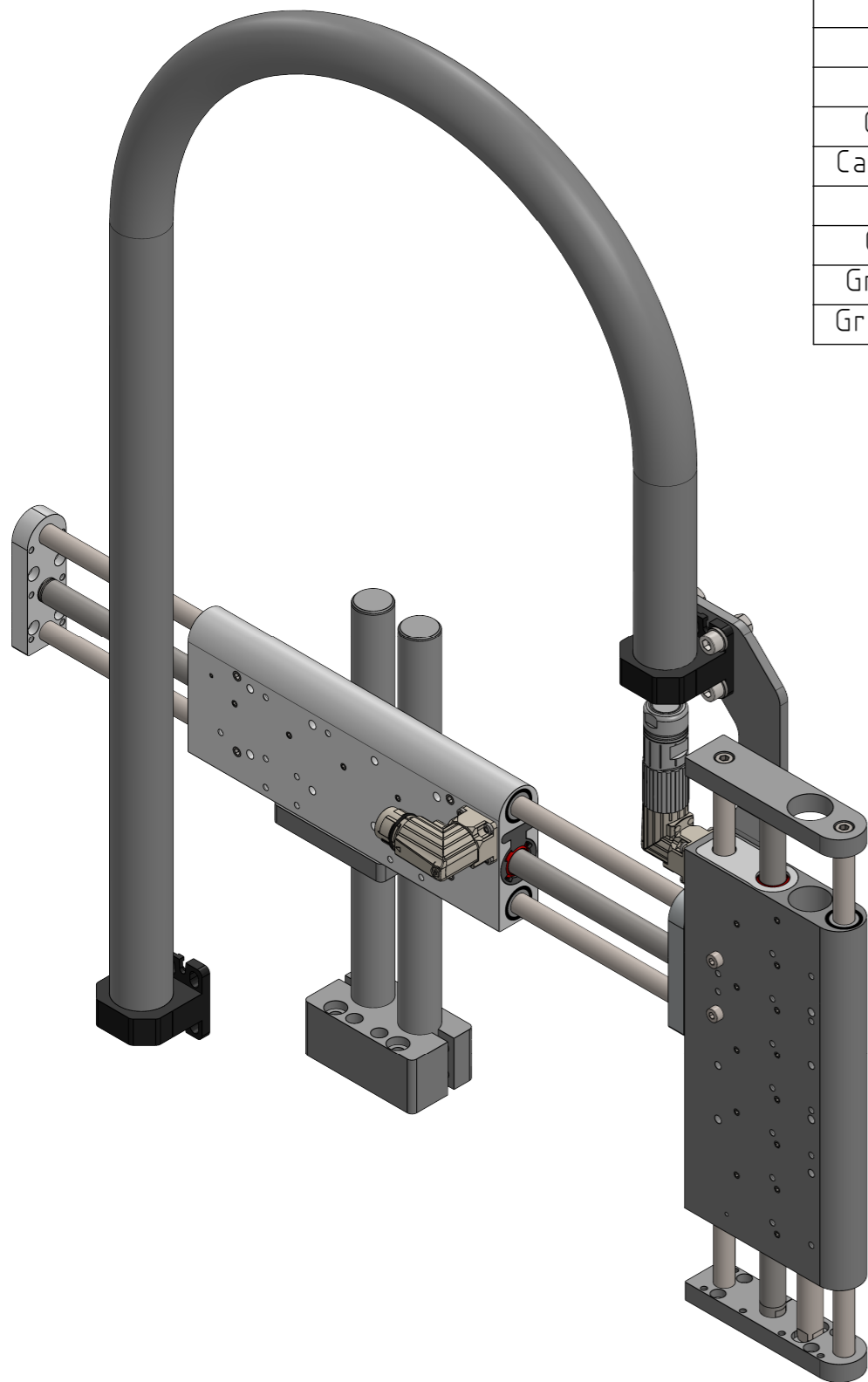

| | | |
|---------------------------------------|---|--|
| Stage type | PP03_210-23x160F_80-23x160F-MS11_PS01_TC01 | |
| Motor type | Horizontal: 0150-6233 DM01-23x160H-XP-R-210 | Vertical: 0150-6109 DM03-23x160H-XP-R-80_CS10_MS11 |
| Stroke | 210 | 80 |
| Max. Force@48VDC [N] | 137 | 137 |
| Max. Force@72VDC [N] | 137 | 137 |
| Position resolution [mm] | 0.002 | 0.002 |
| Repeatability [mm] | ±0.05 | ±0.05 |
| Max. acceleration [m/s ²] | < 50 | < 50 |
| Max. Velocity@48VDC [m/s] | 4.9 | 4.9 |
| Max. Velocity@72VDC [m/s] | 7.3 | 7.3 |
| Deviation | see datasheet | see datasheet |
| Moving mass [kg] | 0.940 | 0.800 |
| Module mass [kg] | 1.910 | 2.140 |
| Pillar mass [kg] | | 1.530 |
| Cable weight [kg/km] | | 83.0 |
| Cable tube weight [kg/m] | | 0.084 |
| Max. payload | see datasheet | see datasheet |
| Grease type - Motor | 0150-1954 / 0150-1955 LU02 | |
| Grease type - Bearings | 0260-0061 SKF LGFP 2 | |
| Grease type - MagSpring | 0150-1954 / 0150-1955 LU02 | |

| Accessories | | |
|-----------------|---|--|
| Stage type | PP03_210-23x160F_80-23x160F-MS11_PS01_TC01 | |
| Motor type | Horizontal: 0150-6233 DM01-23x160H-XP-R-210 | Vertical: 0150-6109 DM03-23x160H-XP-R-80_CS10_MS11 |
| Safety | Not available | Not available |
| Clean room | Available: not chosen | Not available |
| External sensor | Not available | Not available |
| Cover | Not available | Not available |
| Cable guide | Chosen: TC01 | Chosen: TC01 |
| Pillar system | 0150-6388 Z01-SB-20x2 0150-6386 Z01-SL-20x250 0150-6387 Z01-SA-20x2 | Not available |
| Force sensor | Available: not chosen | Available: not chosen |
| Fan Kit | Not available | Not available |

| Rev. | Change | Date | Author | Appr. |
|------|------------------|------------|--------|-------|
| A | Document created | 14.11.2024 | JB | FH |

| | | | |
|---|---|-------------------------|---|
| General tolerance DIN ISO 2768 - mK | Created by J.-E. Beekhuis | Status 06.02.2025/jb | Material |
| LinMot® | 0380-0003_PP03_210-23x160F_80-23x160F-MS11_PS01_TC01 | | <input type="checkbox"/> Safety Rel. Weight (g) <input type="checkbox"/> UL-Rel. |
| NTI AG LinMot & MagSpring Bodenaeckerstrasse 2 CH-8957 Spreitenbach | Title, additional title PP03_210-23x160F_ 80-23x160F-MS11_PS01_TC01 Pick&Place / DM01-23 & DM03-23 Art.No.: 0300-0003 | | Document type Assembly drawing Drawing number / Index 0380-0003A |
| Template type: SW2020 Version: V1-1 SW_A3_hori_Sheet_format_V1-1 | Scale 1:3 | | Sheet 2 / 3 A3 |

TC01: 1m cable tube
 45mm minimum bending radius, static

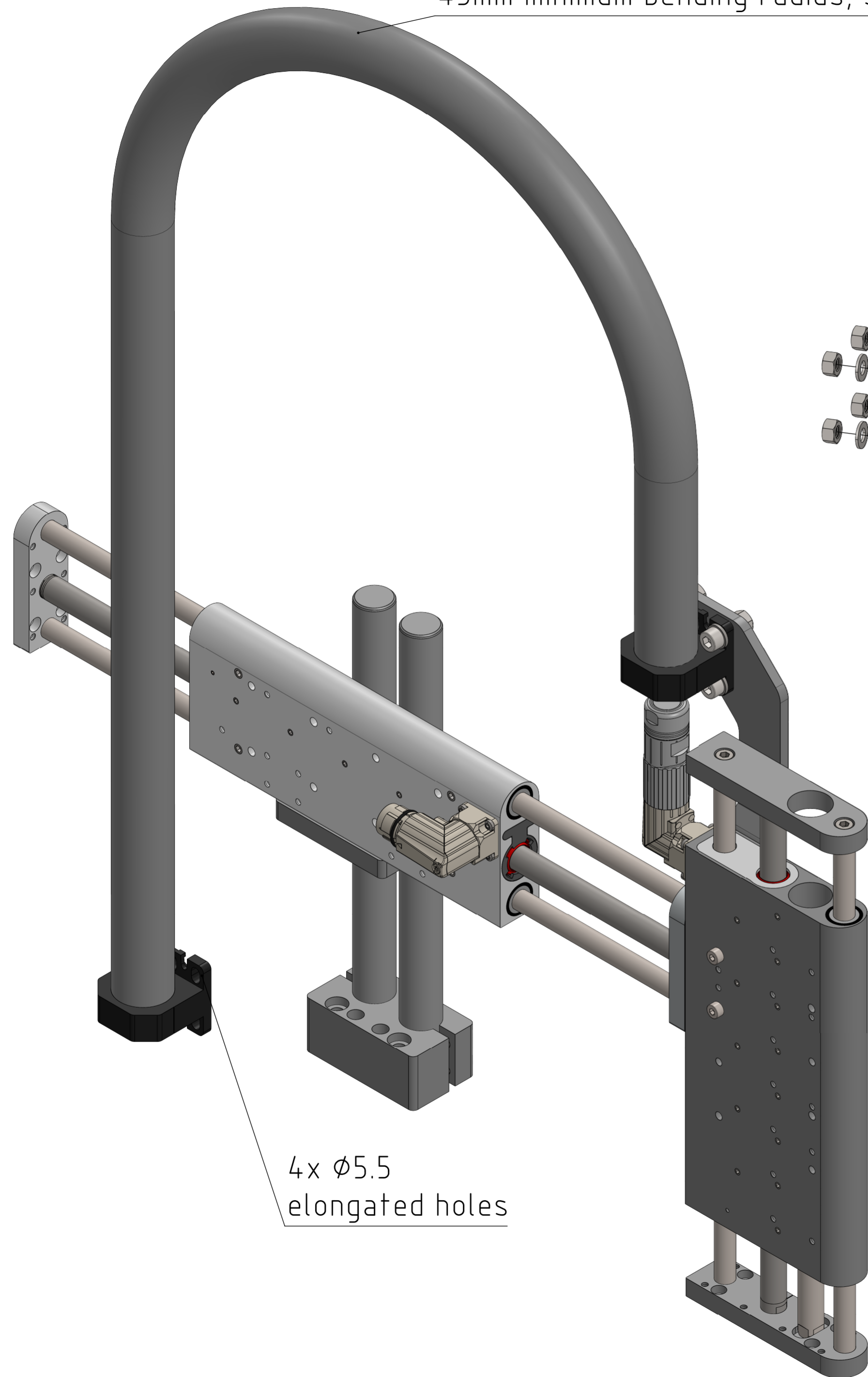

4x $\phi 5.5$
 elongated holes

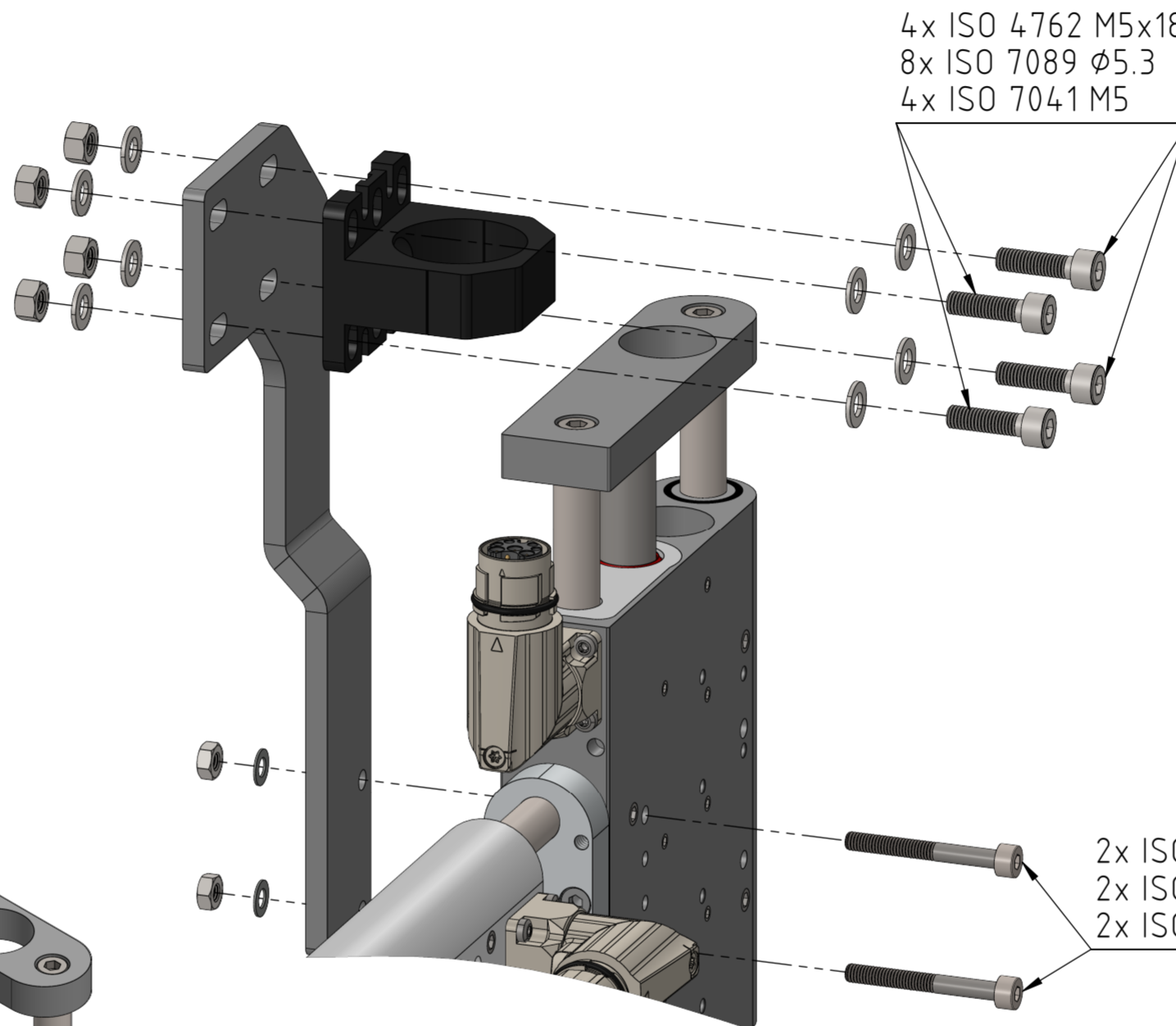

4x ISO 4762 M5x18
 8x ISO 7089 $\phi 5.3$
 4x ISO 7041 M5

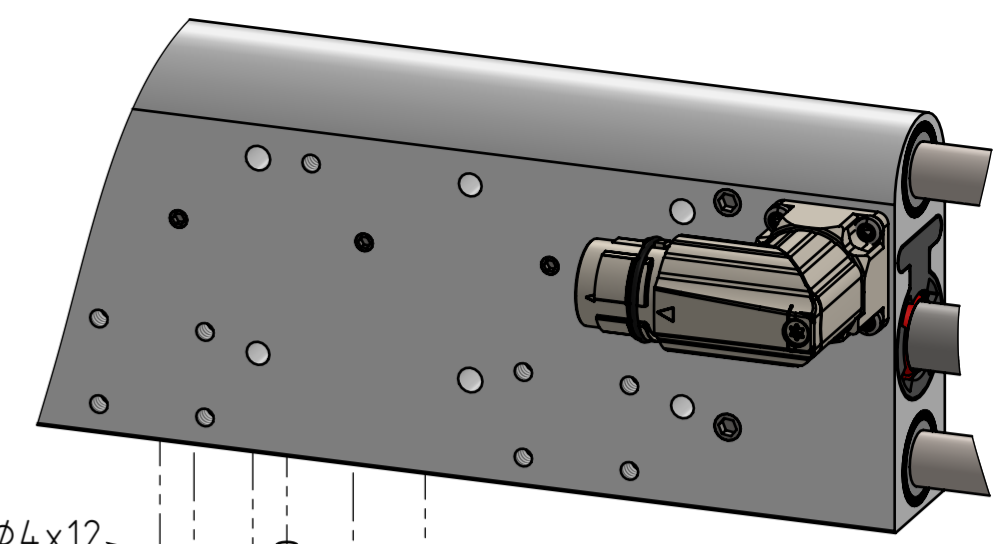

2x ISO 2338 $\phi 4 \times 12$

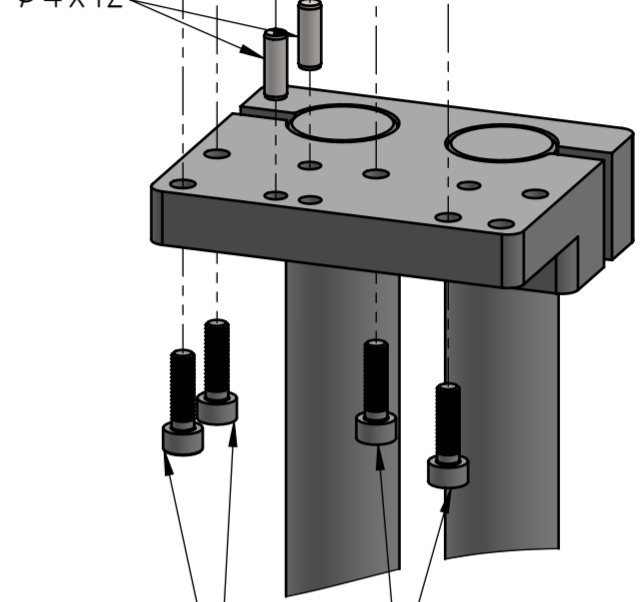

4x ISO 4762 M4x14

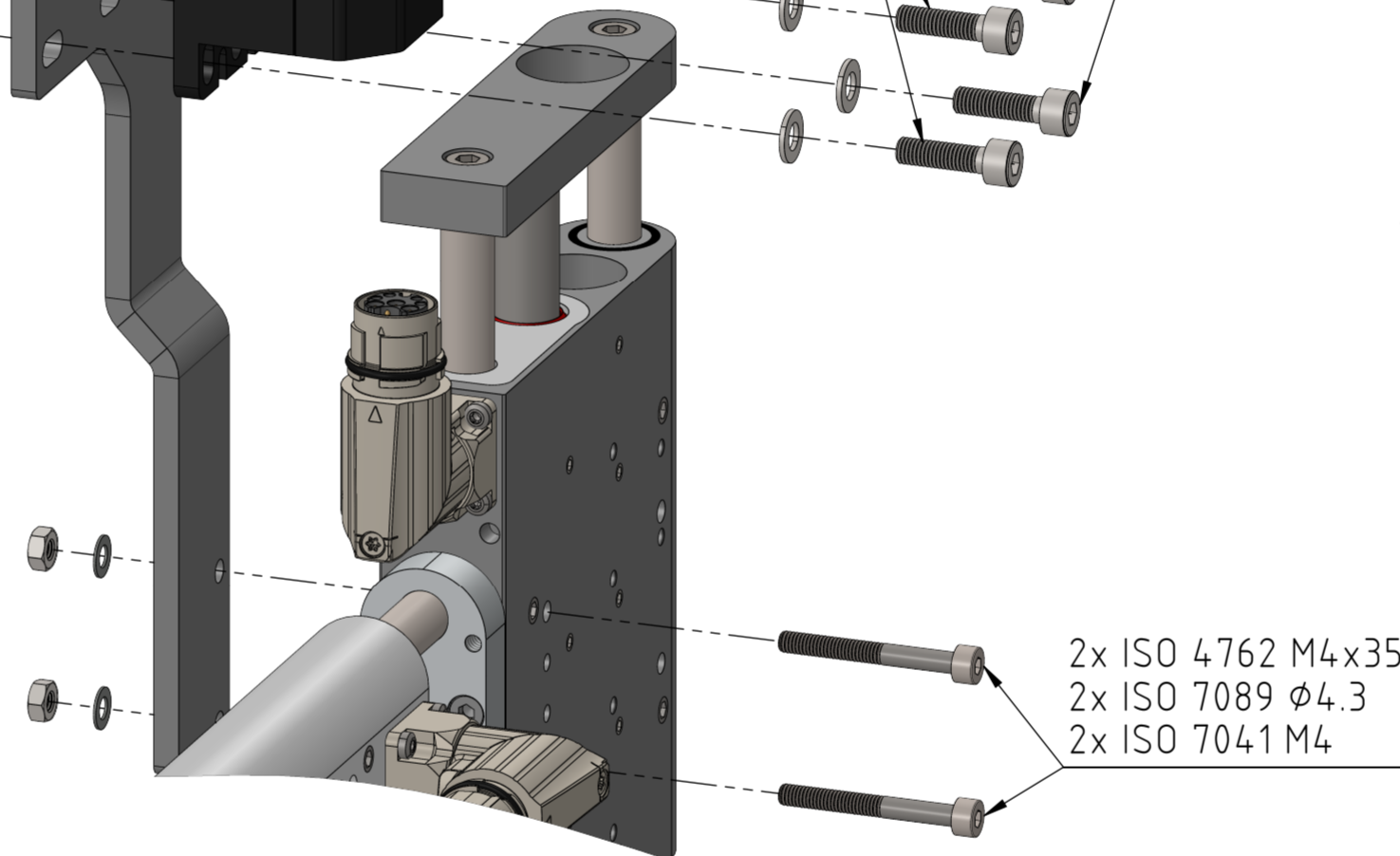

2x ISO 4762 M4x35
 2x ISO 7089 $\phi 4.3$
 2x ISO 7041 M4

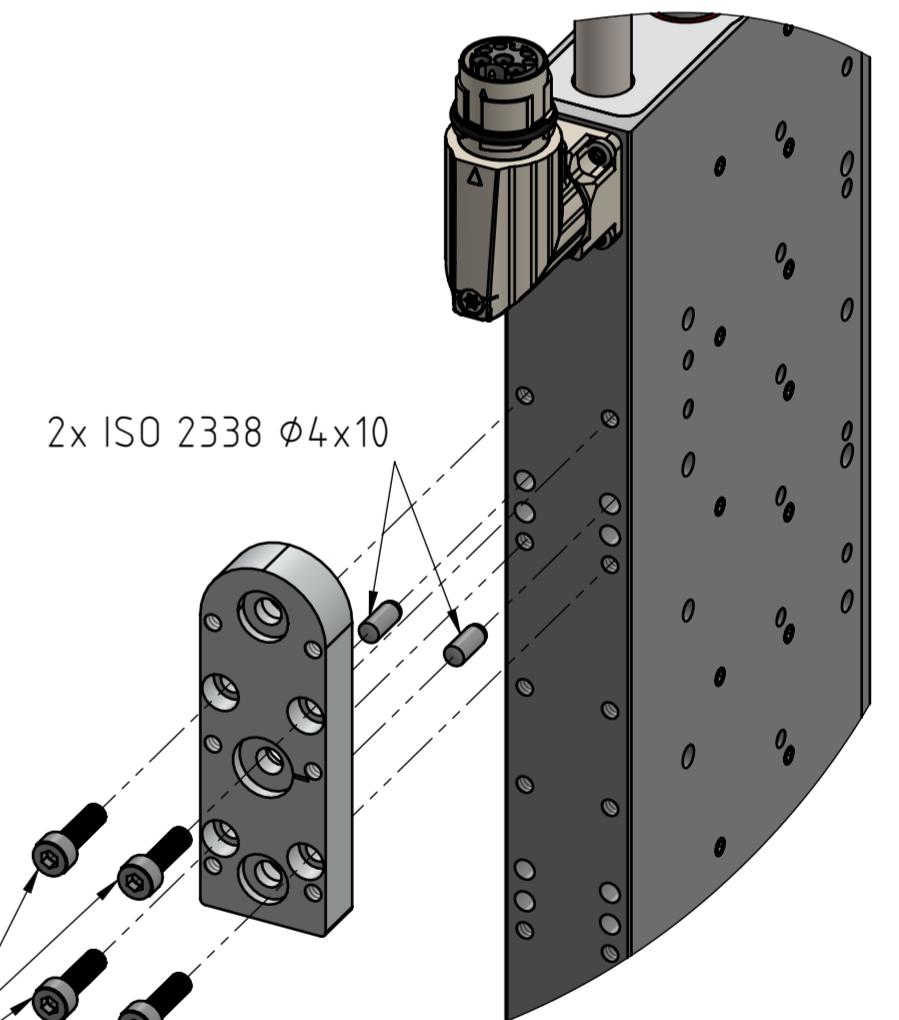

2x ISO 2338 $\phi 4 \times 10$

4x ISO 4762 M4x14

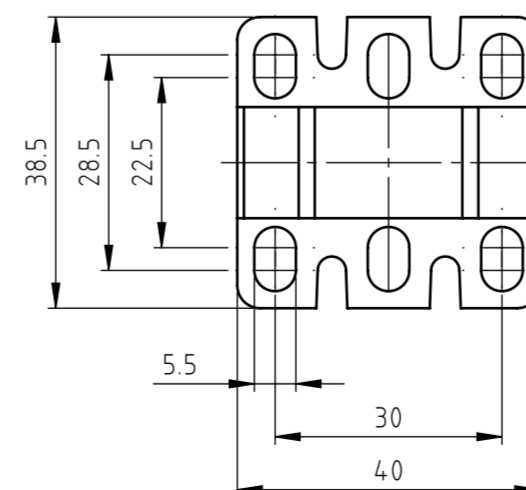

| Rev. | Change | Date | Author | Appr. |
|------|------------------|------------|--------|-------|
| A | Document created | 14.11.2024 | JB | FH |

| | | | |
|---|---|--|------------|
| General tolerance DIN ISO 2768 - mK | Created by J.-E. Beekhuis | Status 06.02.2025/jb | Material |
| LinMot® | File name 0380-0003_PP03_210-23x160F_80-23x160F-MS11_PS01_TC01 | <input type="checkbox"/> Safety Rel. <input type="checkbox"/> UL-Rel. | Weight (g) |
| NTI AG LinMot & MagSpring Bodenaeckerstrasse 2 CH-8957 Spreitenbach | Title, additional title PP03_210-23x160F_ 80-23x160F-MS11_PS01_TC01 | Document type Assembly drawing | |
| Template type: SW2020 Version: V1-1 SW_A2_hori_Sheet_format_V1-1 | Pick&Place / DM01-23 & DM03-23 Art.No.: 0300-0003 | Drawing number / Index 0380-0003A | |
| Scale 3:5 | Sheet 3 / 3 | | A2 |